

TECHNICAL DETAILS

YOUR "CUSTOM-MADE" SPECIALIST

The Baillargeon team can meet all your requirements:

- | Wood veneer
- | Plastic laminate
- | Type of opening
- | Moulding
- | Selection of mouldings
- | Louver
- | Milling for any application

We also offer many other options such as oversized, French, recessed panel, Dutch, sliding, swinging or folding doors. Contact us!

STANDARD LOUVER

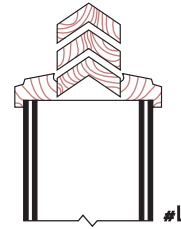

Manufacturer's choice of hardwood or matched to the face on request. Oak or birch in stock. For 1 3/8" (35 mm) or 1 3/4" (44 mm) door. Inverted V-shaped wood louver. This system allows aeration equivalent to 30% of the surface.

EDGES AND RAILS

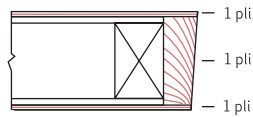

No. 1 "Edge" Type D
3-ply door. No visible reinforcement ply (dummy joint)



Standard Baillargeon edge on both sides. Clearance 1/8" over 2" (3 mm over 51 mm)
Standard lock and hinge side

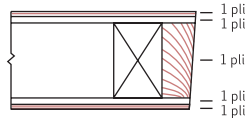

No. 2 "Edge" Type A (Standard)
5-ply door. 1 visible reinforcement ply



No. 5 "Edge" Type B
5 or 7 ply veneer edge (VE)

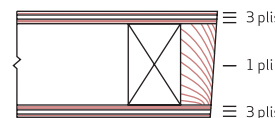

No. 3 "Edge" Type A (Optional)
7-ply door. 3 visible plies on each side of the core

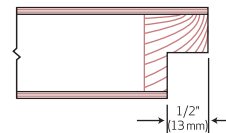

Notched top door rail or impost bottom
Upon request

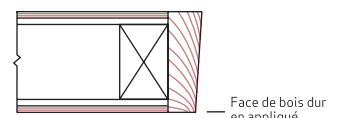

No. 4 "Edge" Type F
Hardwood face applied to the edge



Radius
For double-acting doors 1 5/32" (29.36 mm) standard curve.

Other models: available upon request or to specifications

LITE BEAD PROFILE

Manufacturer's choice of moulding milled from the same wood as the faces or matched to the face.

Standard models
Oak or birch in stock

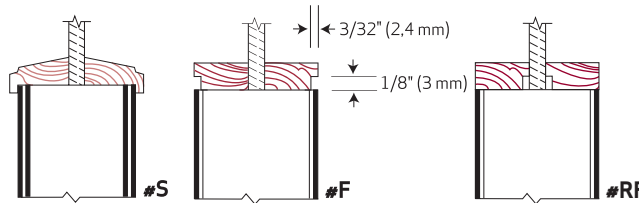

Thermos (Thermal)
3/4" (19 mm) thick for 1 3/4" (44 mm) or 2 1/4" (57 mm) door
Birch in stock

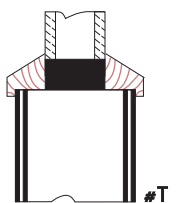

Other models: available upon request or to specifications

STANDARD DECORATIVE MOULDING PROFILES

Manufacturer's choice of hardwood or matched to the face upon request. Oak or birch in stock

Other models: available upon request or to specifications

AP1

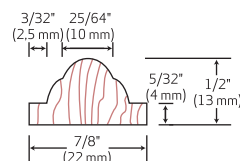

AP2

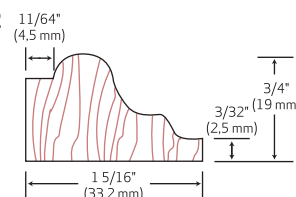

AP3

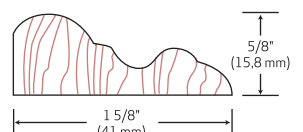

AP4

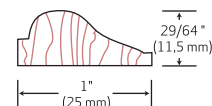

AP5

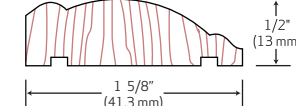

AP6

