

Madero

INSULATING CONCRETE FORM
SYSTEM

ICF

Madero

FiberComp
SMOOTH WHITE

FiberComp Fits.

Seamless integration
with ICF systems

Fits walls from
4" to 16" deep

Easy installation and
superior durability

**Maintenance
Free.**



CALGARY

T 1.866.664.7664
F 1.403.204.7665

SASKATOON

T 1.800.667.6977
F 1.306.934.7644

WINNIPEG

T 1.855.706.0200
F 1.204.594.0200

Why architects choose

Madero FiberComp Door Systems:

Madero
INSULATING CONCRETE FORM
SYSTEM **ICF**



► Strength

Doors

Steel-reinforced hardwood construction, polymer stiles and rails and impact-resistant fiberglass GRP (glass reinforced polyester) skins provide incomparable maintenance-free durability and strength.

Composite jambs

Resilient fiber-resin compound material with high strength-to-weight ratio has twice the screw-holding power of wood.

The FiberComp door system passes the highest level of forced entry testing.

► Eliminates need for on-site jamb extensions

Custom Jamb Depths

Pick a size, we'll make it!.... Custom depths to suit all wall structures, from 4" deep to 16", and all sizes in between.

FiberComp Rough Opening Sizes For 6/8 height

Inswing	2/6 - 32 3/4" x 82 1/2"	6/10, 7/0, and 8/0 heights also available in select door designs.
	2/8 - 34 3/4" x 82 1/2"	
	2/10 - 36 3/4" x 82 1/2"	
	3/0 - 38 3/4" x 82 1/2"	

► Energy efficiency

A 100% CFC free polyurethane-filled door with nine times the thermal efficiency of wood; a custom-fitted jamb with a moisture tight seal for prevention of heat-loss.

► Fire resistance

FiberComp systems are available with a 20 minute label upon request.

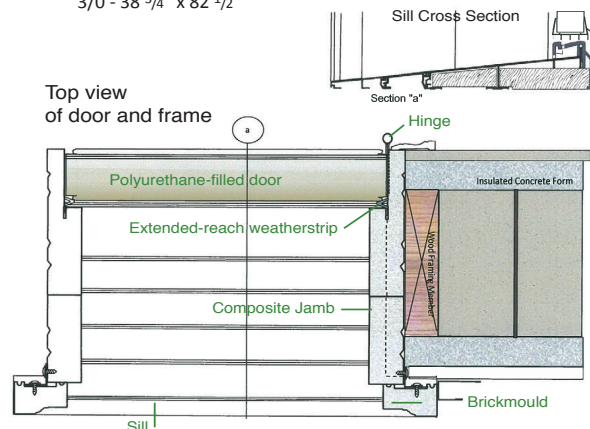

Door

A white, smooth-surfaced fiberglass door, with a solid pigment skin that can be primed and painted.

- Compression moulded high-definition panels.
- Resists scratches, dents, warping and rotting.
- Withstands Canadian weather extremes.
- Developed and manufactured by Nan Ya Plastics, distributed by Madero Doors & Hardware.
- 25 year limited warranty.



Jamb and Sill

Using composite jambs, we produce factory-built maintenance-free pre-hung doors for wall depths from 4" - 16". Available as single doors, door sidelite units, and garden doors.

Door model shown: SG38
See www.madero.ca for other panel designs.

SASKATOON

T 1.800.667.6977 F 1.306.934.7644

CALGARY

T 1.866.664.7664 F 1.403.204.7665

WINNIPEG

T 1.855.706.0200 F 1.204.594.0201

www.madero.ca