

# C-106-4 HANGER FOR C-104 OR C-108 TRACK

INSTRUCTION SHEET



## PARTS LIST

C-106-4 HANGER  
ASSEMBLED  
(2 PER DOOR)

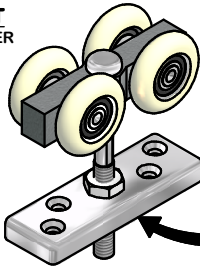

#10 X 1-3/4" FLATHEAD  
SCREWS (4 PER HANGER)



EXTRUDED  
ALUMINUM TRACK

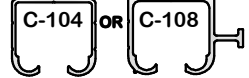

SQUARE NUT  
INCLUDED IN  
ASSEMBLY

## SPECIFICATIONS:

-LOAD CAPACITY:  
175 LBS PER DOOR.

-DESIGNED FOR TOP  
MOUNTING.

-HEAVY-DUTY  
PRECISION BALL  
BEARING WHEELS  
WITH NYLON TIRE.

-LOCK NUTS HOLD  
VERTICAL  
ADJUSTMENT.

-FOR BY-PASSING,  
BI-PARTING, POCKET,  
AND SURFACE  
MOUNT/BARN STYLE  
APPLICATIONS.

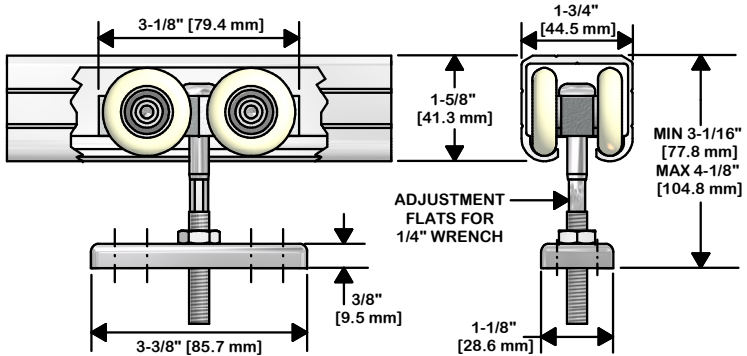

## STEP 1

DETERMINE DOOR SIZE/HEADER HEIGHT BASED ON DIMENSIONS SHOWN IN DETAIL VIEWS AND CLEARANCE REQUIRED BELOW DOOR.

## STEP 2

A) LOCATE CENTER CLEARANCE HOLE FOR HANGER STUD 4-1/2" FROM EACH EDGE OF DOOR. DRILL WITH 3/8" Ø BIT AT LEAST 1-1/2" DEEP. IF USING KNC CAS-2 DOOR STOP, LOCATE CLEARANCE HOLE 5-1/2" FROM EDGE OF DOOR.

B) CENTER TOP/SIDE PLATE OVER HOLE, MARK SCREW HOLE LOCATIONS AND PRE-DRILL WITH 1/8" Ø BIT AT LEAST 1-1/2" DEEP.

## STEP 3

PREPARE DOOR FOR INSTALLATION OF OPTIONAL PRODUCTS IF PURCHASED SUCH AS GUIDE CHANNELS, CUP PULLS, DOOR LOCKS, ETC. INDIVIDUAL INSTRUCTIONS ARE PROVIDED WITH THE RESPECTIVE PRODUCT.

## STEP 4

MOUNT HANGER ASSEMBLY ON DOOR AND SECURE TOP PLATE WITH #10 X 1-3/4" FLATHEAD SCREWS(4).

## STEP 5

PLACE DOOR AND HANGERS INTO C-104 OR C-108 TRACK AND SECURE TO HEADER.

## STEP 6

ADJUST DOOR HEIGHT AND PLUMB USING 1/4" WRENCH ON BOLT. LOCK ADJUSTMENT BY TIGHTENING HEX NUT AGAINST TOP PLATE WITH 1/2" WRENCH.

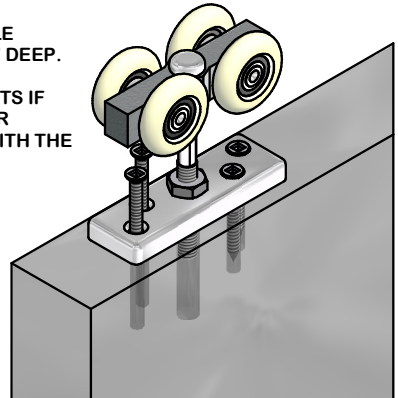
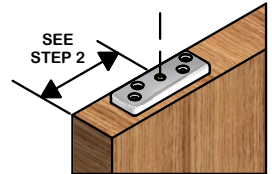

**K.N. CROWDER MFG. INC.**  
1220 BURLOAK DRIVE  
BURLINGTON, ONTARIO, CANADA, L7L 6B3  
TELEPHONE: 905-315-9788 - FAX: 905-315-8090  
TOLL FREE FAX: 1-800-567-0123

**K.N. CROWDER INC.**  
210 EIGHTH STREET SOUTH  
LEWISTON, NEW YORK, U.S.A. 14092  
TELEPHONE: 1-716-754-8247  
TOLL FREE FAX: 1-800-567-0123

WEBSITE: [www.kncrowder.com](http://www.kncrowder.com) --- E-MAIL: [customerservice@kncrowder.com](mailto:customerservice@kncrowder.com)