

LoPro-TMSTC

Sound Rated Vision Lite
and Glazing Assembly



Anemostat[®]
www.anemostat.com

1220 Watson Center Road • Carson, CA 90745
Tel: (310) 835-7500 • Fax: (310) 835-0448
E-mail: door@anemostat.com

LoPro-STC Assembly

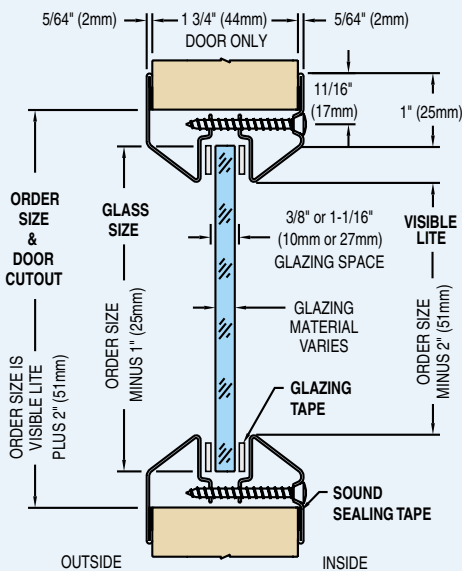
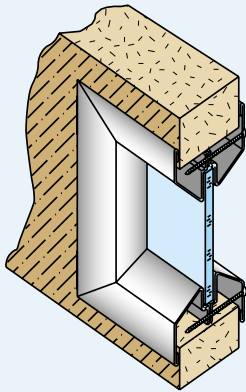

■ For use in Sound Rated Wood or Metal Doors

■ **TESTED in ACCORDANCE WITH:**
ASTM E90-09 and ASTM E2235-04.
STC measurements determined in accordance with ASTM E413-04.

Testing conducted at:

Western Electro - Acoustic Laboratory
Santa Clarita, CA.

■ **TESTED SIZE:** 24" x 36" (610mm x 914mm)

■ **FIRE RATINGS:** See Glazing Product Technical Data Sheets at www.anemostat.com



1220 Watson Center Road • Carson, CA 90745
Tel: (310) 835-7500 • Fax: (310) 835-0448
E-mail: door@anemostat.com

LoPro AA1

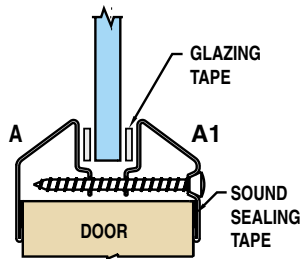

Fire/Safety Rated Glazing

STC - 38

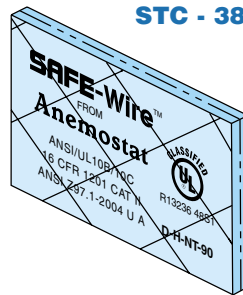

1/4" SAFE-Wire

- Fire Rated up to 90 min.
- Category II Safety Rated

LoPro BB1

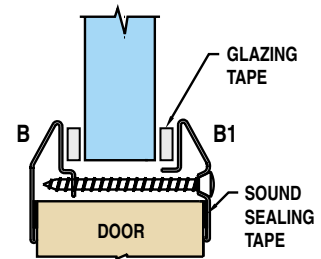

Fire/Safety Rated Glazing

STC - 42

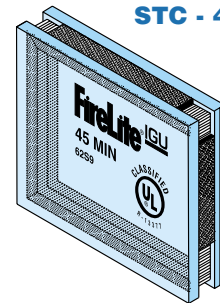

1" FireLite Plus IGU

- Fire Rated up to 180 min.
- Category II Safety Rated

STC - 35

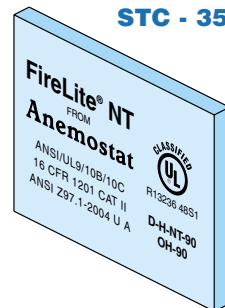

3/16" FireLite NT

- Fire Rated up to 180 min.
- Category II Safety Rated

STC - 41



7/8" Pyrostop 60-101 23mm

- Fire Rated up to 60 min.
- Category II Safety Rated

Safety Rated

STC - 38

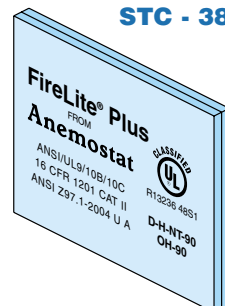

5/16" FireLite Plus

- Fire Rated up to 180 min.
- Category II Safety Rated

STC - 42

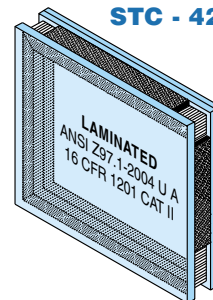

1" Laminated IGU

- Category II Rated
- 5/16" Laminated and 3/16" Tempered

STC - 35

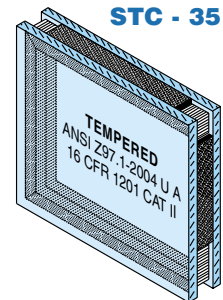

1" Tempered IGU

- Category II Rated
- 1/4" Tempered and 1/4" Tempered