

# EVOLUTION SERIES

## VENEER JAMB – RATED (90 MINUTES)

# J1490A

### DOUBLE RABBIT JAMB (3/4")

- ❶ 1/8" (3 mm) hardwood edges
- ❷ 3/4" (19 mm) 90 min fire core
- ❸ 1/32" wood veneer faces
- ❹ 5/8" (15.8 mm) hardwood door stop
- ❺ Doors
- ❻ Corner rabbet type

#### SPECIFICATIONS

**MINIMUM WALL THICKNESS:** 4 5/8" (117 mm)

**ASSEMBLY:** Please refer to installation instructions

#### MAXIMUM OPENING

| Single: 48" (1,219 mm) x 96" (2,438 mm)

| Double: 48" (1,219 mm) x 96" (2,438 mm)

**CASING:** 5/8" (15 mm) x 2 1/2" (64 mm)

**SHIPPING:** Unassembled (Knock Down)

**WRAPPING:** Each frame will be shipped in a cardboard box, with 1/32" (1 mm) foam and bundle wrapped.

**Installation instructions and peel-and-stick door bumpers are included (mandatory)**

**WARRANTY: 3 years**

#### OPTIONS

| Other configurations upon request

| \* M.R. 5.1/5.2 according to project localisation. Contact us.

| \*\* To get M.R. 7.0, specify FSC core and faces.

| \*\*\* To get IEQ 4.4, specify NAUF jamb.

| Mounting brackets available

| Pre-machining

| Pre-finishing

| ○ Subject to evaluation. Contact us.

#### NOTE

| Mounting brackets are suggested for proper installation.

| Installation requires a wood casing of 1/4" x 1 1/2" minimum.

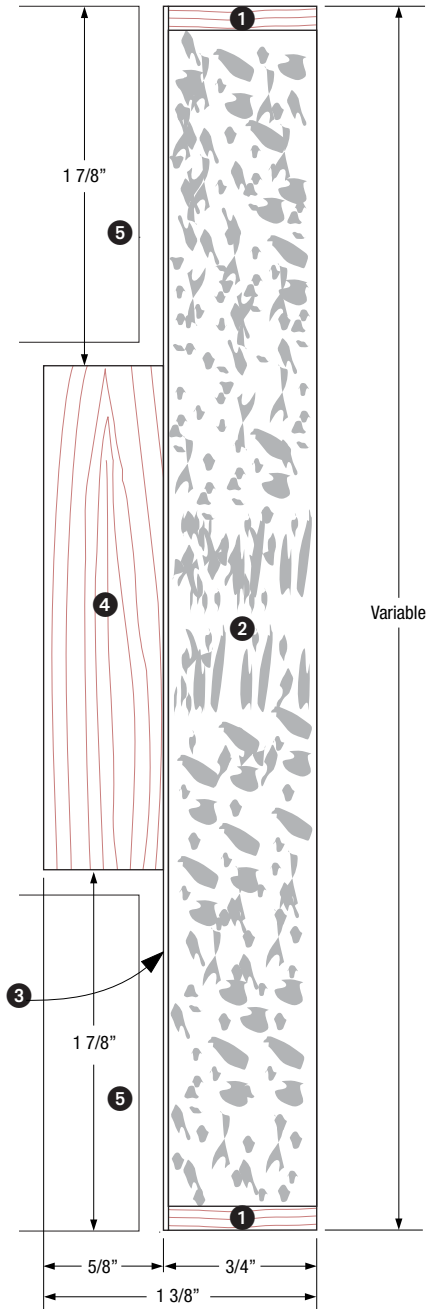

#### JAMB ASSEMBLY

Head and jamb

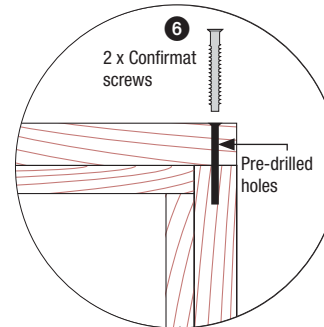

LEED Eligible Credits	MR					IEQ		ID 1	PR 2
	3	4	5	6	7	3.2	4.4	mode 2	
	✓	*		**		○	***	○	○



FSC\* certified products available on request.