

EVOLUTION SERIES

VENEER JAMB – RATED (60 MINUTES)

J1460A

DOUBLE RABBIT JAMB (3/4")

- ① 1/8" (3 mm) hardwood edges
- ② 3/4" (19 mm) 60 min fire core
- ③ 1/32" wood veneer faces
- ④ 5/8" (15.8 mm) hardwood door stop
- ⑤ Doors
- ⑥ Corner rabbet type

SPECIFICATIONS

MINIMUM WALL THICKNESS: 4 5/8" (117 mm)

ASSEMBLY: Please refer to installation instructions

MAXIMUM OPENING

| Single: 48" (1,219 mm) x 96" (2,438 mm)

| Double: 72" (1,829 mm) x 96" (2,438 mm)

CASING: 5/8" (15 mm) x 2 1/2" (64 mm)

SHIPPING: Unassembled (Knock Down)

WRAPPING: Each frame will be shipped in a cardboard box, with 1/32" (1 mm) foam and bundle wrapped.

Installation instructions and peel-and-stick door bumpers are included (mandatory)

WARRANTY: 3 years

OPTIONS

| Other configurations upon request

| * M.R. 5.1/5.2 according to project localisation. Contact us.

| ** To get M.R. 7.0, specify FSC core and faces.

| *** To get IEQ 4.4, specify NAUF jamb.

| Mounting brackets available

| Pre-machining

| Pre-finishing

| ○ Subject to evaluation. Contact us.

NOTE

| Mounting brackets are suggested for proper installation.

| Installation requires a wood casing of 1/4" x 1 1/2" minimum.

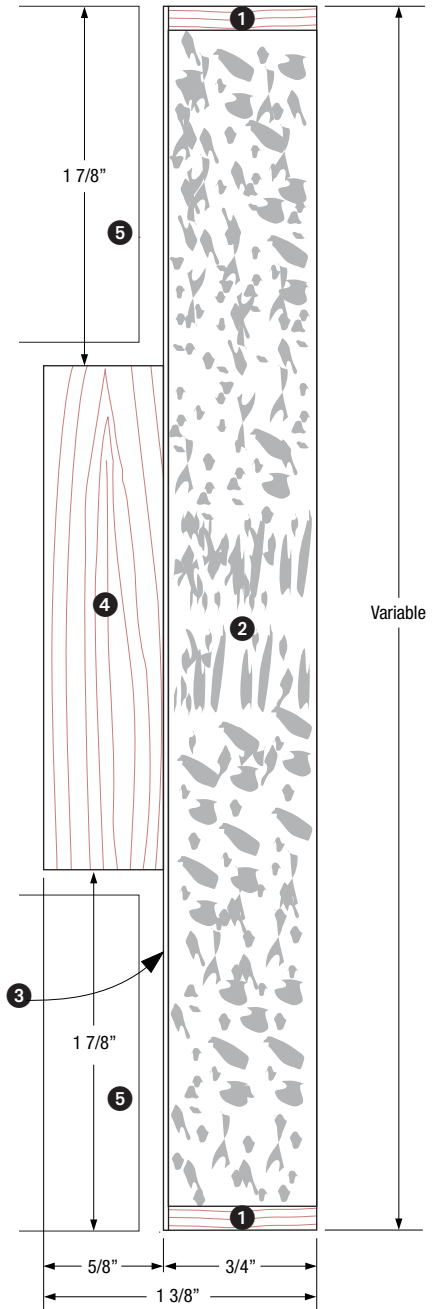

JAMB ASSEMBLY

Head and jamb

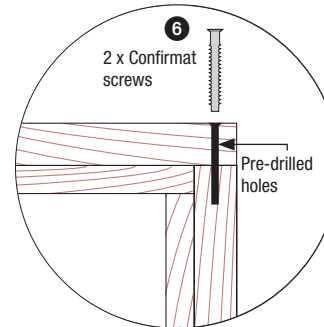

LEED Eligible Credits	MR					IEQ		ID 1	PR 2
	3	4	5	6	7	3.2	4.4	mode 2	
	✓	*		**		○	***	○	○



FSC® certified products available on request.