

9500-ME (5 PLY)

HOLLOW CORE, ULTRA HEAVY-DUTY, ANTI-WARPING CONSTRUCTION FOR INTENSIVE USE

- ① **STILES:** 1/8" (3 mm) thick veneer, longitudinally laminated by hot pressing with type 1 structural glue, as per ASTM-D5456-93 (LVL FSC), including a 7/8" (22 mm) piece of hardwood, matched with faces, for a total width of 4 3/16" (107 mm).
- ② **TOP AND BOTTOM RAILS:** 1/8" (3 mm) thick veneer, longitudinally laminated by hot pressing with type 1 structural glue, as per ASTM-D5456-93 (LVL FSC) or laminated strand lumber (LSL), for a total width of 3 5/16" (85 mm).
- ③ **CORE:** 4 3/4" (120 mm) honeycomb. (100% recycled).
- ④ **FACES:** Wood veneer (choice of face veneers: 2 ply plywood), hardboard panel or plastic laminate glued to composite crossband. Available NAUF/FSC.

LOCK BLOCK: Integrated.

GLUE: Type 1 PVA Cross-link (NAUF).

INTERIOR USE

WARRANTY: LIFETIME

OPTIONS

| Wood veneer glued to plywood veneer (3 ply plywood) (7 ply door).

| ** To get M.R. 7.0, specify FSC faces.

| *** To get I.E.Q. 4.4, specify NAUF or NAUF/FSC faces.

NOTE

| Dimensions are nominal before trimming.

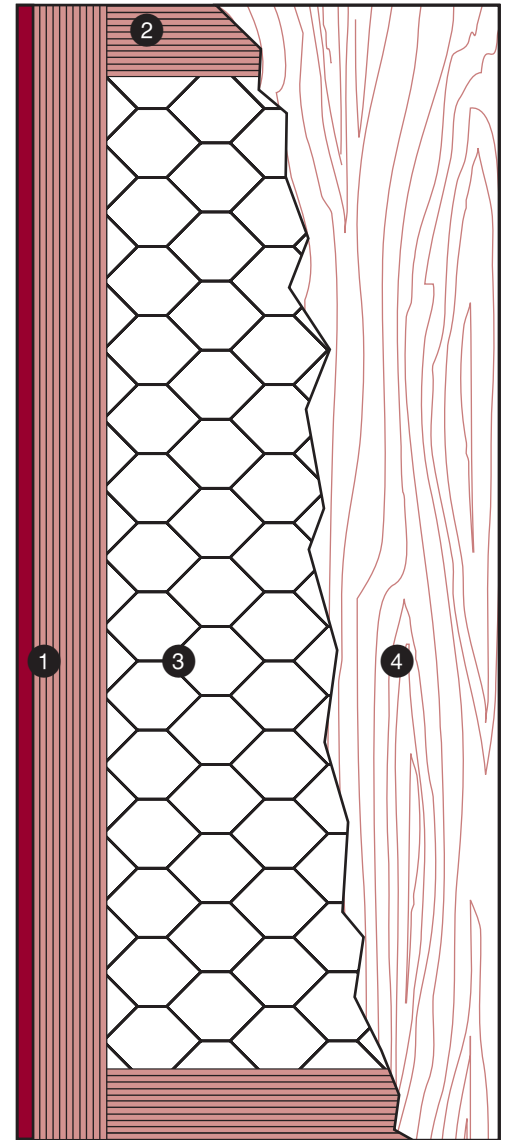

Standards meet or exceed:
A.W.S. section 9, October 1, 2009;
W.D.M.A. 1.S.1A-04
and CSA 0132.2.90

LEED ELIGIBLE CREDITS	M.R.						I.E.Q.
	4.1	4.2	5.1	5.2	6.0	7.0	4.4 (NAUF)
✓	✓		✓			**	***

① STILES ME

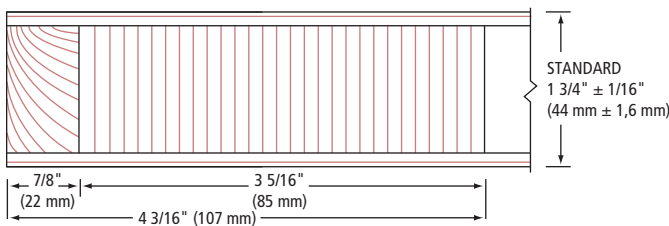

② RAILS

