

# 20 & 30 SERIES EXIT DEVICE INSTRUCTIONS FOR APPLYING THE SARGENT THUMBPIECE OUTSIDE TRIM

**SARGENT**

**ASSA ABLOY**

ASSA ABLOY, the global leader in door opening solutions

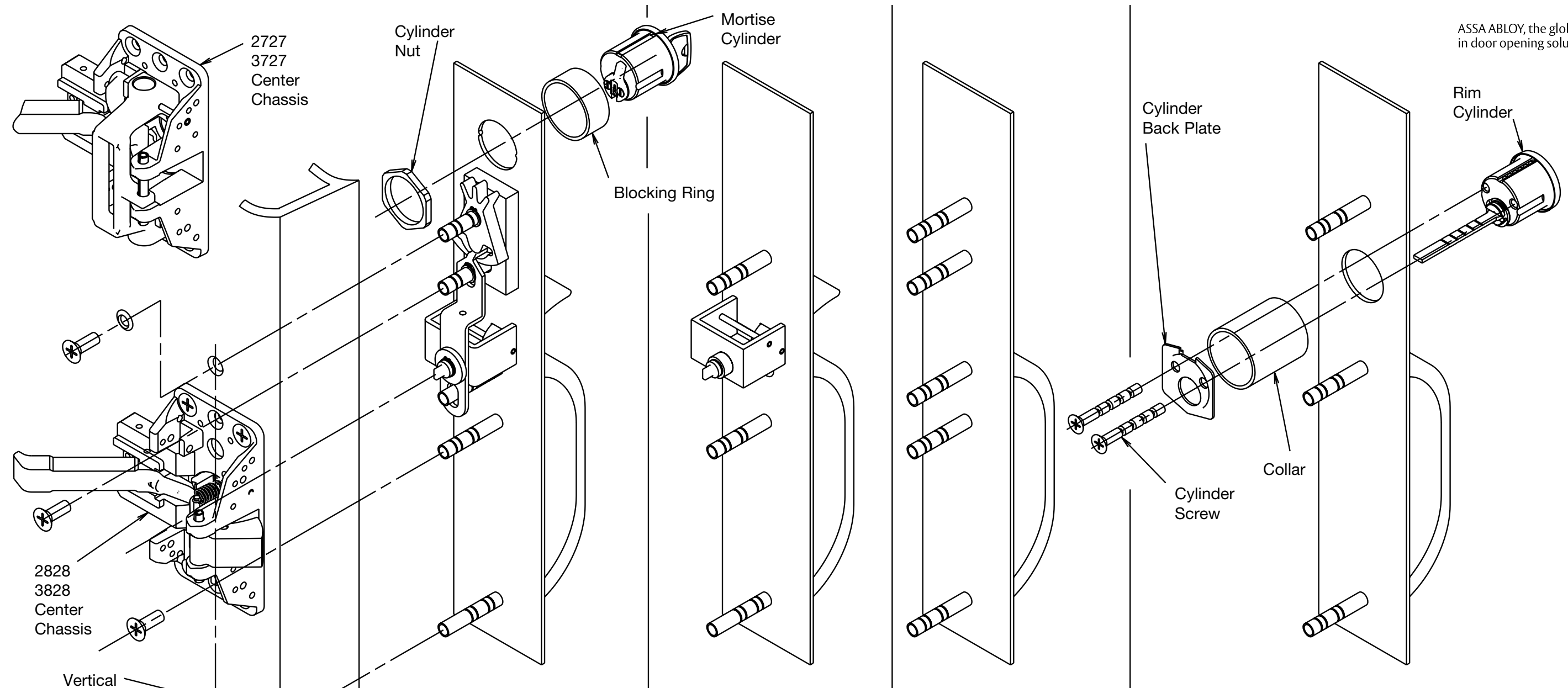

- NOTE:**
- 1] FOR USE WITH SARGENT 20 & 30 SERIES EXIT DEVICES.
  - 2] TRIM IS NON-HANDED.
  - 3] FOR USE WITH 1 3/4" THICK DOORS ONLY.
  - 4] FOR USE WITH SARGENT, ASSA V10, AND BEST CYLINDERS ONLY.

866-TP LOCKABLE THUMBPIECE TRIM	828-TP ALWAYS OPERABLE THUMBPIECE TRIM	810-TP DUMMY THUMBPIECE TRIM	814-TP CYLINDER THUMBPIECE TRIM
<ol style="list-style-type: none"> <li>1] ATTACH THE COLLAR AND MORTISE CYLINDER TO THE TRIM PLATE WITH THE MORTISE NUT.</li> <li>2] ATTACH TRIM TO DOOR THRUBOLTING (2) SCREWS TO THE CHASSIS &amp; THE (2) CUP WASHERS AND SCREWS AT THE TOP &amp; BOTTOM TO THE DOOR.</li> </ol>	<ol style="list-style-type: none"> <li>1] ATTACH TRIM TO DOOR THRUBOLTING THE (2) SCREWS TO THE CHASSIS &amp; (1) CUP WASHER AND SCREW AT THE BOTTOM TO THE DOOR.</li> </ol>	<ol style="list-style-type: none"> <li>1] ATTACH TRIM TO DOOR THRUBOLTING THE (2) SCREWS TO THE CHASSIS &amp; (1) CUP WASHER AND SCREW AT THE BOTTOM TO THE DOOR.</li> </ol>	<ol style="list-style-type: none"> <li>1] ATTACH COLLAR, BACKPLATE AND RIM CYLINDER TO THE TRIM PLATE WITH THE (2) CYLINDER SCREWS.</li> <li>2] ATTACH TRIM TO DOOR THRUBOLTING THE (2) SCREWS TO THE CHASSIS &amp; THE (1) CUP WASHER AND SCREW AT THE BOTTOM TO THE DOOR.</li> </ol>