



TECHNICAL DATA
FROM
Anemostat[®]
DOOR PRODUCTS
A MESTEK COMPANY

1220 E WATSON CENTER RD
CARSON, CA 90745-4206
(310) 835-7500 • FAX (310) 835-0448

e-mail: door@anemostat.com • website: www.anemostat.com

INDEX
FOR
**METAL
VISION
FRAMES**

DETAIL DRAWING

MODEL	DESCRIPTION	DATE PRINTED	PAGE
STANDARD			
LoPro™	Lo-Profile Self Attaching	March 2012	1
LoPro™-IS	Lo-Profile Special Glass or Door Thickness	July 2012	2
LoPro™-BB1-MB	Lo-Profile Internal Mini-Blind	July 2014	3
LoPro™-STC	Lo-Profile Self Attaching / STC Rated	May 2014	4
WoodPro™	Lo-Profile Self Attaching with Wood Veneer	May 2014	5
StormPro-HR™	Lo-Profile Self Attaching / Hurricane Rated	May 2014	6
StormPro-HR™-G	Lo-Profile Self Attaching / Hurricane Rated	May 2014	7
SPECIALTY			
LoPro™-G	Lo-Profile French Door Grilles	May 2014	8
FM-G	Sidelite Mullions	May 2014	9
Grille / Mullion	Design Confirmation Sheet	May 2014	10
FGS-75-G	French Door Grilles	May 2014	11
BFL-123-G	French Door Grilles	May 2014	12
FGS-75	Thru – Bolt Installation	May 2014	13
FGS-38	For 1 3/8" Doors	May 2014	14
FGS-IS	Special Glass or Door Thickness	May 2014	15
FGS-DBL	Double Glazing	May 2014	16
BFL-123	Self Attaching	May 2014	17
BFL-75	Thru – Bolt Installation	May 2014	18
BFL-75-PO	Post Office Observation	May 2014	19
X-RAY			
LoPro	Lo-Profile Lead Lined	May 2014	20
FGS-MS5-FR	Lead Lined and Fire Rated	May 2014	21
CUSTOM			
Lo-FP-12 / LoFP-12-IS	12" Round / Lo-Profile	March 2012	22
Lo-FP-18 / LoFP-18-IS	18" Round / Lo-Profile	March 2012	23
Lo-FP-24	24" Round / Lo-Profile	May 2014	24
FP-12	12" Round	May 2014	25
FP-18	18" Round	May 2014	26
FP-24	24" Round	May 2014	27
LoPro™-CS	Non-Curved Custom Shapes / Lo-Profile	May 2014	28
LoPro™-CS	Curved Custom Shapes / Lo-Profile	May 2014	29
LoPro™-CS-HC	Half Circle Custom Shapes / Lo-Profile	May 2014	30
LoPro™-CS-QR	Quarter Radius Custom Shapes / Lo-Profile	May 2014	31
FGS-75-CS	Non-Curved Custom Shapes	May 2014	32
Fasteners for Vision Frames	Screws	May 2014	33
HM-CLIP	Hollow Metal Door Clip	May 2014	34



TECHNICAL DATA

FROM

Anemostat[®]

DOOR PRODUCTS

A MESTEK COMPANY

1220 E WATSON CENTER RD

CARSON, CA 90745-4206

(310) 835-7500 • FAX (310) 835-0448

e-mail: door@anemostat.com • website: www.anemostat.com

LoPro[™]

LO-PROFILE METAL VISION FRAME



UNDERWRITERS'
LABORATORIES

FIRE
RATINGS



Intertek
WARNOCK
HERSEY

EN-1634

European Standard

B.S.-476.22

British Standard

DETAIL DRAWING

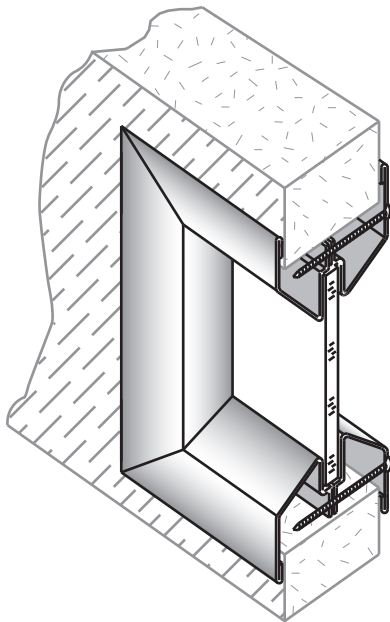

PLEASE NOTE: On visible lite sizes larger than 1296 sq. in. (0.836 m²) on 20/45 min. and 100 sq. in. (0.065 m²) on 60/90/180 min., please consult with your Door / Frame Manufacturer's procedures, for their maximum glass size tested.



Anemostat manufacturing dimensions ±1/32 (1mm)
Actual dimensions are nominal and may vary
based on component manufacturers tolerances.

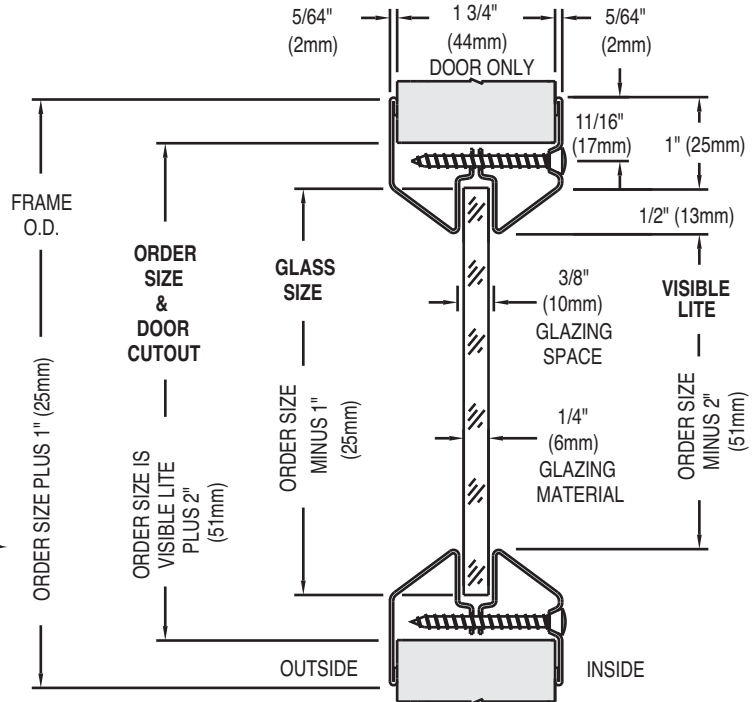

STANDARD PRODUCT FEATURES

- **MATERIAL:** 20 GA. (1mm) Cold Rolled Steel.
- **FINISH:** Grey Primer, Beige or Bronze Baked Enamel.
- **INSTALLATION:** Our most popular product is easy to install and provides a low profile, flush to the door look. Uses 1 3/4" (44mm) sheet metal screws that pass through the door cutout, and fastens to the opposite side of the vision frame, thus eliminating the need to drill the door for thru bolts and saving installation time and labor. It also leaves the corridor side of the frame free of fasteners for added security and a cleaner, more aesthetic appearance.
- **DOOR THICKNESS:** For 1 3/4" (44mm) Wood or Metal Doors.
- **GLAZING:** Should be 1/4" (6mm), 3/16" (5mm) or 5/16" (8mm) fire and/or safety rated with U.L. and/or W.H.I. classification markings. Nominal glazing space of 3/8" (10mm) allows for glazing tape to be used on both sides of the glass.
- **AESTHETICS:** Tight mitered corners, beveled glass stop and low profile, provide a clean tapered look.
- **IMPORTANT:** Interpretation of building and fire codes may vary. Consult with the local authority having jurisdiction in your area, to determine appropriate standards.
- **NOTE:** For Exterior use, High Humidity or Salt Air application, product must be Galvanized or Stainless Steel.

OPTIONAL FEATURES

- **MATERIAL:** #304 or #316 Stainless Steel, #4 Finish(Satin), Galvanized(Coil, Hot Dipped, or Zinc Plated) Mill Finish Aluminum-(Not Fire Rated).
- **FINISH:** Custom Baked Enamel Colors (as per sample chip supplied). Plated Finishes to match the lock, hinges and closer.
- **FASTENERS:** Special Security Screw Fasteners, See Page 36, this section.
- **SPECIALS:** Fractional Sizes, Lead Lined for X-ray applications. For Special Glass or Door thickness (see FGS-IS or LoPro[™]-IS). For mullions see (LoPro[™]-G, FGS-75-G or BFL-123-G.)
- **HM CLIP:** Replaces the need for reinforcing channel see page 37 this section.

FIRE RATINGS (w/ U.L. & W.H.I. classification markings) Positive Pressure

- **20 MINUTE:*** Approved listing at 3204 sq.in. (2.067 m²) visible lite max. width 36" (914mm), max. height 89" (2261mm).
- **45/60 MINUTE:*** Approved listing at 2772 sq.in. (1.788 m²) visible lite max. width 36" (914mm), max. height 77" (1956mm).
- **90 MINUTE:*** Approved listing at 1296 sq.in. (0.836 m²) visible lite max. width 36" (914mm), max. height 54" (1372mm).
- **3 Hour:*** Approved listing at 100 sq.in. (0.065 m²) visible lite max. width 12" (305mm), max. height 33" (838mm)

* Must be used with FIRELITE Plus or NT and Fire listed glazing tape or another manufacturer's equivalent product. Glazing combination must be used in appropriately tested door assembly.

BS 476.22 Timber Doors - 30 min. and 1 hour.
British Standard Steel Doors - 2 hours (4 hours actual).

EN-1634 30/60 min. integrity and insulation - Indicative Testing
European Std.

Job Name & Location	Submitted by



TECHNICAL DATA

FROM

Anemostat®

DOOR PRODUCTS

A MESTEK COMPANY

1220 E WATSON CENTER RD
CARSON, CA 90745-4206

(310) 835-7500 • FAX (310) 835-0448

e-mail: door@anemostat.com • website: www.anemostat.com

LoPro™-IS Style

LO-PROFILE METAL VISION FRAME
FOR SPECIAL GLASS
OR DOOR THICKNESS



UNDERWRITERS'
LABORATORIES

EN-1634

European Standard

FIRE
RATINGS



WARNOCK
HERSEY

B.S.-476.22

British Standard

DETAIL DRAWING

Anemostat manufacturing dimensions ±1/32 (1mm) Actual dimensions are nominal and may vary based on component manufacturers tolerances.

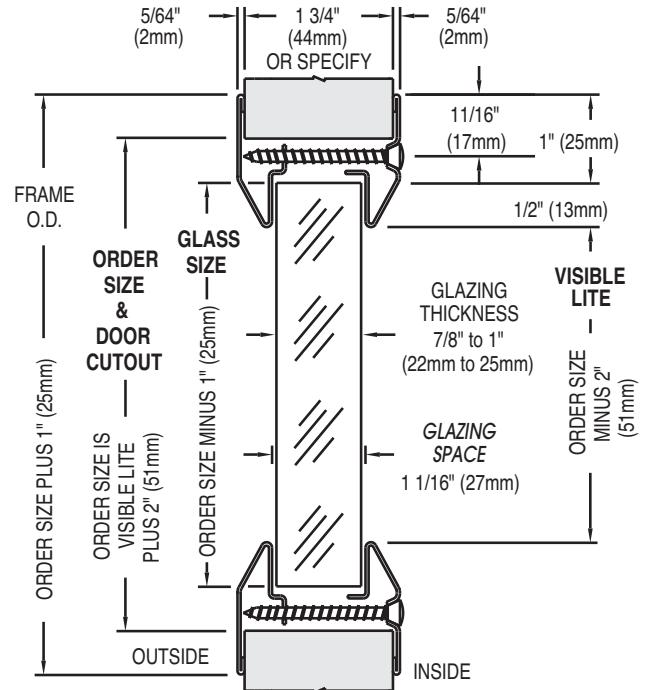
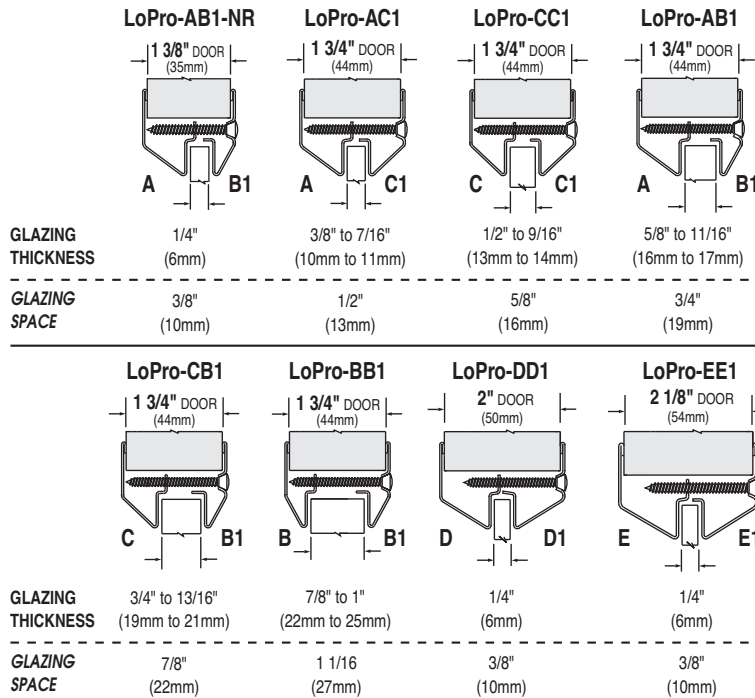

STANDARD PRODUCT FEATURES

- MATERIAL:** 20 GA. (1mm) Cold Rolled Steel.
- FINISH:** Gray Primer, Beige or Bronze Baked Enamel.
- INSTALLATION:** Uses 1 3/4" (44mm) sheet metal screws that pass through the door cutout, and fastens to the opposite side of the vision frame, saving installation time and labor. It also leaves the corridor side free of fasteners for added security and a cleaner, more aesthetic appearance.
- DOOR THICKNESS:** 1 3/4" (44mm) is standard. Door thickness can vary based on Glazing Material thickness used, please consult factory. 2" (50mm) or 2 1/8" (54mm) are available with 1/4" (6mm) glazing material.
- AESTHETICS:** Tight mitered corners, beveled glass stop and a low profile to provide a clean, tapered look.
- GLAZING:** Glazing Space will vary based on Glazing Material and will determine thickness of Glazing Tape used. Glazing Material should be fire and safety rated for use as a door lite with U.L. and/or W.H.I. markings when used in a fire rated assembly.
- IMPORTANT:** Interpretation of building and fire codes may vary. Consult with the local authority having jurisdiction in your area, to determine appropriate standards.
- NOTE:** For Exterior use, High Humidity or Salt Air application, product must be Galvanized or Stainless Steel.
- ATTENTION:** On visible lite sizes larger than 1296 sq. in. (0.836 m²) on 20/45 min. and 100 sq. in. (0.065 m²) on 60/90/180 min., please consult with your Door / Frame Manufacturer's procedures, for their maximum glass size tested.

OPTIONAL FEATURES

- MATERIAL:** #304 or #316 Stainless Steel, #4 Finish(Satin), Galvanized (Coil, Hot Dipped, or Zinc Plated) Mill Finish Aluminum (Not Fire Rated).
- FINISH:** Custom Baked Enamel Colors(as per sample chip supplied). Plated finishes to match the lock, hinges and closer.
- FASTENERS:** Special Security Screw Fasteners. See page 36, this section.
- SPECIALS:** Fractional sizes. For mullions see LoPro™-IS-G or FGS-IS-G
- HM-CLIPS:** Replaces the need for reinforcing channels in the door cutout, see pg. 37

FIRE RATINGS (w/ U.L. & W.H.I. classification markings) Positive Pressure

- 20/45/60/90 MINUTE:*** Approved listing at 1080 sq. in. (0.697 m²) visible lite. max. width 36" (914mm), max. height 36" (914mm).
*Must be used with 7/8" (23mm) or 1-1/16" (27mm) Pyrostop and fire listed glazing tape, and be used in an appropriately tested door assembly.
 - 20 MINUTE:**** Approved listing at 3204 sq. in. (2.067 m²) visible lite. max. w 36" (914mm), max. h 89" (2261mm).
 - 45/60 MINUTE:**** Approved listing at 2772 sq. in. (1.788 m²) visible lite. max. w 36" (914mm), max. h 77" (1956mm).
 - 90 MINUTE:**** Approved listing at 1296 sq. in. (0.836 m²) visible lite. max. w 36" (914mm), max. h 54" (1372mm).
 - 3 HOUR:**** Approved listing at 100 sq. in. (0.065 m²) visible lite. max. w 12" (305mm), max. h 33" (838mm).
- **Must be used with FIRELITE IGU 1" (25mm) Cat II or FIRELITE Plus and Fire listed glazing tape or another manufacturer's equivalent product. Glazing combination must be used in appropriately tested door assembly.

BS 476.22 Timber Doors - 30 min. and 1 hour. Steel Doors - 2 hours (4 hours actual).
British Standard

EN-1634 30/60 min. integrity and insulation - Indicative Testing
European Std.

Job Name & Location	Submitted by



TECHNICAL DATA

FROM

Anemostat[®]

DOOR PRODUCTS

A MESTEK COMPANY

1220 E WATSON CENTER RD
 CARSON, CA 90745-4206
 (310) 835-7500 • FAX (310) 835-0448

e-mail: door@anemostat.com • website: www.anemostat.com

LoPro™-BB1-MB

LO-PROFILE
 METAL VISION FRAME
 WITH
 INTERNAL MINI-BLIND
 GLASS UNIT

NOT FIRE RATED

CATEGORY II IMPACT/SAFETY RATED

MINI-BLIND UNIT
 PATENT # 5,699,845

DETAIL DRAWING

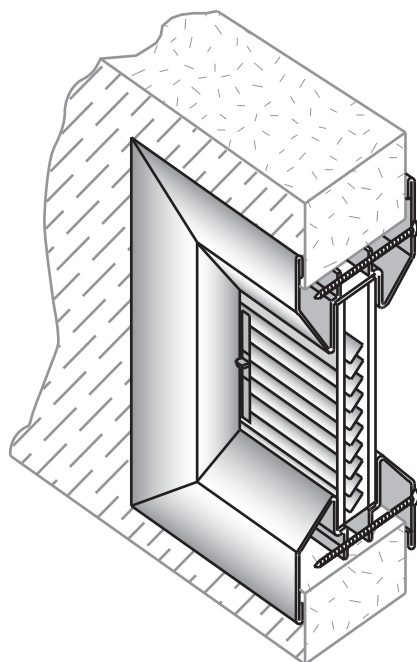

(Only Available in LoPro™-BB1 with
 1" insulated glass/mini blind unit.)

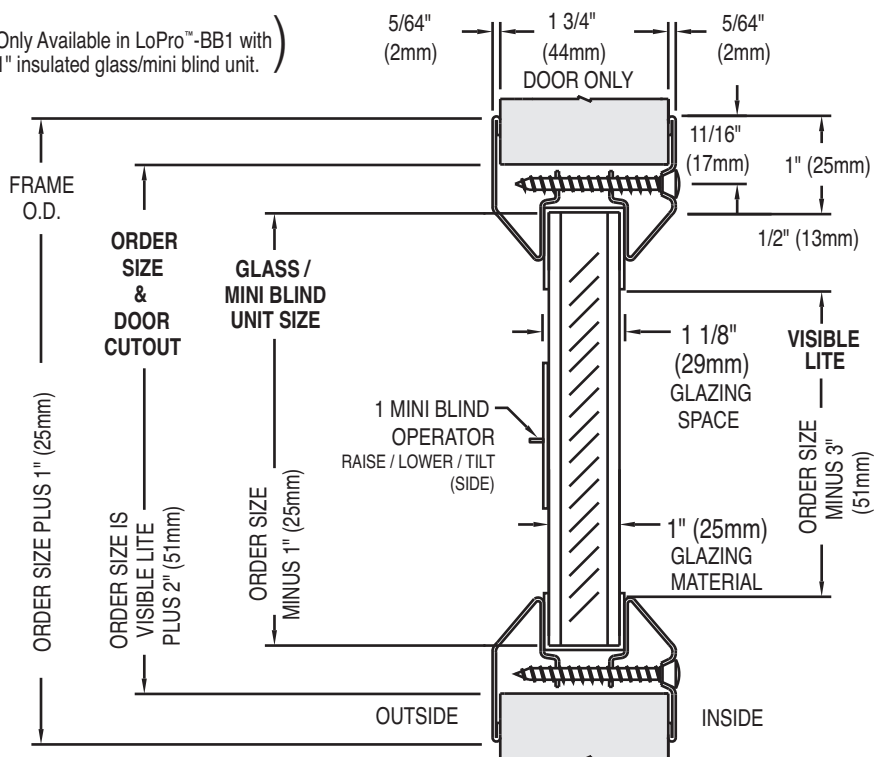

Anemostat manufacturing dimensions $\pm 1/32$
 Actual dimensions are nominal and may vary
 based on component manufacturers tolerances.

STANDARD PRODUCT FEATURES

- MATERIAL:** 20 GA. (1mm) Cold Rolled Steel Vision Frame.
- MINI-BLIND:** Available in white only. Internal Mini-Blind with nylon cord, adjustable painted aluminum blades, sealed in clear tempered glass, 1" overall thickness. Blind will raise, lower and tilt. Adds privacy and security.
- SIZES AVAILABLE:**

9"x37"	9"x65"	21"x37"	23"x37"
(Door Cutout Size)	(229 x 940mm)	(229 x 1651mm)	(533 x 940mm)
		(584 x 940mm)	
8"x65"	15"x65"	21"x65"	23"x49"
(203 x 1651mm)	(381 x 1651mm)	(533 x 1651mm)	(584 x 1245mm)
		(584 x 1651mm)	
		(tilt only)	

Custom sizes not available.
- FINISH:** Vision Frame: Grey Primer, Beige or Bronze Enamel.
- INSTALLATION:** This product is easy to install and provides a low profile, flush to the door look. Uses 1 3/4" (44mm) sheet metal screws that pass through the door cutout, and fastens to the opposite side of the vision frame, saving installation time and labor. It also leaves the corridor side of the frame free of fasteners for added security and a cleaner, more aesthetic appearance.
- DOOR THICKNESS:** For 1 3/4" (44mm) Wood or Metal doors.
- AESTHETICS:** Tight mitered corners, beveled glass stop and low profile, provide a clean tapered look.
- USES:** Hospitals, Judicial and Police Facilities, Board Rooms, Offices or anywhere flexible privacy is required.

OPTIONAL FEATURES

- MATERIAL:** #304 or #316 Stainless Steel, #4 Finish(Satin), Galvanized (Coil, Hot Dipped, or Zinc Plated).
- FINISH:** Custom Baked Enamel Colors (as per sample chip supplied). Plated Finishes to match the lock, hinges and closer.
- FASTENERS:** Special Security Screw Fasteners available, see page 36 this section.

FIRE RATINGS

- LoPro™-BB1-MB is not fire rated.

IMPACT / SAFETY RATINGS

- Meets ANSI Z97.1 and CPSC 16CFR1201 (Cat. I and II)

CONFORMS TO THE FOLLOWING

- ASTM C 1036
- ASTM C 1048
- NOTE:** For Exterior use, High Humidity or Salt Air application, product must be Galvanized or Stainless Steel.

Job Name & Location	Submitted by



TECHNICAL DATA

FROM

Anemostat®

DOOR PRODUCTS

A MESTEK COMPANY

1220 E WATSON CENTER RD
CARSON, CA 90745-4206
(310) 835-7500 • FAX (310) 835-0448

e-mail: door@anemostat.com • website: www.anemostat.com

LoPro™ -STC

LO-PROFILE STC RATED
METAL VISION FRAME ASSEMBLY

FIRE RATINGS WHERE APPLICABLE



UNDERWRITERS'
LABORATORIES



Intertek
WARNOCK
HERSEY



Sound
Transmission
Class

DETAIL DRAWING

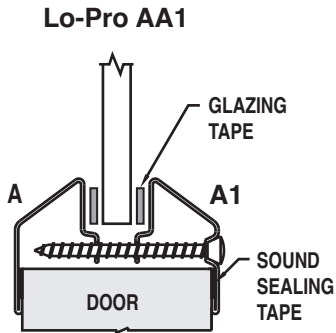

FIRE / SAFETY RATED

- 1/4" SAFE-Wire
- 3/16" FireLite NT
- 5/16" FireLite Plus

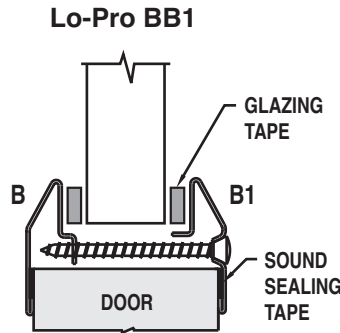

FIRE / SAFETY RATED

- 1" FireLite Plus IGU
- 7/8" Pyrostop 60-101

SAFETY RATED ONLY

- 1" Laminated IGU
- 1" Tempered IGU

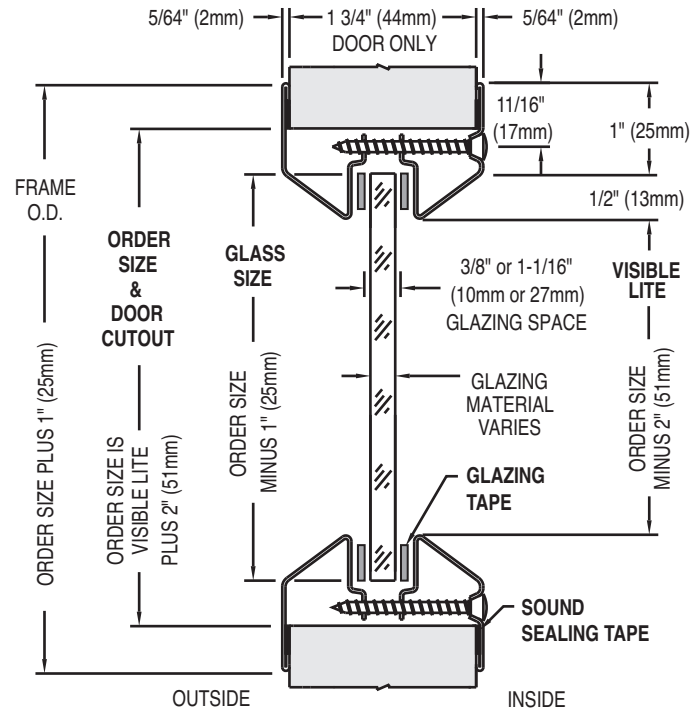

Anemostat manufacturing dimensions $\pm 1/32$
Actual dimensions are nominal and may vary
based on component manufacturers tolerances.

STANDARD PRODUCT FEATURES

- MATERIAL:** 20 GA. (1mm) Cold Rolled Steel.
- FINISH:** Grey Primer, Beige or Bronze Baked Enamel.
CAUTION: Sound Sealing Tape should not be exposed to a heat treating process from post factory applied finishes, such as powder coating.
- INSTALLATION:** Our most popular product is easy to install and provides a low profile, flush to the door look. Uses 1 3/4" (44mm) sheet metal screws that pass through the door cutout, and fastens to the opposite side of the vision frame. Vision frame comes with sound sealing tape applied to the underside perimeter of both frame sides.
- DOOR THICKNESS:** For 1 3/4" (44mm) Wood or Metal Doors.
- GLAZING:** Glass is supplied with GT Glazing Tape for both sides
- AESTHETICS:** Tight mitered corners, beveled glass stop and low profile, provide a clean tapered look.
- IMPORTANT:** Interpretation of building and fire codes may vary. Consult with the local authority having jurisdiction in your area, to determine appropriate standards.
- NOTE:** For Exterior use, High Humidity or Salt Air application, product must be Galvanized or Stainless Steel.

OPTIONAL FEATURES

- MATERIAL:** #304 or #316 Stainless Steel, #4 Finish (Satin), Galvanized (Coil, or Zinc Plated).
- FINISH:** Custom Baked Enamel Colors (as per sample chip supplied). Plated Finishes to match the lock, hinges and closer.
- FASTENERS:** Special Security Screw Fasteners, See Page 36, this section.
- SPECIALS:** Fractional Sizes
- HM CLIP:** Replaces the need for reinforcing channel in the door cutout, see page 37 this section.

FIRE RATINGS (w/ U.L. classification markings) Positive Pressure

- See appropriate Glazing Product Tech Data page

SOUND RATINGS

- LoPro-STC with 1/4" (6mm) SAFE-Wire:* STC - 38
- LoPro-STC with 3/16" (5mm) FireLite NT:* STC - 35
- LoPro-STC with 5/16" (8mm) FireLite Plus:* STC - 38
- LoPro-STC with 1" (25mm) FireLite Plus IGU:* STC - 42
- LoPro-STC with 7/8" (22mm) Pyrostop 60-101 23mm:* STC - 41
- LoPro-STC with 1" (25mm) Laminated IGU: STC - 42 (Safety Rated Only)
- LoPro-STC with 1" (25mm) Tempered IGU: STC - 35 (Safety Rated Only)

TESTED SIZE: 24" X 36" (610 X 914mm) CUTOUT / ASSEMBLY

TESTED IN ACCORDANCE WITH: ASTM E90-09 and ASTM E2235-04.

STC measurements determined in accordance with ASTM E413-04.

Testing conducted at Western Electro - Acoustic Laboratory, Santa Clarita, CA.

* Fire Rated - see Glazing Section for ratings and maximum allowable sizes

Job Name & Location	Submitted by



TECHNICAL DATA

FROM

Anemostat[®]

DOOR PRODUCTS

A MESTEK COMPANY

1220 E WATSON CENTER RD
 CARSON, CA 90745-4206
 (310) 835-7500 • FAX (310) 835-0448

e-mail: door@anemostat.com • website: www.anemostat.com

WoodPro[™]

LO-PROFILE
 METAL VISION FRAME
 WITH WOOD VENEER

PATENT PENDING



FIRE RATED BY
 UNDERWRITERS'
 LABORATORIES

DETAIL DRAWING

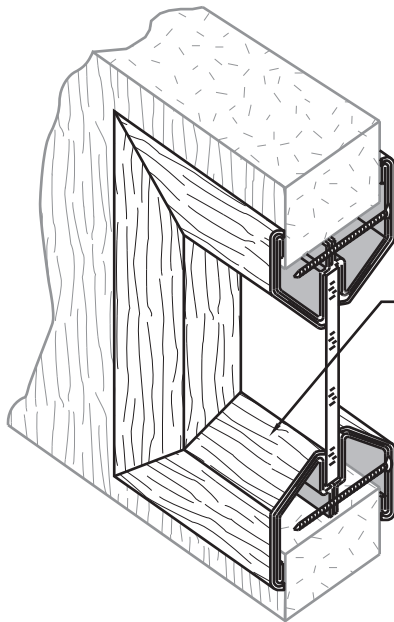

REAL WOOD VENEER
 (.014 THICKNESS)
 OVER PVC PROFILE

IMPORTANT

- For interior use only.
- Minimum Width of 4" (102mm) Door Cutout
- Maximum Height of 72" (1829mm) Door Cutout

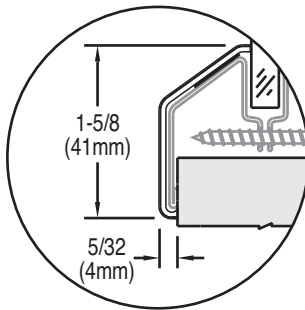

Dimensions for Wood Veneers

Anemostat manufacturing dimensions ±1/32
 Actual dimensions are nominal and may vary
 based on component manufacturers tolerances.

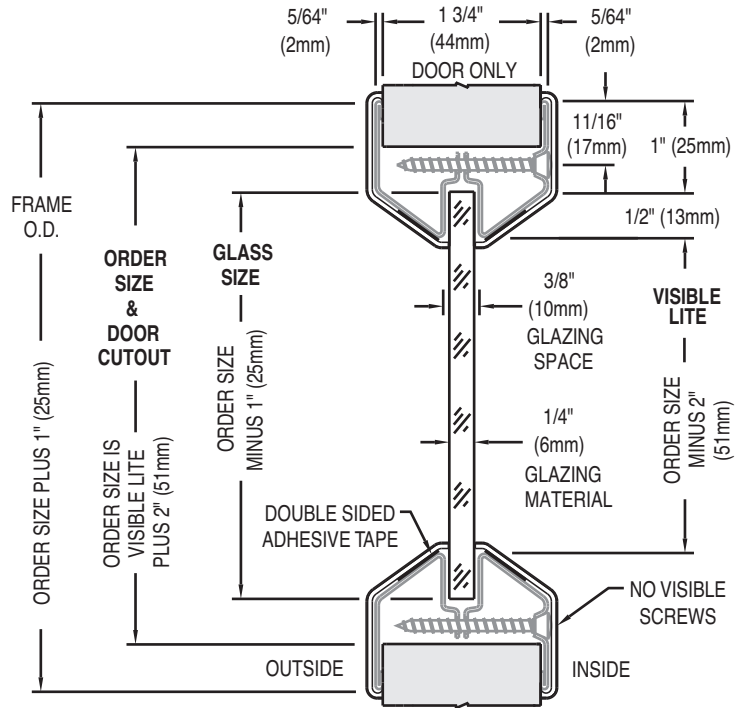

Dimensions Shown for LoPro Metal Vision Frame

STANDARD PRODUCT FEATURES

- **MATERIAL:** Frame: 20 GA. (1mm) Cold Rolled Steel (LoPro Vision Frame).
 Wood Veneer: PVC and Wood Veneer
- **FINISH:** Unfinished Red Oak, Maple, Cherry, or Mahogany over Beige Enamel LoPro.
- **INSTALLATION:** WoodPro is easy to install and provides a low profile, flush to the door real wood finish. Uses 1 3/4" (44mm) sheet metal screws that pass through the door cutout, and fastens to the opposite side of the vision frame. The formed wood veneers are pre-mitered with self-adhesive tape for ease of installation. Wood putty or putty stick may be required at miters to fill any small gaps.
- **DOOR THICKNESS:** For 1 3/4" (44mm) Wood Doors.
- **AESTHETICS:** Tight mitered corners, beveled glass stop and a low profile to provide a clean, tapered look. Veneers are unfinished real wood. No Visible Screws after installation.
- **GLAZING:** Glazing Space will vary based on Glazing Material and will determine thickness of Glazing Tape used. Glazing Material should be fire and safety rated for use as a door lite with U.L. markings when used in a fire rated assembly.
- **IMPORTANT:** Interpretation of building and fire codes may vary. Consult with the local authority having jurisdiction in your area, to determine appropriate standards.

OPTIONAL FEATURES

- **SPECIALS:** Veneers sold separately for use on existing LoPros. Consult Factory (Requires a compound miter cut by installer.)

FIRE RATINGS (w/ U.L. classification markings) Positive Pressure

- **20 MINUTE:** Approved listing at 2520* sq. in. (1.626 m²) visible lite. max. width 36" (914mm), max. height 70" (1778mm).
- **45/60 MINUTE:** Approved listing at 2520* sq. in. (1.626 m²) visible lite. max. width 36" (914mm), max. height 70" (1778mm).
- **90 MINUTE:** Approved listing at 1296* sq. in. (0.836 m²) visible lite. max. width 36" (914mm), max. height 54" (1372mm).

*Must be used with FIRELITE Plus or NT and Fire listed glazing tape or another manufacturer's equivalent product. Glazing combination must be used in appropriately tested door assembly.

- **PLEASE NOTE:** On visible lite sizes larger than 1296 sq. in. (0.836 m²) on 20/45 min. and 100 sq. in. (0.065 m²) on 60/90 min., please consult with your Door / Frame Manufacturer's procedures, for their maximum glass size tested.

Job Name & Location	Submitted by



TECHNICAL DATA

FROM

Anemostat[®]

DOOR PRODUCTS

A MESTEK COMPANY

1220 E WATSON CENTER RD
 CARSON, CA 90745-4206
 (310) 835-7500 • FAX (310) 835-0448

e-mail: door@anemostat.com • website: www.anemostat.com

StormPro-HR[™]

LO-PROFILE HURRICANE RATED
 METAL VISION FRAME ASSEMBLY

HURRICANE RATED



UNDERWRITERS'
 LABORATORIES
 FILE #R26087



Florida Building Code
 Hurricane Approval
 FILE #FL11736

NOT FIRE RATED

DETAIL DRAWING

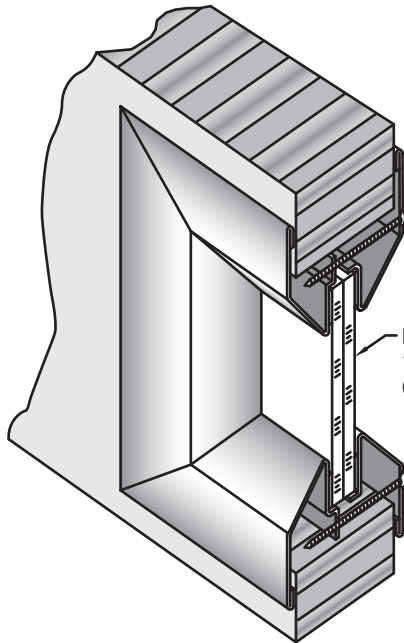

ASSEMBLY INCLUDES:
 VISION FRAME,
 GLAZING TAPE,
 GLASS AND FASTENERS

HURRICANE GLASS
 1/2" (13mm) LAMINATED
 GLASS (INCLUDED)

Anemostat manufacturing dimensions ±1/32
 Actual dimensions are nominal and may vary
 based on component manufacturers tolerances.

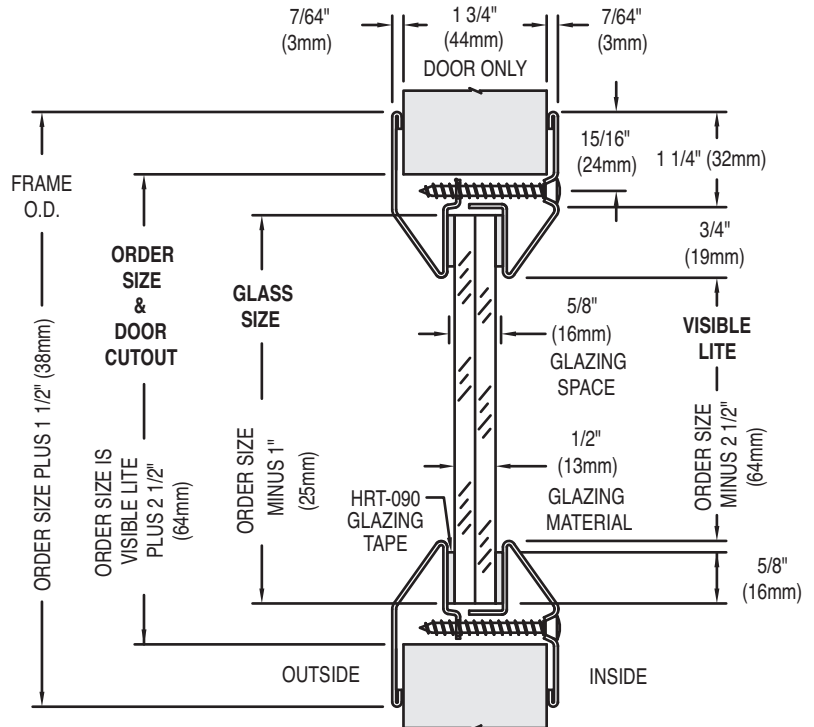

STANDARD PRODUCT FEATURES

- MATERIAL:** 18 GA. (1.25mm) Galvanized Steel, 1/2" (13mm) clear glass and VHB glazing tape.
- FINISH:** Grey Primer, Beige, or Bronze Baked Enamel.
- INSTALLATION:** The StormPro[™]-HR is easy to install and provides a low profile, flush to the door look. Uses 1-3/4" (44mm) sheet metal screws that pass through the door cutout, and fastens to the opposite side of the vision frame.
5/8 (16mm) x .090 (2.3mm) thick conformable 3M VHB glazing tape is supplied and installed on both sides of the glass.
- DOOR THICKNESS:** For 1-3/4" (44mm) Hurricane Approved Metal doors
- GLAZING:** Glass is comprised of 2 pieces of 3/16" (5mm) clear annealed with a .120 Uvekol[™] "S" clear laminate. Overall glass thickness is 1/2" (13mm).
- AESTHETICS:** Tight mitered corners, beveled glass stop and low profile, provide a clean tapered look.
- MAXIMUM SIZE:** 36" (914mm) wide x 72" (1829mm) tall cutout
visible lite 33-1/2" x 69-1/2" (851 x 1765mm)
- NOTE:** For exterior use, high humidity or salt air application, product must be galvanized or stainless steel.

OPTIONAL FEATURES

- MATERIAL:** #304 Stainless Steel, #4 Finish(Satin), Hot Dipped, or Zinc Plated.
- FINISH:** Special Order Baked Enamel Colors (as per sample chip supplied). Plated Finishes to match the lock, hinges and closer.
- FASTENERS:** Special Security Screw Fasteners, See Page 36, this section.
- SPECIALS:** Fractional Sizes

FIRE RATINGS

- StormPro-HR[™] is not fire rated**

HURRICANE TEST / WINDSTORM APPROVALS (w/ U.L. marking)

- Successfully tested in accordance with ASTM E1886, E1996 and E330 and ANSI 250.13-Impact 350 FT LBS. (large missile test) Design Pressure: +/- 70 PSF.
- Complies with Florida Building Code Standards
- IMPORTANT:** Interpretation of building and fire codes may vary. Consult with the local authority having jurisdiction in your area, to determine appropriate Standards.
- ATTENTION:** Must be used in an appropriately tested and hurricane rated door assembly.

Job Name & Location	Submitted by



TECHNICAL DATA

FROM

Anemostat[®]

DOOR PRODUCTS

A MESTEK COMPANY

1220 E WATSON CENTER RD
 CARSON, CA 90745-4206
 (310) 835-7500 • FAX (310) 835-0448

e-mail: door@anemostat.com • website: www.anemostat.com

StormPro-HR™-G

LO-PROFILE HURRICANE RATED
 METAL VISION FRAME ASSEMBLY
 WITH FRENCH DOOR GRILLES

HURRICANE RATED



UNDERWRITERS'
 LABORATORIES
 FILE #R26087



Florida Building Code
 Hurricane Approval
 FILE #FL11736

NOT FIRE RATED

DETAIL DRAWING

**ASSEMBLY INCLUDES: VISION FRAME,
 GLAZING TAPE, GLASS AND FASTENERS**

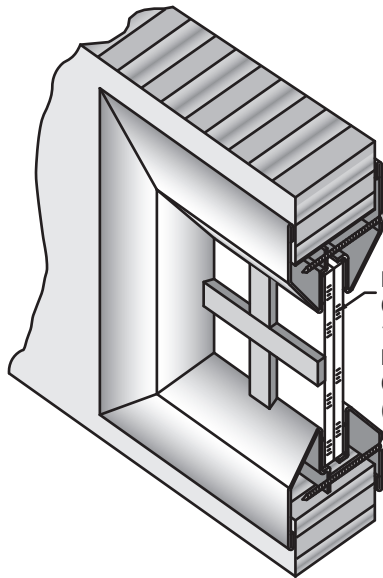

HURRICANE
 GLASS,
 1/2" (13mm)
 LAMINATED
 GLASS
 (INCLUDED)

Anemostat manufacturing dimensions ±1/32
 Actual dimensions are nominal and may vary
 based on component manufacturers tolerances.

STANDARD GRILLE DESIGNS

CUSTOM DESIGNS AVAILABLE, SEE PAGE 10 THIS SECTION

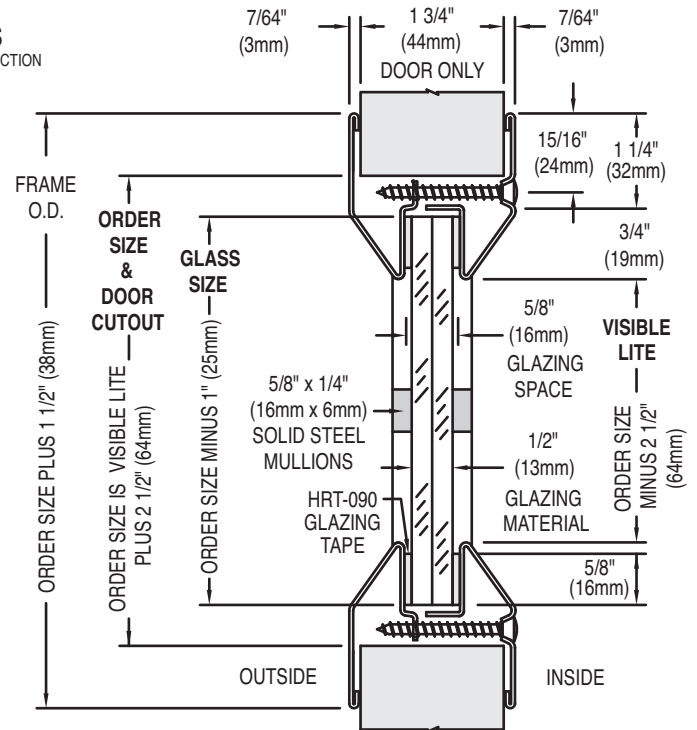
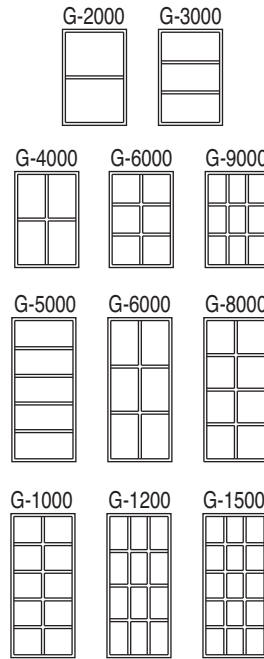

STANDARD PRODUCT FEATURES

- MATERIAL:** 18 GA. (1.25mm) Galvanized Steel - Zinc Plated. 1/2" (13mm) Clear Glass and VHB Glazing Tape.
- FINISH:** Grey Primer, Beige, or Bronze Baked Enamel.
- INSTALLATION:** The StormPro-HR™-G is easy to install and provides a low profile, flush to the door look. Uses 1-3/4" (44mm) sheet metal screws that pass through the door cutout, and fastens to the opposite side of the vision frame. 5/8" (16mm) x .090 (2.3mm) thick conformable 3M VHB glazing tape is supplied and installed on both sides of the glass.
- DOOR THICKNESS:** For 1-3/4" (44mm) Hurricane Approved Metal doors
- GLAZING:** Glass is comprised of 2 pieces of 3/16" (5mm) clear annealed with a .120 Uvekol™ "S" clear laminate. Overall glass thickness is 1/2" (13mm).
- AESTHETICS:** Tight mitered corners, beveled glass stop and low profile, provide a clean tapered look.
- MULLIONS:** Mullions are 5/8" x 1/4" (16 x 6mm) solid steel material fully welded to the frame and to all intersecting points of the mullion design, and ground smooth.
- MAXIMUM SIZE:** 36" (914mm) wide x 72" (1829mm) tall cutout visible lite 33-1/2" x 69-1/2" (851 x 1765mm)
- NOTE:** For exterior use, high humidity or salt air application, product must be galvanized or stainless steel.

OPTIONAL FEATURES

- FINISH:** Special Order Baked Enamel Colors (as per sample chip supplied). Plated Finishes to match the lock, hinges and closer.
- FASTENERS:** Special Security Screw Fasteners, See Page 36, this section.
- SPECIALS:** Fractional Sizes.

FIRE RATINGS

- StormPro-HR™ is not fire rated**

HURRICANE TEST / WINDSTORM APPROVALS (w/ U.L. marking)

- Successfully tested in accordance with ASTM E1886, E1996 and E330 and ANSI 250.13-Impact 350 FT LBS. (large missile test) Design Pressure: +/- 70 PSF.
- Complies with Florida Building Code Standards
- IMPORTANT:** Interpretation of building and fire codes may vary. Consult with the local authority having jurisdiction in your area, to determine appropriate Standards.
- ATTENTION:** Must be used in an appropriately tested and hurricane rated door assembly.

Job Name & Location	Submitted by



TECHNICAL DATA

FROM

Anemostat[®]

DOOR PRODUCTS

A MESTEK COMPANY

1220 E WATSON CENTER RD
CARSON, CA 90745-4206
(310) 835-7500 • FAX (310) 835-0448

e-mail: door@anemostat.com • website: www.anemostat.com

LoPro™-G

FRENCH DOOR LO-PROFILE METAL VISION FRAME



UNDERWRITERS'
LABORATORIES

EN-1634

European Standard

FIRE RATINGS



WARNOCK
HERSEY

B.S.-476.22

British Standard

DETAIL DRAWING

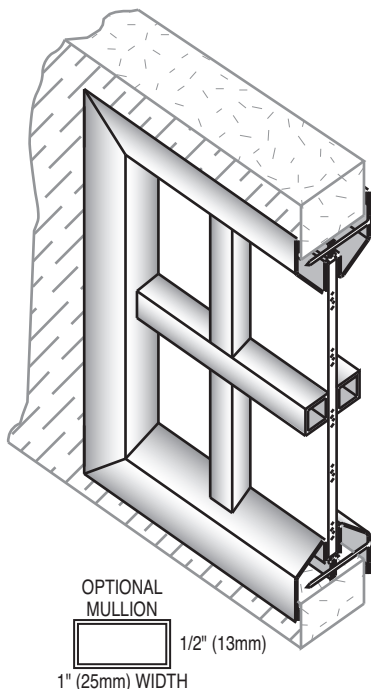

STANDARD GRILLE DESIGNS

CUSTOM DESIGNS AVAILABLE, SEE PAGE 10 THIS SECTION

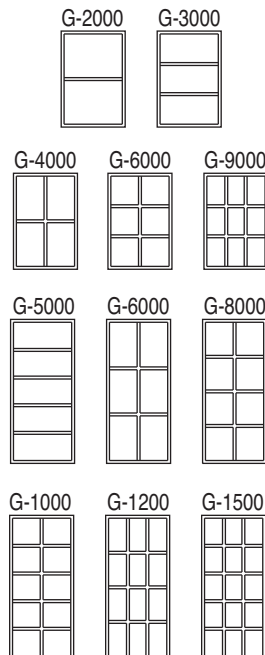

Anemostat manufacturing dimensions 1/32 (0.79mm)
Actual dimensions are nominal and may vary
based on component manufacturers tolerances.

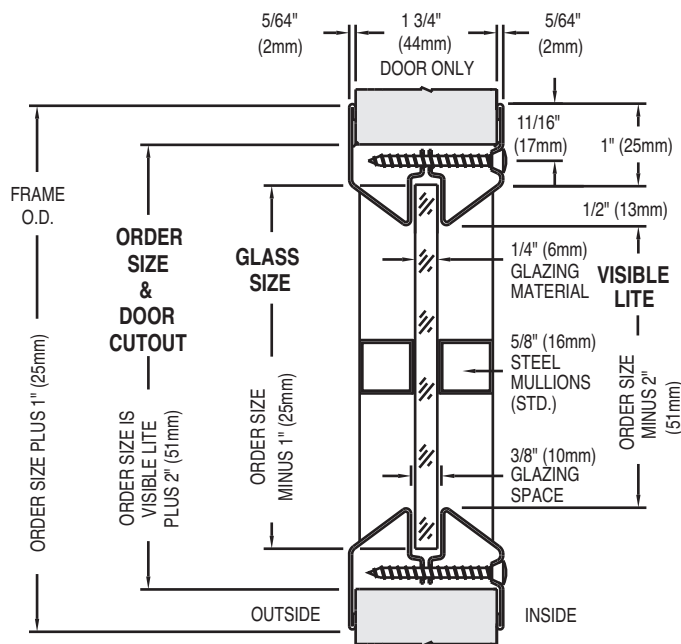

(Also Available using
FGS-75 & BFL-123 profiles,
see pages 11 & 12 this section)

STANDARD PRODUCT FEATURES

- MATERIAL:** Frame is 20 GA. (1mm) Cold Rolled Steel. Mullions are 5/8" x 5/8" (16 x 16mm) steel tube material fully welded to the frame and to all intersecting points of the mullion design, and ground smooth.
- FINISH:** Grey Primer, Beige or Bronze Baked Enamel.
- INSTALLATION:** Uses 1 3/4" (44mm) sheet metal screws that pass through the door cutout, and fastens the opposite side of the vision frame, thus eliminating the need to drill the door for thru bolts and saving installation time and labor. It also leaves the corridor side of the frame free of fasteners for added security and a cleaner, more aesthetic appearance.
- DOOR THICKNESS:** For 1 3/4" (44mm) Wood or Metal Doors.
- GLAZING:** Should be 1/4" (6mm), 3/16" (5mm) or 5/16" (8mm) fire and/or safety rated with U.L. and/or W.H.I. classification markings. Nominal glazing space of 3/8" (10mm) allows for glazing tape to be used on both sides of the glass.
- IMPORTANT:** Interpretation of building and fire codes may vary. Consult with the local authority having jurisdiction in your area, to determine appropriate standards.
- NOTE:** For Exterior use, High Humidity, or Salt Air applications, product must be Galvanized.
- PLEASE NOTE:** On visible lite sizes larger than 1296 sq. in. (0.836 m²) on 20/45 min. and 100 sq. in. (0.065 m²) on 60/90/180 min., please consult with your Door / Frame Manufacturer's procedures, for their maximum glass size tested.

OPTIONAL FEATURES

- MATERIAL:** Galvanized (Hot Dipped or Zinc Plated). Mullions available in 1/2"x1/2" (13 x 13mm) or 1/2"x1" (13 x 25mm) steel tubing. Other tubing sizes available, consult factory.
- FINISH:** Custom Baked Enamel Colors (per sample chip supplied). Plated finishes to match the lock, hinges and closer.
- FASTENERS:** Special Security Screw Fasteners, see page 36.
- SPECIALS:** Choose from grille patterns as shown or create your own. Available for thicker glass.

FIRE RATINGS (w/ U.L. & W.H.I. classification markings) Positive Pressure

- 20 MINUTE:*** Approved listing at 3204 sq.in. (2.067 m²) visible lite max. width 36" (914mm), max. height 89" (2261mm).
- 45/60 MINUTE:*** Approved listing at 2772 sq.in. (1.788 m²) visible lite max. width 36" (914mm), max. height 77" (1956mm).
- 90 MINUTE:*** Approved listing at 1296 sq.in. (0.836 m²) visible lite max. width 36" (914mm), max. height 54" (1372mm).
- 3 Hour:*** Approved listing at 100 sq.in. (0.065m²) visible lite max. width 12" (305mm), max. height 33" (840mm)

* Must be used with FIRELITE Plus or NT and Fire listed glazing tape or another manufacturer's equivalent product. Glazing combination must be used in appropriately tested door assembly.

BS 476.22 Timber Doors - 30 min. and 1 hour.
British Standard Steel Doors - 2 hours (4 hours actual).

EN-1634 30/60 min. integrity and insulation - Indicative Testing
European Std.

Job Name & Location	Submitted by



TECHNICAL DATA

FROM

Anemostat®

DOOR PRODUCTS

A MESTEK COMPANY

1220 E WATSON CENTER RD
 CARSON, CA 90745-4206
 (310) 835-7500 • FAX (310) 835-0448

e-mail: door@anemostat.com • website: www.anemostat.com

FM-G

FRAMED MULLION GRILLE FOR SIDELITES AND BORROWED LITES

NOT FIRE RATED

DETAIL DRAWING

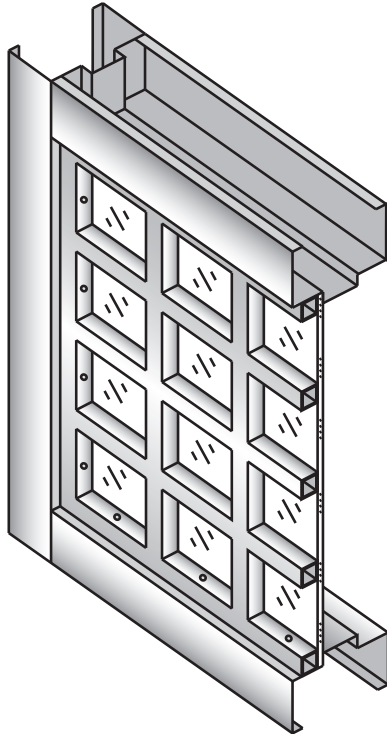

STANDARD GRILLE DESIGNS

CUSTOM DESIGNS AVAILABLE, SEE PAGE 10 THIS SECTION

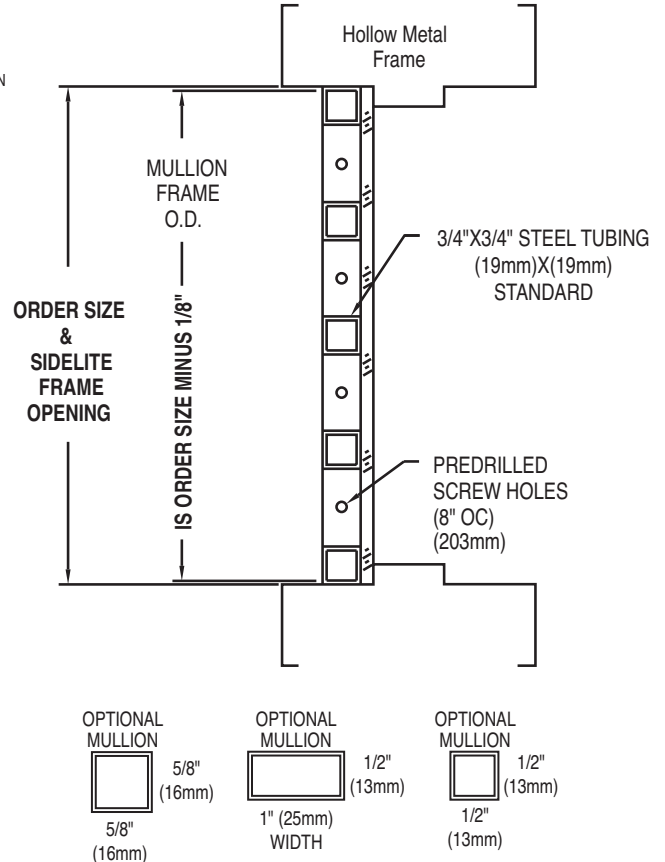
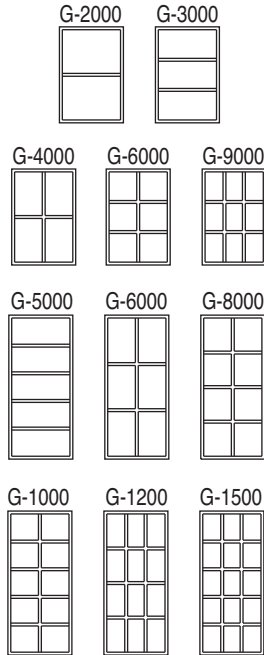

Anemostat manufacturing dimensions $\pm 1/32$
 Actual dimensions are nominal and may vary
 based on component manufacturers tolerances.

STANDARD PRODUCT FEATURES

- **MATERIAL:** Mullions are 3/4" x 3/4" (19 x 19mm) steel tube material welded at all intersecting points of the mullion design and at all corners.
- **FINISH:** Grey Primer, Beige or Bronze Baked Enamel.
- **INSTALLATION:** Predrilled countersunk mounting holes allow #8x1-1/2" (38mm) phillips head tek screws to fasten directly to the hollow metal frame at 8" OC intervals.
- **GLAZING:** Can be any thickness that provides a 3/4" (19mm) spacing allowance for Framed Mullions assembly.
- **AESTHETICS:** Tight mitered corners, with welded and ground smooth intersections of all mullions. Provides divided lite design to accent door or storefront installation. (For Metal Vision Frames with mullion design, see LoPro-G, FGS-75-G, or BFL-123-G on pages 8, 11, and 12 this section.)
- **NOTE:** For Exterior use, High Humidity or Salt Air application, product must be Galvanized.

OPTIONAL FEATURES

- **MATERIAL:** Galvanized (Hot Dipped or Zinc Plated). Mullions available in 1/2"x1/2" (25 x 25mm), 5/8"x5/8" (16 x 16mm) or 1/2"x1" (13 x 25mm) steel tubing. Other tubing sizes available, consult factory.
- **FINISH:** Custom Baked Enamel Colors (as per sample chip supplied). Plated finishes to match the lock, hinges and closer.
- **FASTENERS:** Special Security Screw Fasteners, see page 36, this section.
- **SPECIALS:** Choose from grille patterns as shown or create your own (not available round or curved).

FIRE RATINGS

- **FM-G is not Fire rated, and does not affect a fire-rated sidelite or borrowed lite.**
- **IMPORTANT:** Interpretation of building and fire codes may vary. Consult with the local authority having jurisdiction in your area, to determine appropriate standards.

Job Name & Location	Submitted by



TECHNICAL DATA
FROM
Anemostat[®]
DOOR PRODUCTS
A MESTEK COMPANY

1220 E WATSON CENTER RD
CARSON, CA 90745-4206
(310) 835-7500 • FAX (310) 835-0448
e-mail: door@anemostat.com • website: www.anemostat.com

**CUSTOM
MULLION DESIGN
CONFIRMATION
SHEET**

- G KITS

SPECIFY MODEL

DETAIL DRAWING

CUSTOM DESIGNS: (Drawing Required Please Specify ALL Dimensions)

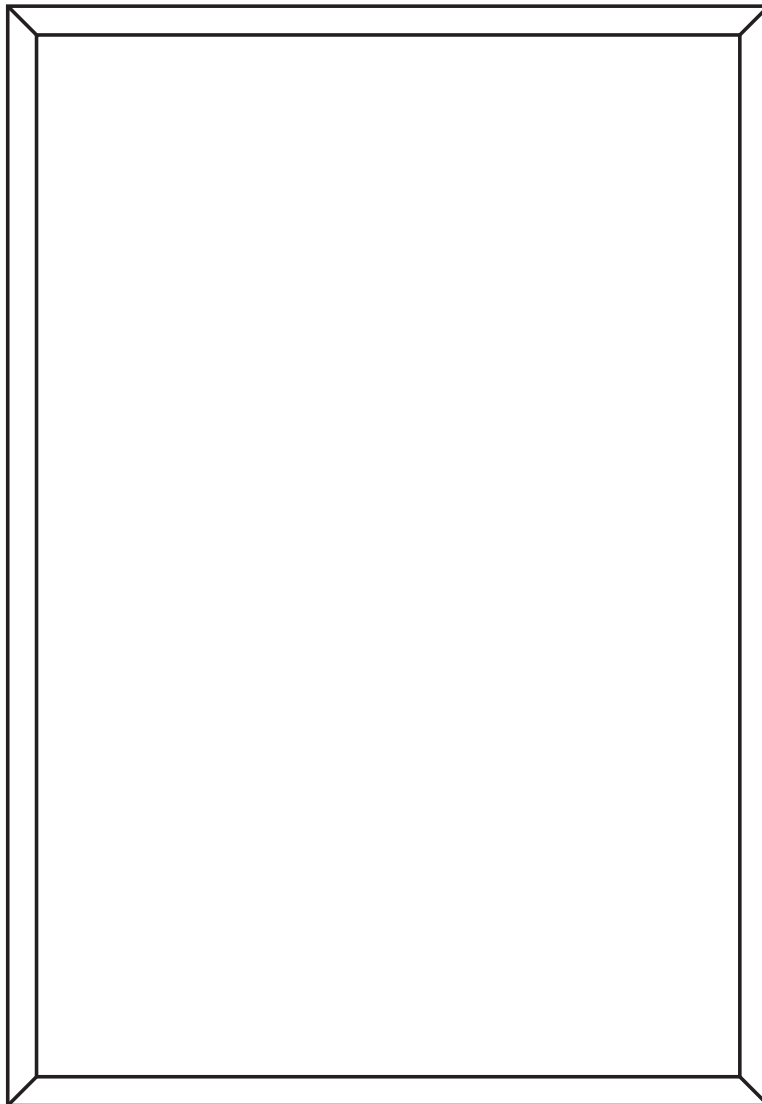

DRAWING # _____
Assigned by Factory

MODEL

- LoPro-G
- FGS-G
- BFL-123-G
- BFL-75-G
- FM-G

MULLION - Tubing Size

- 5/8" x 5/8" (16 x 16mm)
(LoPro™) std.
- 3/4" x 3/4" (19 x 19mm)
(BFL-FGS-FMG) std.
- 1/2" x 1/2" (13 x 13mm)
(various models)
- 1/2" x 1" (13 x 25mm)
(various models)
- Other _____ x _____
consult factory

ORDER SIZE (Door Cutout *):

W _____ x H _____

VERTICAL MULLION(S) _____

HORIZONTAL MULLION(S) _____

QUANTITY:

* FMG - Order Size is Frame Opening

PLEASE SIGN AND DATE. Order will not be processed until confirmation is received.

CUSTOMER CONTACT (Please Print)

E-MAIL

COMPANY NAME

CITY

STATE

P.O. NUMBER

FAX

JOB NAME

ORDER MUST BE SIGNED

X

SIGNATURE

DATE



TECHNICAL DATA

FROM

Anemostat®

DOOR PRODUCTS

A MESTEK COMPANY

1220 E WATSON CENTER RD
 CARSON, CA 90745-4206
 (310) 835-7500 • FAX (310) 835-0448

e-mail: door@anemostat.com • website: www.anemostat.com

FGS-75-G

FRENCH DOOR
 METAL VISION FRAME



UNDERWRITERS'
 LABORATORIES

FIRE
 RATINGS



WARNOCK
 HERSEY

B.S.-476.22
 British Standard

DETAIL DRAWING

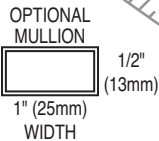
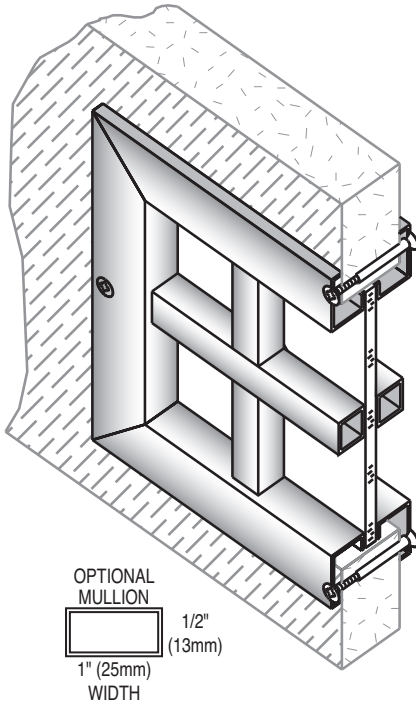

Anemostat manufacturing dimensions ±1/32
 Actual dimensions are nominal and may vary
 based on component manufacturers tolerances.

STANDARD GRILLE DESIGNS

CUSTOM DESIGNS AVAILABLE, SEE PAGE 10 THIS SECTION

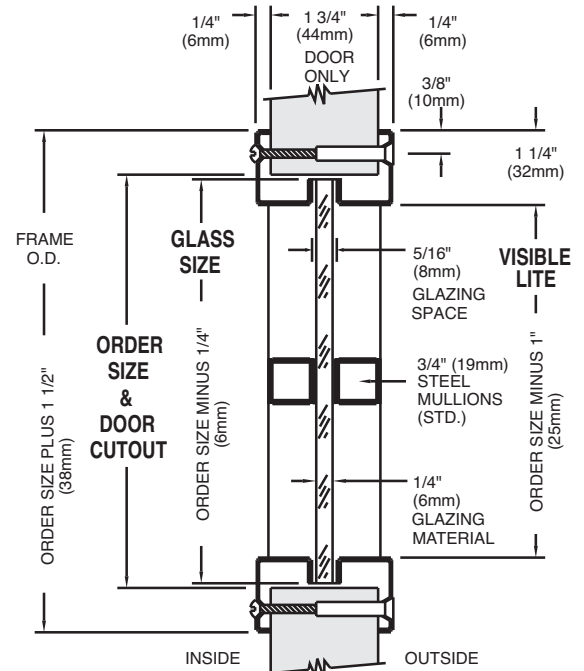
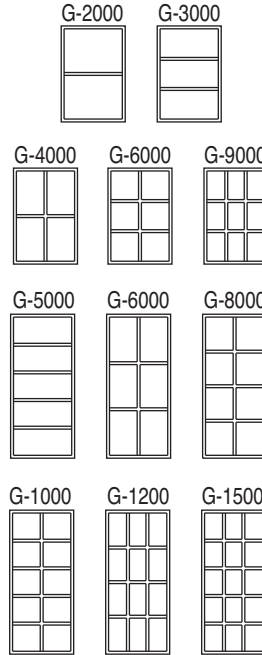

(Also Available using
 LoPro & BFL-123 profiles, see
 pages 8 & 12 this section)

STANDARD PRODUCT FEATURES

- MATERIAL:** 18 GA. (1.25mm) Cold Rolled Steel.
Mullions - are 3/4" x 3/4" (19 x 19mm) steel tube material fully welded to the frame and to all intersecting points of the mullion design, and ground smooth.
- FINISH:** Grey Primer, Beige or Bronze Baked Enamel.
- INSTALLATION:** By drilling 1/4" (6mm) holes thru the door, around the perimeter of the door cutout. Frame has countersunk mounting holes for #8x32 phillips head steel thru bolts with a blank head on one side for flush appearance.
- DOOR THICKNESS:** For 1 3/4" (44mm) Wood or Metal Doors.
- GLAZING:** Should be 1/4" (6mm) or 3/16" (5mm) fire and/or safety rated with U.L. and/or W.H.I. classification markings. Glazing space of 5/16" (8mm) allows for glazing tape to be used on both sides of the glass.
- AESTHETICS:** Tight mitered corners, 90° angle on glass stop for maximum visible lite area.
- IMPORTANT:** Interpretation of building and fire codes may vary. Consult with the local authority having jurisdiction in your area, to determine appropriate standards.
- NOTE:** For Exterior use, High Humidity or Salt Air application, product must be Galvanized.
- PLEASE NOTE:** On visible lite sizes larger than 1296 sq. in. (0.836 m²) on 20/45 min. and 100 sq. in. (0.065 m²) on 60/90/180 min., please consult with your Door / Frame Manufacturer's procedures, for their maximum glass size tested.

OPTIONAL FEATURES

- MATERIAL:** Galvanized (Hot Dipped or Zinc Plated).
Mullions available in 1/2"x1/2", 5/8"x5/8" or 1/2"x1" steel tubing. Other tubing sizes available, consult factory.
- FINISH:** Custom Baked Enamel Colors (as per sample chip supplied).
Plated Finishes to match the lock, hinges and closer.
- FASTENERS:** Special Security Screw Fasteners, See Page 36, this section.
- SPECIALS:** Choose from grille patterns as shown or create your own.
Available for thicker glass with 1/2" or 5/8" mullions.

FIRE RATINGS (w/ U.L. & W.H.I. classification markings) Positive Pressure

- 20 MINUTE:*** Approved listing at 3204 sq.in. (2.067 m²) visible lite
max. width 36" (914mm), max. height 89" (2261mm).
 - 45/60 MINUTE:*** Approved listing at 2772 sq.in. (1.788 m²) visible lite
max. width 36" (914mm), max. height 77" (1956mm).
 - 90 MINUTE:*** Approved listing at 1296 sq.in. (0.836 m²) visible lite
max. width 36" (914mm) , max. height 54" (1372mm).
 - 3 Hour:*** Approved listing at 100 sq.in. (0.065 m²) visible lite
max. width 12" (305mm), max. height 33" (838mm)
- * Must be used with FIRELITE Plus or NT and Fire listed glazing tape or another manufacturer's equivalent product. Glazing combination must be used in appropriately tested door assembly.

BS 476.22

British Standard Timber Doors - 30 min. and 1 hour.
 Steel Doors - 2 hours (4 hours actual).

Job Name & Location	Submitted by



TECHNICAL DATA

FROM

Anemostat®

DOOR PRODUCTS

A MESTEK COMPANY

1220 E WATSON CENTER RD
 CARSON, CA 90745-4206
 (310) 835-7500 • FAX (310) 835-0448

e-mail: door@anemostat.com • website: www.anemostat.com

BFL-123-G

FRENCH DOOR
 METAL VISION FRAME



UNDERWRITERS'
 LABORATORIES

FIRE
 RATINGS



WARNOCK
 HERSEY

B.S.-476.22
 British Standard

DETAIL DRAWING

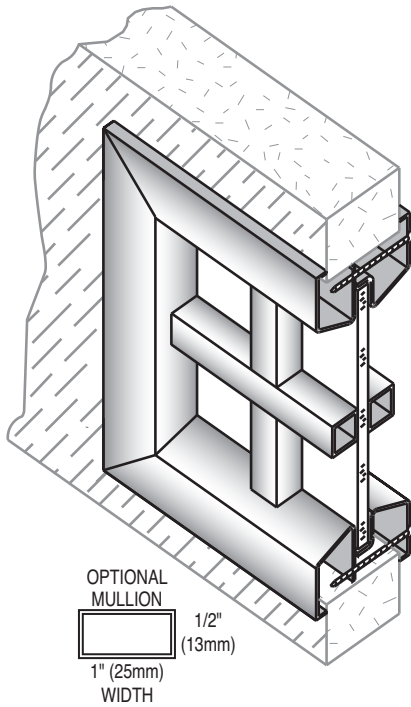

STANDARD GRILLE DESIGNS

CUSTOM DESIGNS AVAILABLE, SEE PAGE 10 THIS SECTION

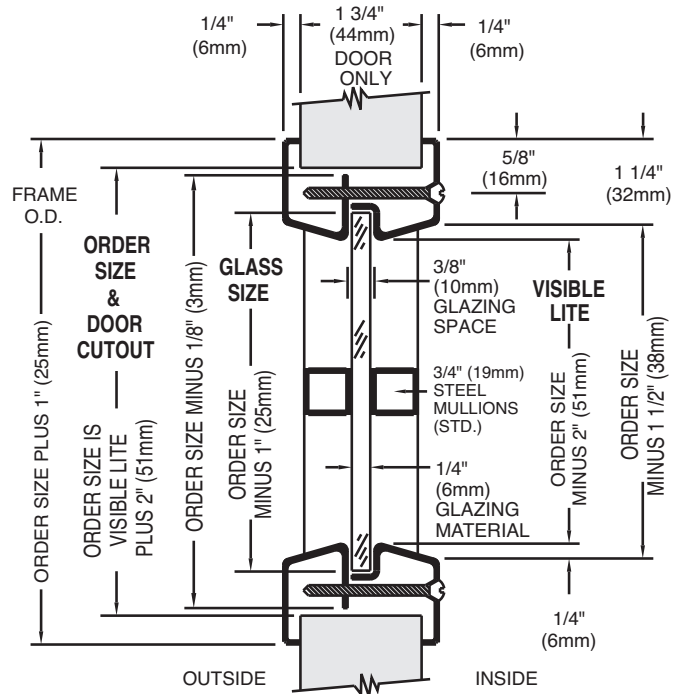
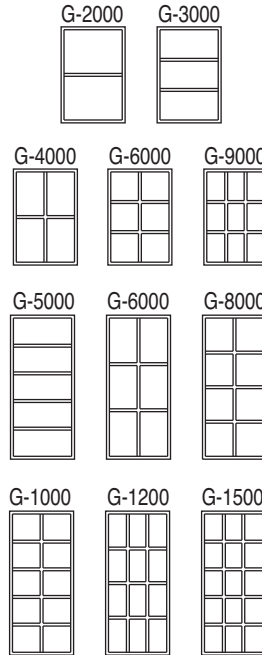

(Also Available using
 LoPro & FGS-75 profiles, see
 pages 8 & 11 this section)

Anemostat manufacturing dimensions ±1/32
 Actual dimensions are nominal and may vary
 based on component manufacturers tolerances.

STANDARD PRODUCT FEATURES

- MATERIAL:** 18 GA. (1.25mm) Cold Rolled Steel.
 Mullions - are 3/4" x 3/4" (19 x 19mm) steel tube material fully welded to the frame and to all intersecting points of the mullion design, and ground smooth.
- FINISH:** Grey Primer, Beige or Bronze Baked Enamel.
- INSTALLATION:** Uses 1 3/4" (44mm) sheet metal screws that pass through the door cutout, and fastens the opposite side of the vision frame, thus eliminating the need to drill the door for thru bolts and saving installation time and labor. It also leaves the corridor side of the frame free of fasteners for added security and a cleaner, more aesthetic appearance.
- DOOR THICKNESS:** For 1 3/4" (44mm) Wood or Metal Doors.
- GLAZING:** Should be 1/4" (6mm) or 3/16" (5mm) fire and/or safety rated with U.L. and/or W.H.I. classification markings. Glazing space of 3/8" (10mm) allows for glazing tape to be used on both sides of the glass.
- IMPORTANT:** Interpretation of building and fire codes may vary.
 Consult with the local authority having jurisdiction in your area, to determine appropriate standards.
- NOTE:** For Exterior use, High Humidity or Salt Air application, product must be Galvanized.
- PLEASE NOTE:** On visible lite sizes larger than 1296 sq. in. on 20/45 min. and 100 sq. in. on 60/90/180 min., please consult with your Door / Frame Manufacturer's procedures, for their maximum glass size tested.

OPTIONAL FEATURES

- MATERIAL:** Galvanized (Hot Dipped or Zinc Plated).
 Mullions available in 1/2"x1/2" (13 x 13mm) , 5/8"x5/8" (16 x 16mm) or 1/2"x1" (13 x 25mm) steel tubing. Other tubing sizes available, consult factory.
- FINISH:** Custom Baked Enamel Colors (as per sample chip supplied).
 Plated Finishes to match the lock, hinges and closer.
- FASTENERS:** Special Security Screw Fasteners, see page 36.
- SPECIALS:** Choose from grille patterns as shown or create your own.

FIRE RATINGS (w/ U.L. & W.H.I. classification markings) Positive Pressure

- 20 MINUTE:*** Approved listing at 3204 sq. in. (2.067 m²) visible lite.
 max. w 36" (914mm), max. h 89" (2261mm).
- 45/60 MINUTE:*** Approved listing at 2772 sq. in. (1.788 m²) visible lite.
 max. w 36" (914mm), max. h 77" (1956mm).
- 90 MINUTE:*** Approved listing at 1296 sq. in. (0.836 m²) visible lite.
 max. w 36" (914mm), max. h 54" (1372mm).
- 3 HOUR:*** Approved listing at 100 sq. in. (0.065 m²) visible lite.
 max. w 12" (305mm), max. h 33" (838mm).

*Must be used with FIRELITE Plus or NT and Fire listed glazing tape or another manufacturer's equivalent product. Glazing combination must be used in appropriately tested door assembly.

BS 476.22 Timber Doors - 30 min. and 1 hour.
 British Standard Steel Doors - 2 hours (4 hours actual).

Job Name & Location	Submitted by



TECHNICAL DATA
FROM
Anemostat[®]
DOOR PRODUCTS
A MESTEK COMPANY

1220 E WATSON CENTER RD
CARSON, CA 90745-4206
(310) 835-7500 • FAX (310) 835-0448

e-mail: door@anemostat.com • website: www.anemostat.com

FGS-75

METAL
VISION FRAME



UNDERWRITERS'
LABORATORIES

FIRE
RATINGS



WARNOCK
HERSEY

B.S.-476.22
British Standard

DETAIL DRAWING

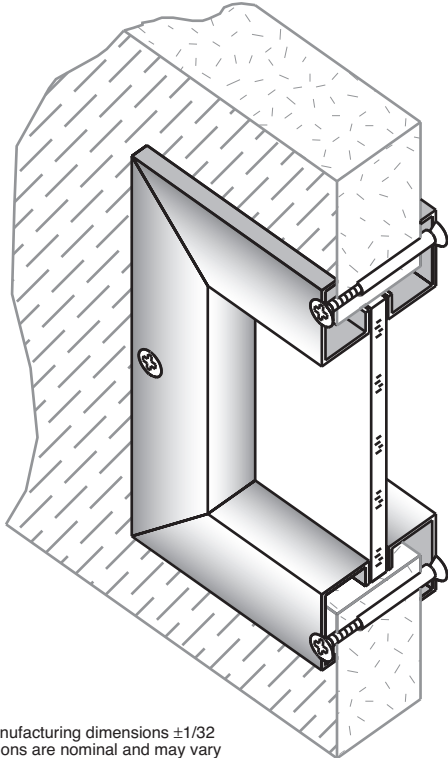

Anemostat manufacturing dimensions ±1/32
Actual dimensions are nominal and may vary
based on component manufacturers tolerances.

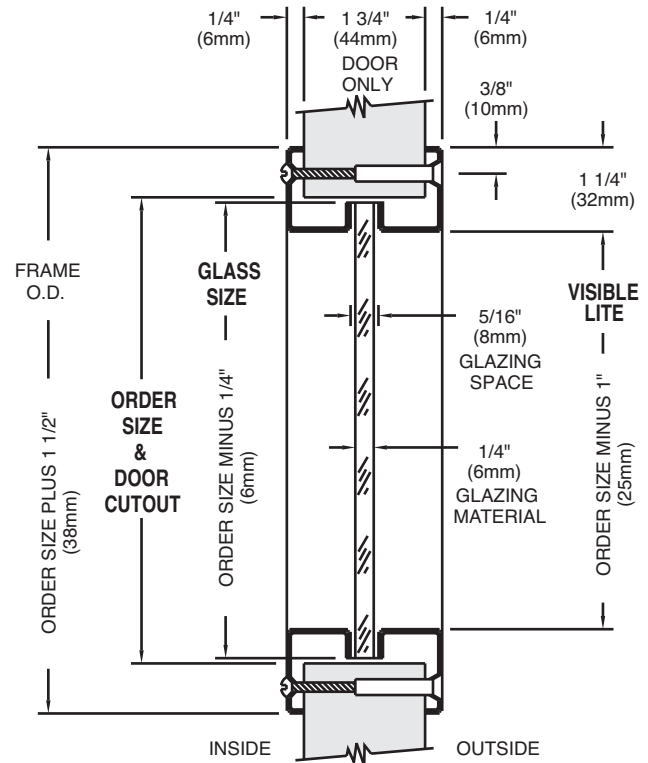

STANDARD PRODUCT FEATURES

- **MATERIAL:** 18 GA. (1.25mm) Cold Rolled Steel.
- **FINISH:** Grey Primer, Beige or Bronze Baked Enamel.
- **INSTALLATION:** By drilling 1/4" holes thru the door, around the perimeter of the door cutout.
Frame has countersunk mounting holes for #8x32 phillips head steel thru bolts with a blank head on one side for flush appearance and added security.
- **DOOR THICKNESS:** For 1 3/4" (44mm) Wood or Metal Doors.
- **GLAZING:** Should be 1/4" (6mm) or 3/16" (5mm) fire and/or safety rated with U.L. and/or W.H.I. classification markings.
Glazing space of 5/16" (8mm) allows for glazing tape to be used on both sides of the glass.
- **AESTHETICS:** Tight mitered corners, 90° angle on glass stop for maximum visible lite area.
- **IMPORTANT:** Interpretation of building and fire codes may vary.
Consult with the local authority having jurisdiction in your area, to determine appropriate standards.
- **NOTE:** For Exterior use, High Humidity or Salt Air application, product must be Galvanized or Stainless Steel.
- **PLEASE NOTE:** On visible lite sizes larger than 1296 sq. in. on 20/45 min. and 100 sq. in. on 60/90/180 min., please consult with your Door / Frame Manufacturer's procedures, for their maximum glass size tested.

OPTIONAL FEATURES

- **MATERIAL:** #304 or #316 Stainless Steel, #4 Finish(Satin), Galvanized (Coil, Hot Dipped, or Zinc Plated), Aluminum Mill Finish (not fire rated)
- **FINISH:** Custom Baked Enamel Colors (as per sample chip supplied).
Plated Finishes to match the lock, hinges and closer.
- **FASTENERS:** Special Security Screw Fasteners, See Page 36, this section.
- **SPECIALS:** Fractional Sizes, Lead Lined for X-ray applications,
Glass or Door thickness (see FGS-IS or FGS-DBL).
- **HM CLIP:** Replaces the need for reinforcing channel in the door cutout, see page 37 this section.

FIRE RATINGS (w/ U.L. & W.H.I. classification markings) Positive Pressure

- **20 MINUTE:*** Approved listing at 3204 sq.in. (2.067 m²) visible lite
max. width 36" (914mm), max. height 89" (2261mm).
 - **45/60 MINUTE:*** Approved listing at 2772 sq.in. (1.788 m²) visible lite
max. width 36" (914mm), max. height 77"(1956mm).
 - **90 MINUTE:*** Approved listing at 1296 sq.in. (0.836 m²) visible lite
max. width 36" (914mm) , max. height 54" (1372mm).
 - **3 Hour:*** Approved listing at 100 sq.in. (0.065 m²) visible lite
max. width 12" (305mm), max. height 33" (838mm)
- * Must be used with FIRELITE Plus or NT and Fire listed glazing tape or another manufacturer's equivalent product. Glazing combination must be used in appropriately tested door assembly.

BS 476.22 Timber Doors - 30 min. and 1 hour.
British Standard Steel Doors - 2 hours (4 hours actual).

Job Name & Location	Submitted by



TECHNICAL DATA
FROM
Anemostat[®]
DOOR PRODUCTS
A MESTEK COMPANY

1220 E WATSON CENTER RD
CARSON, CA 90745-4206
(310) 835-7500 • FAX (310) 835-0448

e-mail: door@anemostat.com • website: www.anemostat.com

FGS-38

METAL
VISION FRAME
(1 3/8" DOORS)

NOT FIRE RATED

DETAIL DRAWING

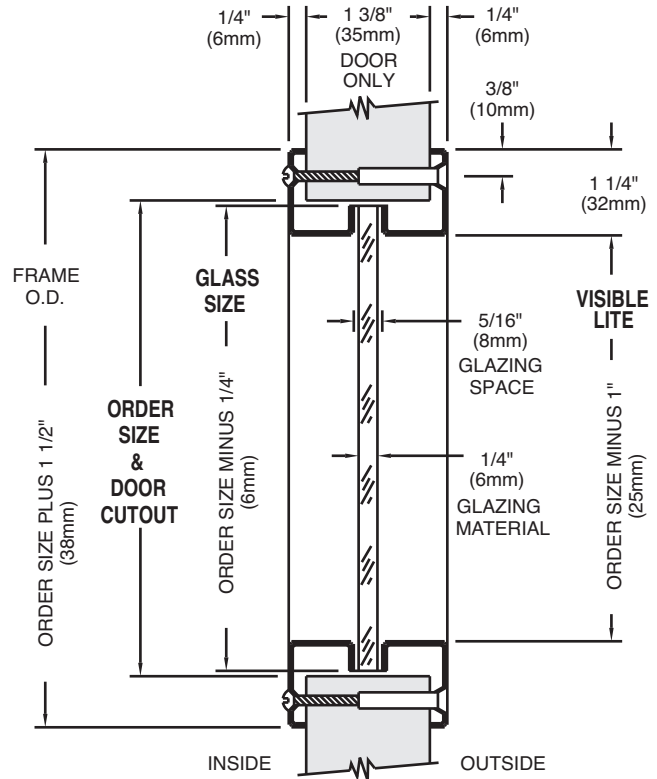
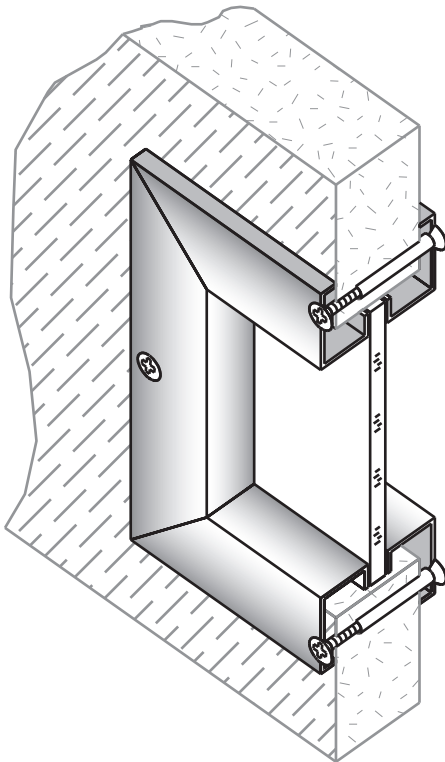

Anemostat manufacturing dimensions $\pm 1/32$
Actual dimensions are nominal and may vary
based on component manufacturers tolerances.

For Self-Attaching Installation see **LoPro™-AB1-NR** (page 2)

STANDARD PRODUCT FEATURES

- **MATERIAL:** 18 GA. (1.25mm) Cold Rolled Steel.
- **FINISH:** Grey Primer, Beige or Bronze Baked Enamel.
- **INSTALLATION:** By drilling 1/4" (6mm) holes thru the door, around the perimeter of the door cutout. Frame has countersunk mounting holes for #8x32 phillips head steel thru bolts with a blank head on one side for flush appearance.
- **DOOR THICKNESS:** For 1 3/8" (35mm) only.
- **GLAZING:** Should be 1/4" (6mm) safety rated. Glazing space of 5/16" (8mm) allows for glazing tape to be used on both sides of the glass.
- **AESTHETICS:** Tight mitered corners, 90° angle on glass stop for maximum visible lite area.
- **NOTE:** For Exterior use, High Humidity or Salt Air application, product must be Galvanized or Stainless Steel.

OPTIONAL FEATURES

- **MATERIAL:** #304 or #316 Stainless Steel, #4 Finish(Satin), Galvanized (Coil, Hot Dipped, or Zinc Plated).
- **FINISH:** Custom Baked Enamel Colors (as per sample chip supplied). Plated Finishes to match the lock, hinges and closer.
- **FASTENERS:** Special Security Screw Fasteners, See Page 36, this section.
- **SPECIALS:** Fractional Sizes, Other Glass or Door thickness (see FGS-IS or LoPro™-IS).

FIRE RATINGS

- **FGS-38 is not fire rated.**
- **IMPORTANT:** Interpretation of building and fire codes may vary. Consult with the local authority having jurisdiction in your area, to determine appropriate standards.

Job Name & Location	Submitted by



TECHNICAL DATA
FROM
Anemostat[®]
DOOR PRODUCTS
A MESTEK COMPANY

1220 E WATSON CENTER RD
CARSON, CA 90745-4206
(310) 835-7500 • FAX (310) 835-0448

e-mail: door@anemostat.com • website: www.anemostat.com

FGS-IS
METAL VISION FRAME FOR
SPECIAL GLASS
OR DOOR THICKNESS



UNDERWRITERS'
LABORATORIES

FIRE
RATINGS



WARNOCK
HERSEY

B.S.-476.22
British Standard

DETAIL DRAWING

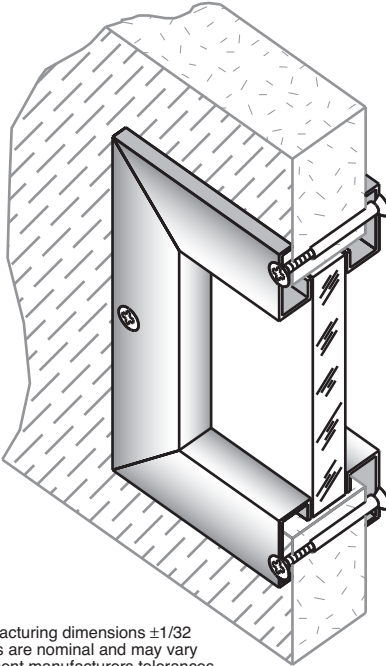

Anemostat manufacturing dimensions $\pm 1/32$
Actual dimensions are nominal and may vary
based on component manufacturers tolerances.

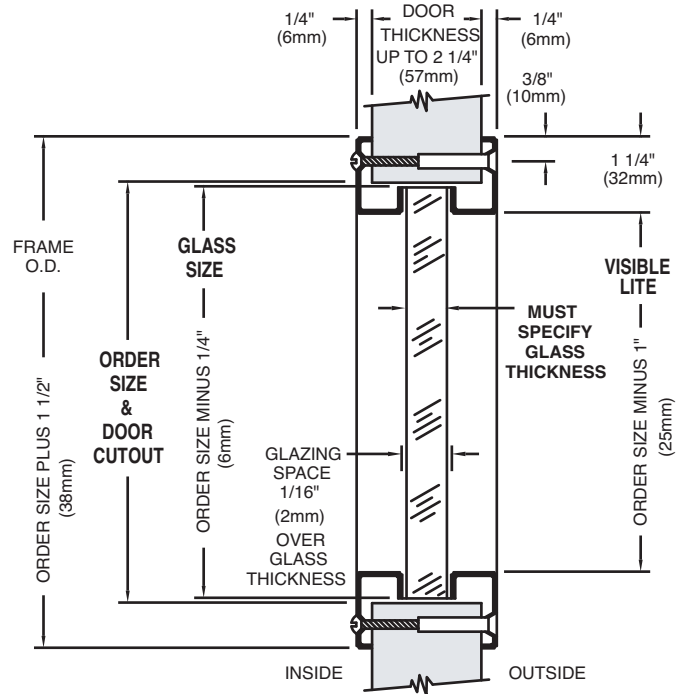

STANDARD PRODUCT FEATURES

- **MATERIAL:** 18 GA. (1.25mm) Cold Rolled Steel.
- **FINISH:** Grey Primer, Beige or Bronze Baked Enamel.
- **INSTALLATION:** By drilling 1/4" (6mm) holes thru the door, around the perimeter of the door cutout. Frame has countersunk mounting holes for #8x32 phillips head steel thru bolts with a blank head on one side for flush appearance and added security.
- **DOOR THICKNESS:** 1 3/4" (44mm) is standard. Specified up to 2 1/4" (57mm). Must be 1/4" (6mm) minimum thicker than glass.
- **GLAZING:** Thickness can range from over 3/16" (5mm) and up to 1 9/16" (40mm). Glazing space of 1/16" (2mm) over glass thickness is standard, allowing for glazing tape to be used on both sides of the glass. Glazing material should be fire and safety rated with U.L. and/or W.H.I. classification markings.
- **AESTHETICS:** Tight mitered corners, 90° angle on glass stop for maximum visible lite area.
- **IMPORTANT:** Interpretation of building and fire codes may vary. Consult with the local authority having jurisdiction in your area, to determine appropriate standards.
- **NOTE:** For Exterior use, High Humidity or Salt Air application, product must be Galvanized or Stainless Steel.
- **PLEASE NOTE:** On visible lite sizes larger than 1296 sq. in. on 20/45 min. and 100 sq. in. on 60/90/180 min., please consult with your Door / Frame Manufacturer's procedures, for their maximum glass size tested.

OPTIONAL FEATURES

- **MATERIAL:** #304 or #316 Stainless Steel, #4 Finish(Satin), Galvanized (Coil Hot Dipped, or Zinc Plated).
- **FINISH:** Custom Baked Enamel Colors (as per sample chip supplied). Plated Finishes to match the lock, hinges and closer.
- **FASTENERS:** Special Security Screw Fasteners, See Page 36, this section.
- **SPECIALS:** Fractional Sizes, Lead Lined for X-ray applications. For mullions (see FGS-IS-G or LoPro™-IS-G).
- **HM CLIP:** Replaces the need for reinforcing channel in the door cutout, see page 37 this section.

FIRE RATINGS (w/ U.L. & W.H.I. classification markings) Positive Pressure

- **20/45/60/90 MINUTE:*** Approved listing at 1080 sq. in. (0.697 m²) visible lite. max. width 36" (914mm), max. height 36" (914mm).
*Must be used with 7/8" (23mm) or 1-1/16" (27mm) Pyrostop and fire listed glazing tape, and be used in an appropriately tested door assembly.
 - **20 MINUTE:**** Approved listing at 3204 sq. in. (2.067 m²) visible lite. max. w 36" (914mm), max. h 89" (2261mm).
 - **45/60 MINUTE:**** Approved listing at 2772 sq. in. (1.788 m²) visible lite. max. w 36" (914mm), max. h 77" (1956mm).
 - **90 MINUTE:**** Approved listing at 1296 sq. in. (0.836 m²) visible lite. max. w 36" (914mm), max. h 54" (1372mm).
 - **3 HOUR:**** Approved listing at 100 sq. in. (0.065 m²) visible lite. max. w 12" (305mm), max. h 33" (838mm).
- **Must be used with FIRELITE IGU 1" (25mm) Cat II or FIRELITE Plus and Fire listed glazing tape or another manufacturer's equivalent product. Glazing combination must be used in appropriately tested door assembly.

BS 476.22 Timber Doors - 30 min. and 1 hour.
British Standard Steel Doors - 2 hours (4 hours actual).

Job Name & Location	Submitted by



TECHNICAL DATA

FROM

Anemostat®

DOOR PRODUCTS

A MESTEK COMPANY

1220 E WATSON CENTER RD

CARSON, CA 90745-4206

(310) 835-7500 • FAX (310) 835-0448

e-mail: door@anemostat.com • website: www.anemostat.com

FGS-DBL

METAL VISION FRAME
FOR
DOUBLE GLAZING



UNDERWRITERS'
LABORATORIES

FIRE
RATINGS



WARNOCK
HERSEY

DETAIL DRAWING

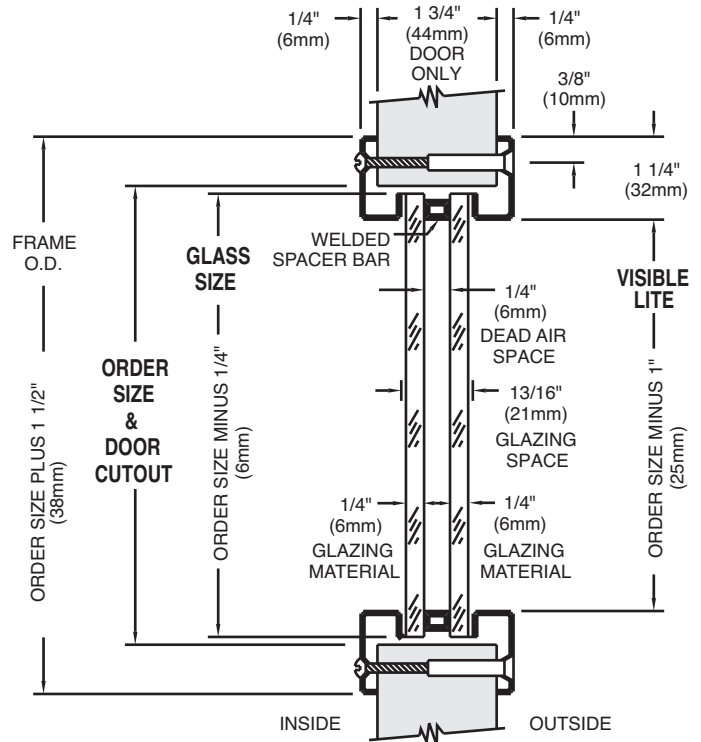
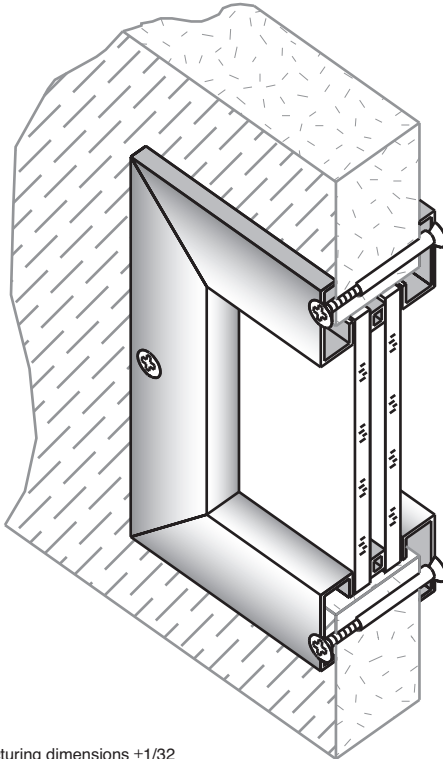

Anemostat manufacturing dimensions $\pm 1/32$
Actual dimensions are nominal and may vary
based on component manufacturers tolerances.

STANDARD PRODUCT FEATURES

- **MATERIAL:** 18 GA. (1.25mm) Cold Rolled Steel.
- **FINISH:** Grey Primer, Beige or Bronze Baked Enamel.
- **INSTALLATION:** By drilling 1/4" (6mm) holes thru the door, around the perimeter of the door cutout. Frame has countersunk mounting holes for #8x32 phillips head steel thru bolts with a blank head on one side for flush appearance.
- **DOOR THICKNESS:** For 1 3/4" (44mm) Wood or Metal Doors.
- **GLAZING:** Should be two 1/4" (6mm) pieces separated by a 1/4" (6mm) spacer (spacer only furnished with vision frame). Glazing space of 1/16" (2mm) over glass and spacer thickness is standard, allowing for glazing tape to be used on both sides of the glass.
- **AESTHETICS:** Tight mitered corners, 90° angle on glass stop for maximum visible lite area.
- **NOTE:** For Exterior use, High Humidity or Salt Air application, product must be Galvanized or Stainless Steel.

OPTIONAL FEATURES

- **MATERIAL:** #304 or #316 Stainless Steel, #4 Finish(Satin), Galvanized (Coil, Hot Dipped, or Zinc Plated).
- **FINISH:** Custom Baked Enamel Colors (as per sample chip supplied). Plated Finishes to match the lock, hinges and closer.
- **FASTENERS:** Special Security Screw Fasteners, See Page 36, this section.
- **SPECIALS:** Fractional Sizes, Spacer between glass is available in other thicknesses, consult factory for information.

FIRE RATINGS (w/ U.L. & W.H.I. classification markings) Positive Pressure

- **20/45 MINUTE:** Approved listing at 1296 sq. in. (0.836 m²) visible lite. max. width 54" (1372) , max. height 54" (1372).
- **60/90 MINUTE:** Approved listing at 100 sq. in. (0.065m²) visible lite. max. width 10" (254mm) , max. height 33" (838mm).
- **IMPORTANT:** Interpretation of building and fire codes may vary. Consult with the local authority having jurisdiction in your area, to determine appropriate standards.

Job Name & Location	Submitted by



TECHNICAL DATA
FROM
Anemostat[®]
DOOR PRODUCTS
A MESTEK COMPANY

1220 E WATSON CENTER RD
CARSON, CA 90745-4206
(310) 835-7500 • FAX (310) 835-0448

e-mail: door@anemostat.com • website: www.anemostat.com

BFL-123

METAL
VISION FRAME



UNDERWRITERS'
LABORATORIES

FIRE
RATINGS



WARNOCK
HERSEY

B.S.-476.22
British Standard

DETAIL DRAWING

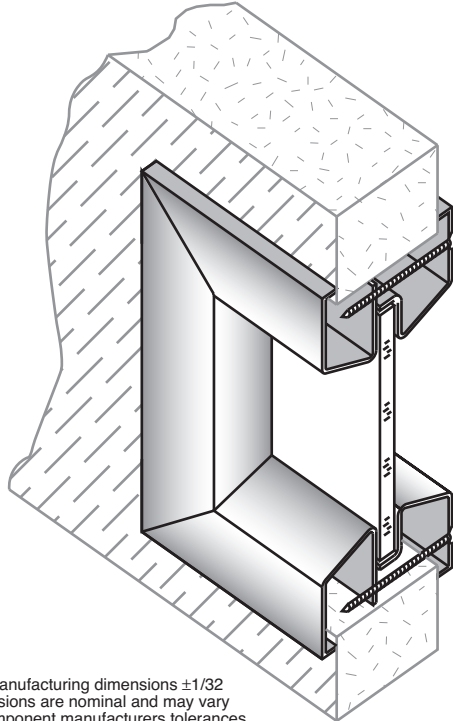

Anemostat manufacturing dimensions ±1/32
Actual dimensions are nominal and may vary
based on component manufacturers tolerances.

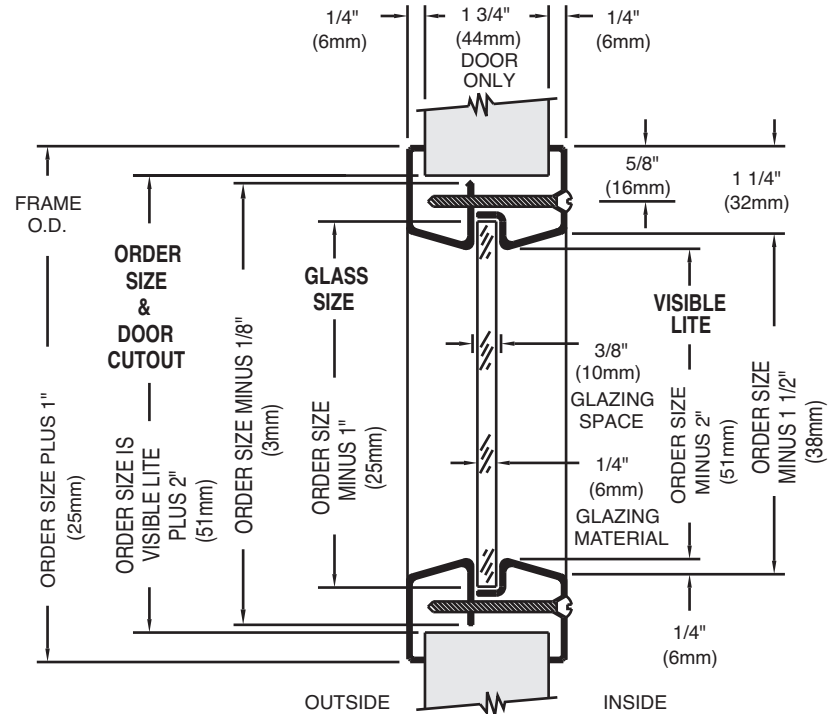

STANDARD PRODUCT FEATURES

- MATERIAL:** 18 GA. (1.25mm) Cold Rolled Steel.
- FINISH:** Grey Primer, Beige or Bronze Baked Enamel.
- INSTALLATION:** Uses 1 3/4" (44mm) sheet metal screws that pass through the door cutout, and fastens to the opposite side of the vision frame, thus eliminating the need to drill the door for thru bolts and saving installation time and labor. It also leaves the corridor side of the frame free of fasteners for added security and a cleaner, more aesthetic appearance.
- DOOR THICKNESS:** For 1 3/4" (44mm) Wood or Metal Doors.
- GLAZING:** Should be 1/4" (6mm) or 3/16" (5mm) fire and/or safety rated with U.L. and/or W.H.I. classification markings. Glazing space of 3/8" (10mm) allows for glazing tape to be used on both sides of the glass.
- AESTHETICS:** Tight mitered corners, beveled glass stop for a clean tapered look.
- IMPORTANT:** Interpretation of building and fire codes may vary. Consult with the local authority having jurisdiction in your area, to determine appropriate standards.
- NOTE:** For Exterior use, High Humidity or Salt Air application, product must be Galvanized or Stainless Steel.
- PLEASE NOTE:** On visible lite sizes larger than 1296 sq. in. (0.836m²) on 20/45 min. and 100 sq. in. (0.065m²) on 60/90/180 min., please consult with your Door / Frame Manufacturer's procedures, for their maximum glass size tested.

OPTIONAL FEATURES

- MATERIAL:** #304 or #316 Stainless Steel, #4 Finish(Satin), Galvanized (Coil, Hot Dipped, or Zinc Plated).
- FINISH:** Custom Baked Enamel Colors (as per sample chip supplied). Plated Finishes to match the lock, hinges and closer.
- FASTENERS:** Special Security Screw Fasteners, See Page 36, this section.
- SPECIALS:** Fractional Sizes, Lead Lined for X-ray applications, Glass or Door thickness (see FGS-IS or LoPro-IS).
- HM CLIP:** Replaces the need for reinforcing channel in the door cutout, see page 37 this section.

FIRE RATINGS (w/ U.L. & W.H.I. classification markings) Positive Pressure

- 20 MINUTE:*** Approved listing at 3204 sq.in. (2.067 m²) visible lite max. width 36" (914mm), max. height 89" (2261mm).
- 45/60 MINUTE:*** Approved listing at 2772 sq.in. (1.788 m²) visible lite max. width 36" (914mm), max. height 77"(1956mm).
- 90 MINUTE:*** Approved listing at 1296 sq.in. (0.836 m²) visible lite max. width 36" (914mm) , max. height 54" (1372mm).
- 3 Hour:*** Approved listing at 100 sq.in. (0.065 m²) visible lite max. width 12" (305mm), max. height 33" (838mm)

* Must be used with FIRELITE Plus or NT and Fire listed glazing tape or another manufacturer's equivalent product. Glazing combination must be used in appropriately tested door assembly.

BS 476.22 Timber Doors - 30 min. and 1 hour.
British Standard Steel Doors - 2 hours (4 hours actual).

Job Name & Location	Submitted by



TECHNICAL DATA
FROM
Anemostat[®]
DOOR PRODUCTS
A MESTEK COMPANY

1220 E WATSON CENTER RD
CARSON, CA 90745-4206
(310) 835-7500 • FAX (310) 835-0448

e-mail: door@anemostat.com • website: www.anemostat.com

BFL-75

METAL
VISION FRAME



UNDERWRITERS'
LABORATORIES

FIRE
RATINGS



WARNOCK
HERSEY

B.S.-476.22
British Standard

DETAIL DRAWING

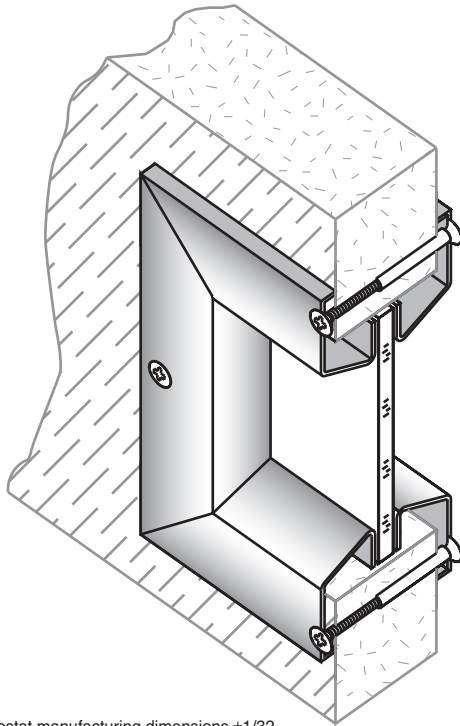

Anemostat manufacturing dimensions ±1/32
Actual dimensions are nominal and may vary
based on component manufacturers tolerances.

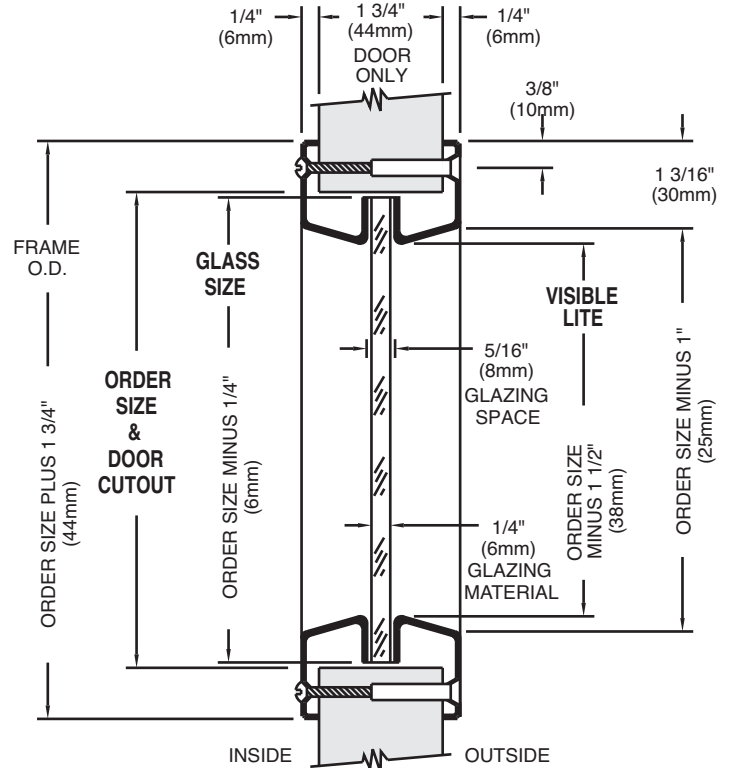

STANDARD PRODUCT FEATURES

- **MATERIAL:** 18 GA. (1.25mm) Cold Rolled Steel.
- **FINISH:** Grey Primer, Beige or Bronze Baked Enamel.
- **INSTALLATION:** By drilling 1/4" (6mm) holes thru the door, around the perimeter of the door cutout. Frame has countersunk mounting holes for #8x32 phillips head steel thru bolts with a blank head on one side for flush appearance.
- **DOOR THICKNESS:** For 1 3/4" (44mm) Wood or Metal Doors.
- **GLAZING:** Should be 1/4" (6mm) or 3/16" (5mm) fire and/or safety rated with U.L. and/or W.H.I. classification markings. Glazing space of 5/16" (8mm) allows for glazing tape to be used on both sides of the glass.
- **AESTHETICS:** Tight mitered corners, beveled glass stop for a clean tapered look.
- **IMPORTANT:** Interpretation of building and fire codes may vary. Consult with the local authority having jurisdiction in your area, to determine appropriate standards.
- **NOTE:** For Exterior use, High Humidity or Salt Air application, product must be Galvanized or Stainless Steel.
- **PLEASE NOTE:** On visible lite sizes larger than 1296 sq. in. (0.836m²) on 20/45 min. and 100 sq. in. (0.065m²) on 60/90/180 min., please consult with your Door / Frame Manufacturer's procedures, for their maximum glass size tested.

OPTIONAL FEATURES

- **MATERIAL:** #304 or #316 Stainless Steel, #4 Finish(Satin), Galvanized (Coil, Hot Dipped, or Zinc Plated).
- **FINISH:** Custom Baked Enamel Colors (as per sample chip supplied). Plated Finishes to match the lock, hinges and closer.
- **FASTENERS:** Special Security Screw Fasteners, See Page 36, this section.
- **SPECIALS:** Fractional Sizes, Lead Lined for X-ray applications, Glass or Door thickness (see FGS-IS or LoPro-IS).
- **HM CLIP:** Replaces the need for reinforcing channel in the door cutout, see page 37 this section.

FIRE RATINGS (w/ U.L. & W.H.I. classification markings) Positive Pressure

- **20 MINUTE:*** Approved listing at 3204 sq.in. (2.067 m²) visible lite max. width 36" (914mm), max. height 89" (2261mm).
 - **45/60 MINUTE:*** Approved listing at 2772 sq.in. (1.788 m²) visible lite max. width 36" (914mm), max. height 77" (1956mm).
 - **90 MINUTE:*** Approved listing at 1296 sq.in. (0.836 m²) visible lite max. width 36" (914mm), max. height 54" (1372mm).
 - **3 Hour:*** Approved listing at 100 sq.in. (0.065 m²) visible lite max. width 12" (305mm), max. height 33" (838mm)
- * Must be used with FIRELITE Plus or NT and Fire listed glazing tape or another manufacturer's equivalent product. Glazing combination must be used in appropriately tested door assembly.

Job Name & Location	Submitted by



TECHNICAL DATA
FROM
Anemostat[®]
DOOR PRODUCTS
A MESTEK COMPANY

1220 E WATSON CENTER RD
CARSON, CA 90745-4206
(310) 835-7500 • FAX (310) 835-0448

e-mail: door@anemostat.com • website: www.anemostat.com

BFL-75-PO
POST OFFICE OBSERVATION
METAL
VISION FRAME

NOT FIRE RATED

DETAIL DRAWING

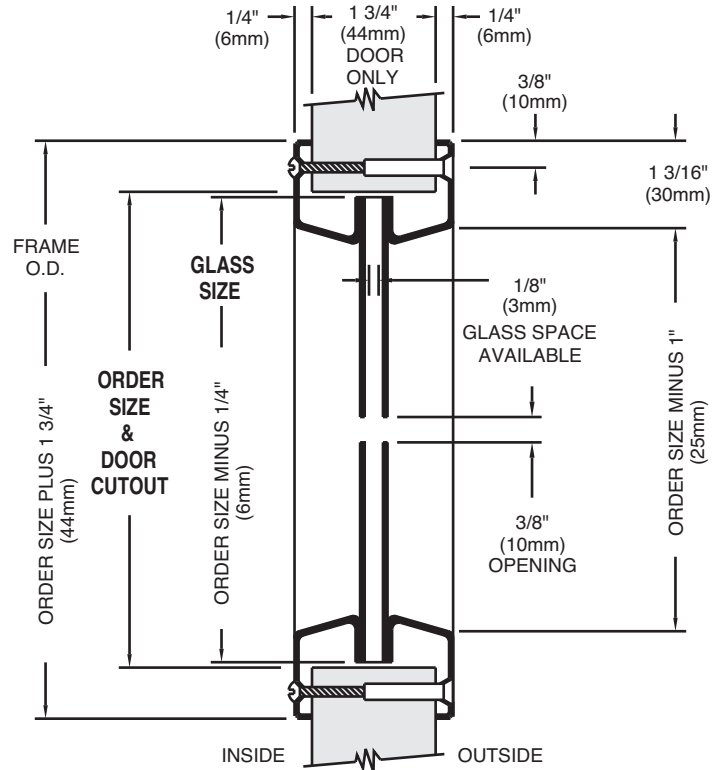
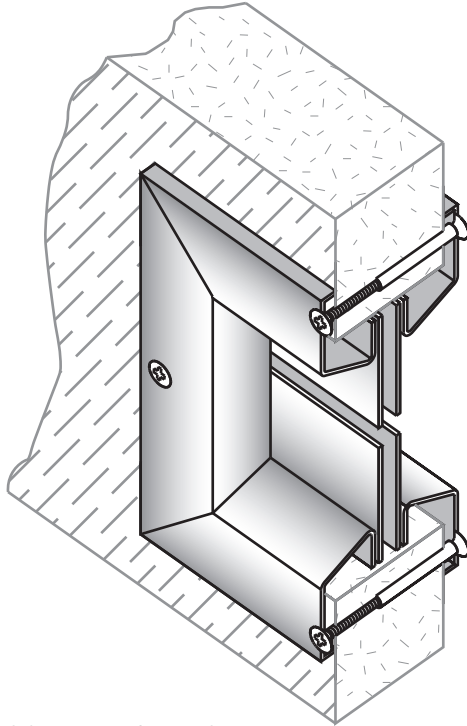

12 X 6 IS STANDARD ORDER SIZE
OTHER SIZES AVAILABLE, CONSULT FACTORY

Anemostat manufacturing dimensions $\pm 1/32$
Actual dimensions are nominal and may vary
based on component manufacturers tolerances.

STANDARD PRODUCT FEATURES

- **MATERIAL:** 18 GA. (1.25mm) Cold Rolled Steel.
- **FINISH:** Grey Primer, Beige or Bronze Baked Enamel.
- **INSTALLATION:** By drilling 1/4" (6mm) holes thru the door, around the perimeter of the door cutout. Frame has countersunk mounting holes for #8x32 phillips head steel thru bolts with a blank head on one side for flush appearance.
- **DOOR THICKNESS:** For 1 3/4" (44mm) Wood or Metal Doors.
- **GLAZING SPACE:** Space allows for 1/8" (3mm) thick glazing material. Can also be used without Glazing Material. For a thicker glazing space, consult factory about FGS-IS-PO.
- **AESTHETICS:** Tight mitered corners, beveled glass stop for a clean tapered look.
- **NOTE:** For Exterior use, High Humidity or Salt Air application, product must be Galvanized or Stainless Steel.

OPTIONAL FEATURES

- **MATERIAL:** #304 or #316 Stainless Steel, #4 Finish (Satin), Galvanized (Coil, Hot Dipped, or Zinc Plated).
- **FINISH:** Custom Baked Enamel Colors (as per sample chip supplied). Plated Finishes to match the lock, hinges and closer.
- **FASTENERS:** Special Security Screw Fasteners, See Page 36, this section.
- **SPECIALS:** Fractional Sizes, Glass or Door thickness (consult factory for FGS-IS-PO).

FIRE RATINGS

- BFL-75-PO is not fire rated.

IMPORTANT: Interpretation of building and fire codes may vary. Consult with the local authority having jurisdiction in your area, to determine appropriate standards.

FOR SPECIAL GLASS OR DOOR THICKNESS
USE FGS-IS-PO (CONSULT FACTORY)

Job Name & Location	Submitted by



TECHNICAL DATA
FROM
Anemostat[®]
DOOR PRODUCTS
A MESTEK COMPANY

1220 E WATSON CENTER RD
CARSON, CA 90745-4206

(310) 835-7500 • FAX (310) 835-0448

e-mail: door@anemostat.com • website: www.anemostat.com

LoPro[™]
LEAD LINED
METAL VISION FRAME

NOT FIRE RATED

DETAIL DRAWING

2# LEAD LINING
(1/32"/0.79mm)
*Non-Screw Hole Side Only
is Lead Lined*

4# LEAD LINING - Total
(1/32"/0.79mm)
*Both Sides are
Lead Lined with 2# Lead*

X-RAY-S
X-RAY & SAFETY
RATED GLASS
5/16" (8mm) THICK

1/32"
(0.79mm)
(TYP.)

For Complete Technical Data

- **LoPro**
see page 1, this section
- **X-Ray-S Glass**
see Glazing Products page 17

Job Name & Location	Submitted by



TECHNICAL DATA
FROM
Anemostat[®]
DOOR PRODUCTS
A MESTEK COMPANY

1220 E WATSON CENTER RD
CARSON, CA 90745-4206
(310) 835-7500 • FAX (310) 835-0448

e-mail: door@anemostat.com • website: www.anemostat.com

FGS-MS5-FR

LEAD LINED / FIRE RATED

METAL VISION FRAME
IMPACT AND SECURITY RESISTANT



UNDERWRITERS'
LABORATORIES

FIRE
RATINGS



WARNOCK
HERSEY

B.S.-476.22 British Standard

DETAIL DRAWING

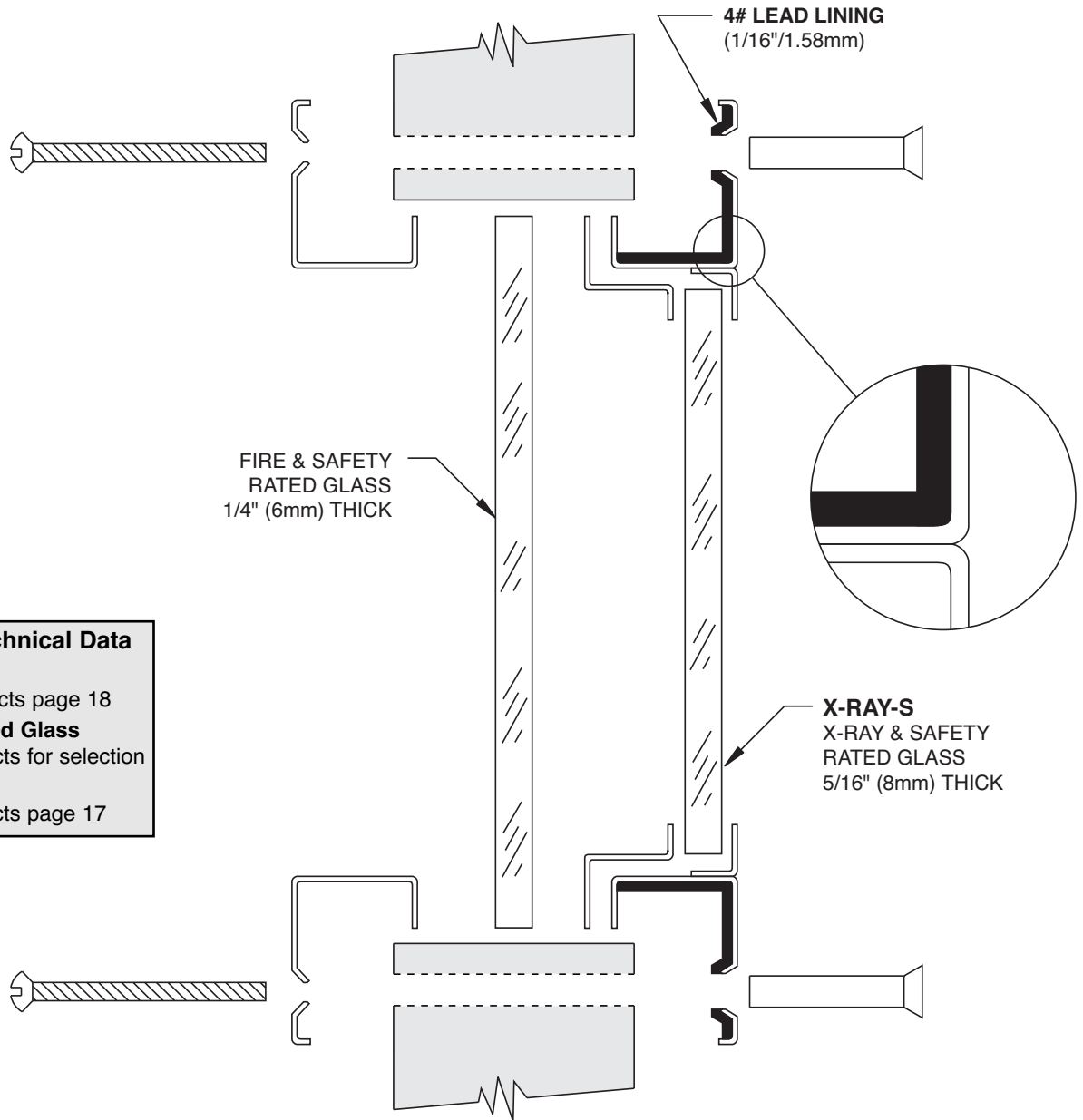

For Complete Technical Data

- **FGS-MS**
see Security Products page 18
- **Fire & Safety Rated Glass**
see Glazing Products for selection
- **X-Ray-S Glass**
see Glazing Products page 17

Job Name & Location	Submitted by



TECHNICAL DATA

FROM

Anemostat®

DOOR PRODUCTS

A MESTEK COMPANY

1220 E WATSON CENTER RD
CARSON, CA 90745-4206
(310) 835-7500 • FAX (310) 835-0448

e-mail: door@anemostat.com • website: www.anemostat.com

Lo-FP-12

Lo-FP-12-IS

12" (305mm) ROUND
LO-PROFILE METAL VISION FRAME



UNDERWRITERS'
LABORATORIES

EN-1634

European Standard

FIRE RATINGS



WARNOCK
HERSEY

B.S.-476.22

British Standard

DETAIL DRAWING

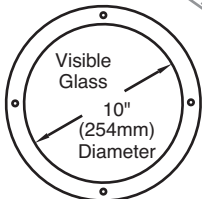
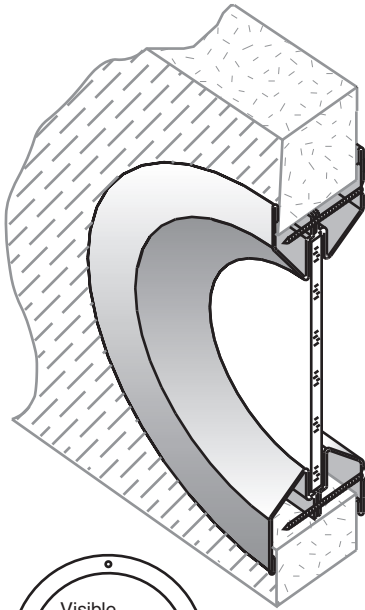

4 mounting holes per vision frame

Anemostat manufacturing dimensions $\pm 1/32$ (1mm)
Actual dimensions are nominal and may vary
based on component manufacturers tolerances.

Lo-FP-12-AB1

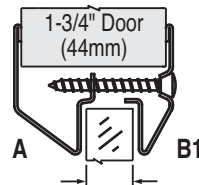

GLAZING THICKNESS 5/8" to 11/16" (16mm to 17mm)
GLAZING SPACE 3/4" (19mm)

Lo-FP-12-BB1

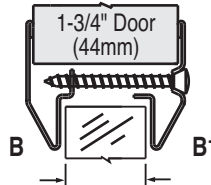

GLAZING THICKNESS 7/8" to 1" (22mm to 25mm)
GLAZING SPACE 1 1/16" (27mm)

A, B = Non Screw Side of Frame
A1, B1 = Screw Side of Frame

Lo-FP-12-AA1

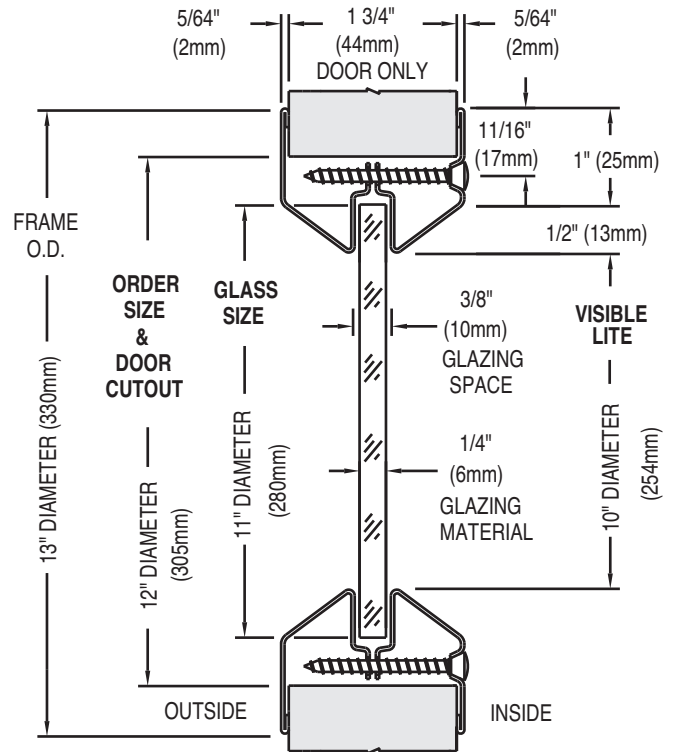

STANDARD PRODUCT FEATURES

- MATERIAL:** 20 GA. (1mm) Cold Rolled Steel.
- FINISH:** Grey Primer, Beige or Bronze Baked Enamel.
- INSTALLATION:** Uses #8 x 1 3/4" (44mm) long phillips oval head screws that pass through the door cutout and fasten to the opposite side of the vision frame, eliminating the need for thru bolts.
- DOOR THICKNESS:** For 1 3/4" (44mm) Wood or Metal Doors.
- GLAZING:** Should be 1/4" (6mm) , 3/16" (5mm) or 5/16" (8mm) fire and/or safety rated with U.L. and/or W.H.I. classification markings. Glazing space of 3/8" (10mm) allows for glazing tape to be used on both sides of the glass. See drawing above for details on other glass thicknesses available.
- AESTHETICS:** Smooth round contour of low profile frame style gives a unique design to any setting.
- IMPORTANT:** Interpretation of building and fire codes may vary. Consult with the local authority having jurisdiction in your area, to determine appropriate standards.
- NOTE:** For Exterior use, High Humidity or Salt Air application, product must be Galvanized steel.

OPTIONAL FEATURES

- MATERIAL:** #304 or #316 Stainless Steel, #4 Finish(Satin), Galvanized (Hot Dipped, or Zinc Plated),
- FINISH:** Custom Baked Enamel Colors (as per sample chip supplied). Plated Finishes to match the lock, hinges and closer.
- FASTENERS:** Special Security Screw Fasteners, See Page 36, this section.
- SPECIALS:** Consult Factory for special diameter sizes and other special glass or door thickness.

FIRE RATINGS (w/ U.L. & W.H.I. classification markings) Positive Pressure

- 20/45/60/90/180 MINUTE:** Approved listing at 79 sq.in. (0.051 m²) visible lite.
 - 3 Hour:** * Approved listing at 79 sq.in. (0.051 m²) visible lite
- * Must be used with FIRELITE Plus or NT and Fire listed glazing tape or another manufacturer's equivalent product. Glazing combination must be used in appropriately tested door assembly.

BS 476.22 British Standard
Timber Doors - 30 min. and 1 hour.
Steel Doors - 2 hours (4 hours actual).

EN-1634 European Std.
30/60 min. integrity and insulation - Indicative Testing

Job Name & Location	Submitted by



TECHNICAL DATA

FROM

Anemostat®

DOOR PRODUCTS

A MESTEK COMPANY

1220 E WATSON CENTER RD
CARSON, CA 90745-4206
(310) 835-7500 • FAX (310) 835-0448

e-mail: door@anemostat.com • website: www.anemostat.com

Lo-FP-18

Lo-FP-18-IS

18" (457mm) ROUND
LO-PROFILE METAL VISION FRAME



UNDERWRITERS'
LABORATORIES

EN-1634

European Standard

FIRE RATINGS



WARNOCK
HERSEY

B.S.-476.22

British Standard

DETAIL DRAWING

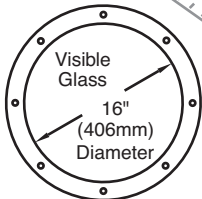
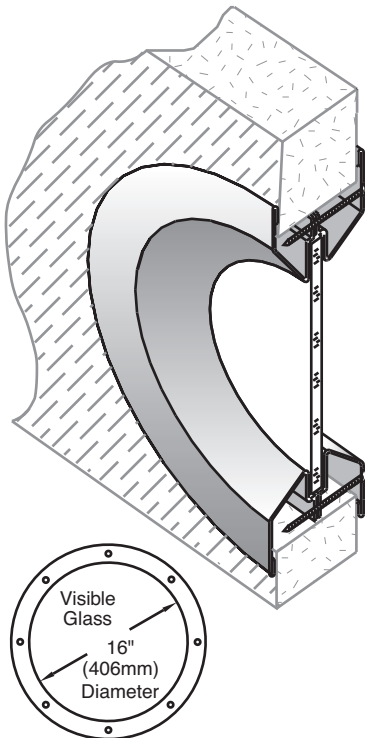

8 mounting holes per vision frame

Anemostat manufacturing dimensions $\pm 1/32$ (1mm)
Actual dimensions are nominal and may vary
based on component manufacturers tolerances.

Lo-FP-18-AB1

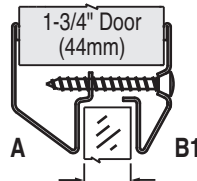

GLAZING THICKNESS 5/8" to 11/16" (16mm to 17mm)
GLAZING SPACE 3/4" (19mm)

Lo-FP-18-BB1

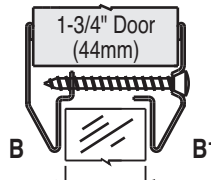

GLAZING THICKNESS 7/8" to 1" (22mm to 25mm)
GLAZING SPACE 1 1/16" (27mm)

A, B = Non Screw Side of Frame
A1, B1 = Screw Side of Frame

Lo-FP-18-AA1

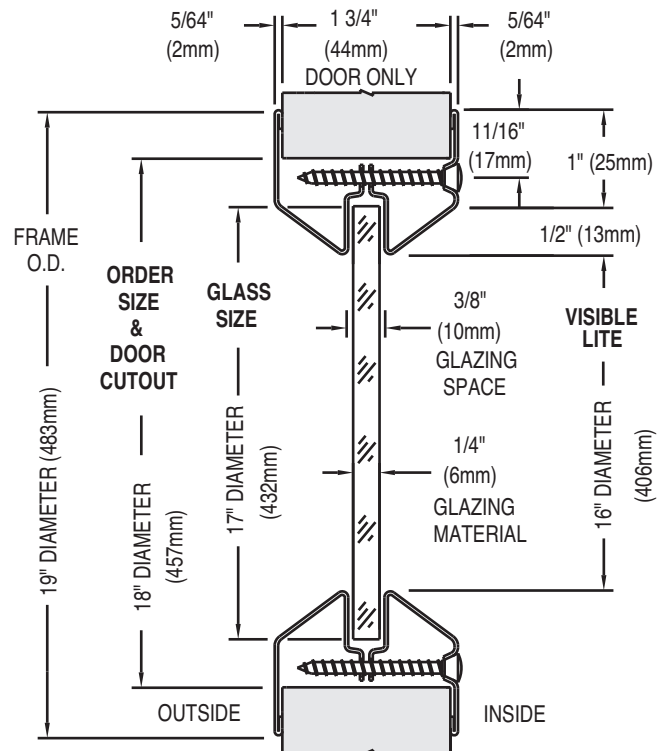

STANDARD PRODUCT FEATURES

- MATERIAL:** 20 GA. (1mm) Cold Rolled Steel.
- FINISH:** Grey Primer, Beige or Bronze Baked Enamel.
- INSTALLATION:** Uses #8 x 1 3/4" (44mm) long phillips oval head screws that pass through the door cutout and fasten to the opposite side of the vision frame, eliminating the need for thru bolts.
- DOOR THICKNESS:** For 1 3/4" (44mm) Wood or Metal Doors.
- GLAZING:** Should be 1/4" (6mm), 3/16" (5mm) or 5/16" (8mm) fire and/or safety rated with U.L. and/or W.H.I. classification markings. Glazing space of 3/8" (10mm) allows for glazing tape to be used on both sides of the glass. See drawing above for details on other glass thicknesses available.
- AESTHETICS:** Smooth round contour of low profile frame style gives a unique design to any setting.
- IMPORTANT:** Interpretation of building and fire codes may vary. Consult with the local authority having jurisdiction in your area, to determine appropriate standards.
- NOTE:** For Exterior use, High Humidity or Salt Air application, product must be Galvanized steel.

OPTIONAL FEATURES

- MATERIAL:** #304 or #316 Stainless Steel, #4 Finish (Satin), Galvanized (Hot Dipped, or Zinc Plated).
- FINISH:** Custom Baked Enamel Colors (as per sample chip supplied). Plated Finishes to match the lock, hinges and closer.
- FASTENERS:** Special Security Screw Fasteners, See Page 36, this section.
- SPECIALS:** Consult Factory for special diameter sizes and other special glass or door thickness.

FIRE RATINGS (w/ U.L. & W.H.I. classification markings) Positive Pressure

- 20/45/60*90* MINUTE:** Approved listing at 201 sq.in. (0.13 m²) visible lite.
- * Must be used with FIRELITE Plus or NT and Fire listed glazing tape or another manufacturer's equivalent product. Glazing combination must be used in appropriately tested door assembly.

BS 476.22 Timber Doors - 30 min. and 1 hour.
British Standard Steel Doors - 2 hours (4 hours actual).

EN-1634 30/60 min. integrity and insulation - Indicative Testing
European Std.

- PLEASE NOTE:** On visible lite sizes larger than 1296 sq. in. (0.836 m²) on 20/45 min. and 100 sq. in. (0.065 m²) on 60/90/180 min., please consult with your Door / Frame Manufacturer's procedures, for their maximum glass size tested.

Job Name & Location	Submitted by



TECHNICAL DATA
FROM
Anemostat[®]
DOOR PRODUCTS
A MESTEK COMPANY

1220 E WATSON CENTER RD
CARSON, CA 90745-4206
(310) 835-7500 • FAX (310) 835-0448

e-mail: door@anemostat.com • website: www.anemostat.com

Lo-FP-24

24" ROUND

LO-PROFILE METAL VISION FRAME



UNDERWRITERS'
LABORATORIES

EN-1634

European Standard

FIRE RATINGS



WARNOCK
HERSEY

B.S.-476.22

British Standard

DETAIL DRAWING

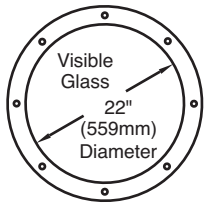
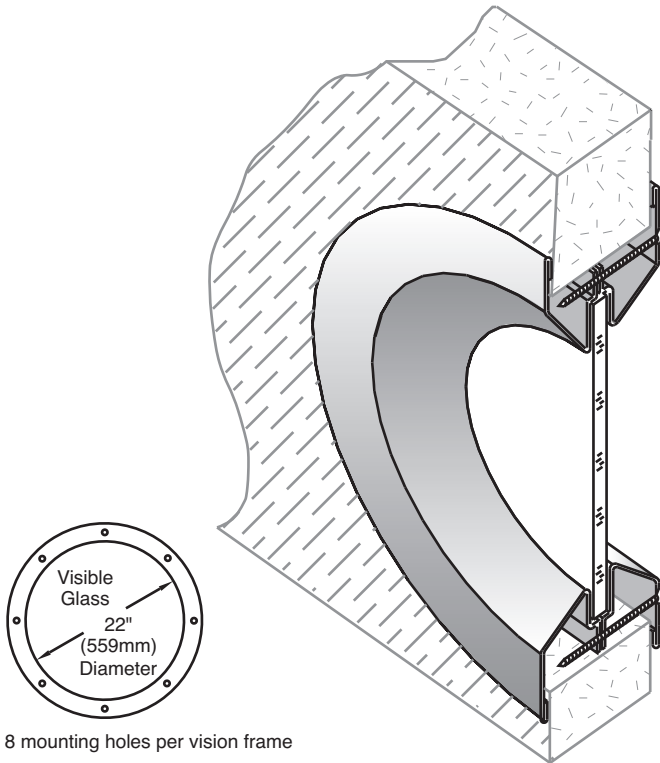

8 mounting holes per vision frame

Anemostat manufacturing dimensions $\pm 1/32$
Actual dimensions are nominal and may vary
based on component manufacturers tolerances.

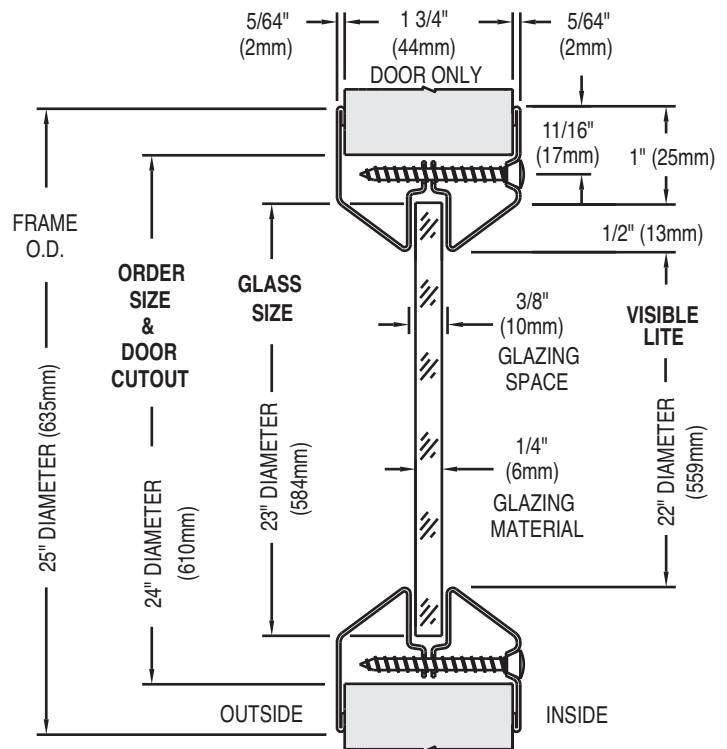

STANDARD PRODUCT FEATURES

- MATERIAL:** 20 GA. (1mm) Cold Rolled Steel.
- FINISH:** Grey Primer, Beige or Bronze Baked Enamel.
- INSTALLATION:** Uses #8 x 1 3/4" (44mm) long phillips oval head screws that pass through the door cutout and fasten to the opposite side of the vision frame, eliminating the need for thru bolts.
- DOOR THICKNESS:** For 1 3/4" (44mm) Wood or Metal Doors.
- GLAZING:** Should be 1/4" (6mm), 3/16" (5mm) or 5/16" (8mm) fire and/or safety rated with U.L. and/or W.H.I. classification markings. Glazing space of 3/8" (10mm) allows for glazing tape to be used on both sides of the glass.
- AESTHETICS:** Smooth round contour of low profile frame style gives a unique design to any setting.
- IMPORTANT:** Interpretation of building and fire codes may vary. Consult with the local authority having jurisdiction in your area, to determine appropriate standards.
- NOTE:** For Exterior use, High Humidity or Salt Air application, product must be Galvanized steel.
- PLEASE NOTE:** On visible lite sizes larger than 1296 sq. in. (0.836 m²) on 20/45 min. and 100 sq. in. (0.065 m²) on 60/90/180 min., please consult with your Door / Frame Manufacturer's procedures, for their maximum glass size tested.

OPTIONAL FEATURES

- MATERIAL:** #304 or #316 Stainless Steel, #4 Finish(Satin), Galvanized (Hot Dipped, or Zinc Plated).
- FINISH:** Custom Baked Enamel Colors (as per sample chip supplied). Plated Finishes to match the lock, hinges and closer.
- FASTENERS:** Special Security Screw Fasteners, See Page 36, this section.
- SPECIALS:** Consult Factory for special diameter sizes and special glass or door thickness.

FIRE RATINGS (w/ U.L. & W.H.I. classification markings) Positive Pressure

- 20/45/60*90*** MINUTE: Approved listing at 380 sq.in. (0.25m²) visible lite.
- * Must be used with FIRELITE Plus or NT and Fire listed glazing tape or another manufacturer's equivalent product. Glazing combination must be used in appropriately tested door assembly.

BS 476.22 British Standard Timber Doors - 30 min. and 1 hour.
Steel Doors - 2 hours (4 hours actual).

EN-1634 European Std. 30/60 min. integrity and insulation - Indicative Testing

Job Name & Location	Submitted by



TECHNICAL DATA
FROM
Anemostat[®]
DOOR PRODUCTS
A MESTEK COMPANY

1220 E WATSON CENTER RD
CARSON, CA 90745-4206
(310) 835-7500 • FAX (310) 835-0448

e-mail: door@anemostat.com • website: www.anemostat.com

FP-12

12" ROUND
METAL VISION FRAME



UNDERWRITERS'
LABORATORIES

FIRE
RATINGS



WARNOCK
HERSEY

B.S.-476.22
British Standard

DETAIL DRAWING

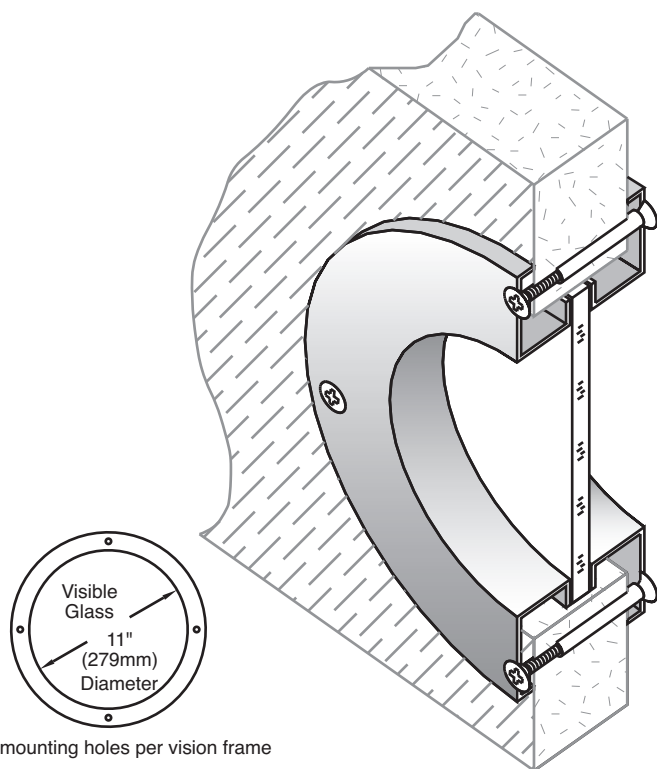

4 mounting holes per vision frame

Anemostat manufacturing dimensions ±1/32
Actual dimensions are nominal and may vary
based on component manufacturers tolerances.

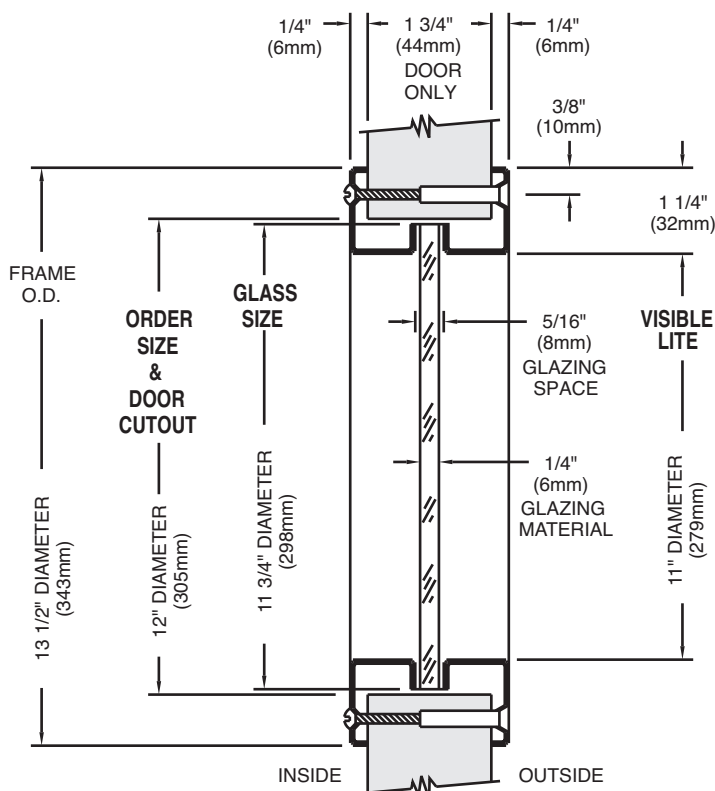

STANDARD PRODUCT FEATURES

- **MATERIAL:** 18 GA. (1.25mm) Cold Rolled Steel.
- **FINISH:** Grey Primer, Beige or Bronze Baked Enamel.
- **INSTALLATION:** By drilling 1/4" (6mm) holes thru the door, around the perimeter of the door cutout. Frame has countersunk mounting holes for #8x32 phillips head steel thru bolts with a blank head on one side for flush appearance.
- **DOOR THICKNESS:** For 1 3/4" (44mm) Wood and Metal Doors.
- **GLAZING:** Should be 1/4" (6mm) or 3/16" (5mm) fire and/or safety rated with U.L. and/or W.H.I. classification markings. Glazing space of 5/16" (8mm) allows for glazing tape to be used on both sides of the glass.
- **AESTHETICS:** Smooth round contour of frame style gives a unique design to any setting.
- **NOTE:** For Exterior use, High Humidity or Salt Air application, product must be Galvanized or Stainless Steel.

OPTIONAL FEATURES

- **MATERIAL:** #304 or #316 Stainless Steel, #4 Finish(Satin), Galvanized (Hot Dipped, or Zinc Plated).
- **FINISH:** Custom Baked Enamel Colors (as per sample chip supplied). Plated Finishes to match the lock, hinges and closer.
- **FASTENERS:** Special Security Screw Fasteners, See Page 36, this section.
- **SPECIALS:** Consult Factory for special diameter sizes and special glass or door thicknesses.

FIRE RATINGS (w/ U.L. & W.H.I. classification markings) Positive Pressure

- **20/45/60*90* MINUTE:** Approved listing at 79 sq.in. (0.051m²) visible lite.
- * Must be used with FIRELITE Plus or NT and Fire listed glazing tape or another manufacturer's equivalent product. Glazing combination must be used in appropriately tested door assembly.
- **IMPORTANT:** Interpretation of building and fire codes may vary. Consult with the local authority having jurisdiction in your area, to determine appropriate standards.

BS 476.22 Timber Doors - 30 min. and 1 hour.
British Standard Steel Doors - 2 hours (4 hours actual).

Job Name & Location	Submitted by



TECHNICAL DATA
FROM
Anemostat[®]
DOOR PRODUCTS
A MESTEK COMPANY

1220 E WATSON CENTER RD
CARSON, CA 90745-4206
(310) 835-7500 • FAX (310) 835-0448

e-mail: door@anemostat.com • website: www.anemostat.com

FP-18

18" ROUND
METAL VISION FRAME



UNDERWRITERS'
LABORATORIES

FIRE
RATINGS



WARNOCK
HERSEY

B.S.-476.22
British Standard

DETAIL DRAWING

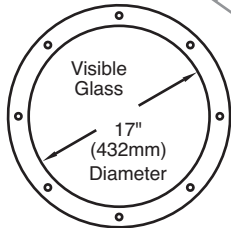
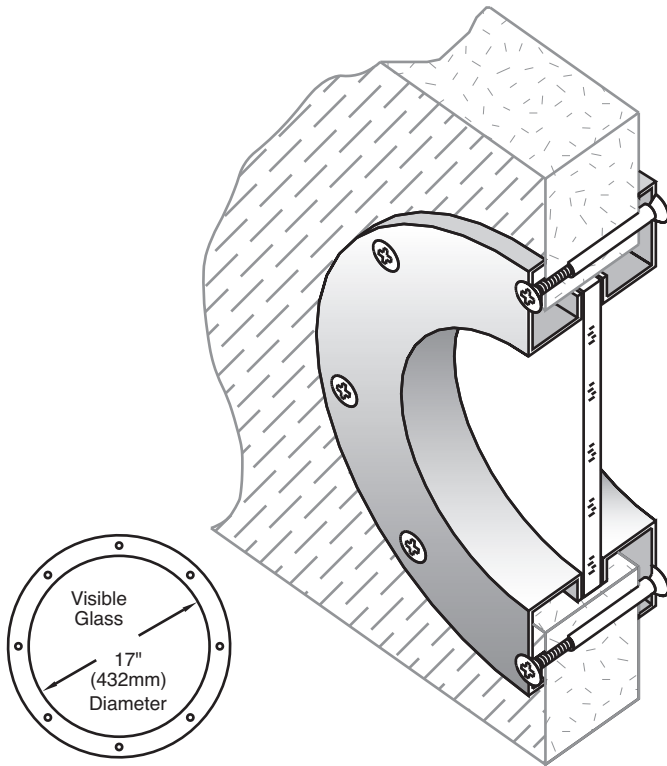

8 mounting holes per vision frame

Anemostat manufacturing dimensions ±1/32
Actual dimensions are nominal and may vary
based on component manufacturers tolerances.

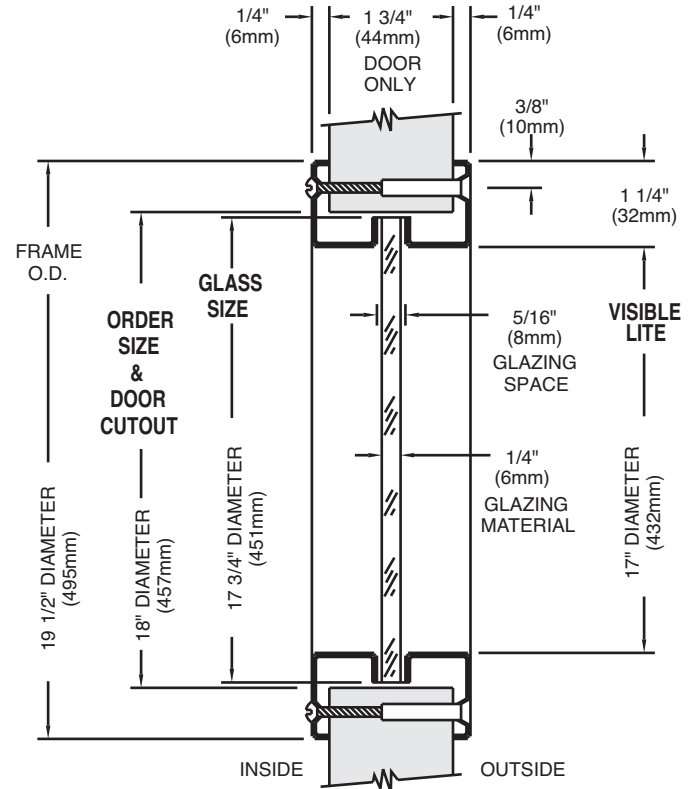

STANDARD PRODUCT FEATURES

- **MATERIAL:** 18 GA. (1.25mm) Cold Rolled Steel.
- **FINISH:** Grey Primer, Beige or Bronze Baked Enamel.
- **INSTALLATION:** By drilling 1/4" (6mm) holes thru the door, around the perimeter of the door cutout. Frame has countersunk mounting holes for #8x32 phillips head steel thru bolts with a blank head on one side for flush appearance.
- **DOOR THICKNESS:** For 1 3/4" (44mm) Wood or Metal Doors.
- **GLAZING:** Should be 1/4" (6mm) or 3/16" (5mm) fire and/or safety rated with U.L. and/or W.H.I. classification markings. Glazing space of 5/16" (8mm) allows for glazing tape to be used on both sides of the glass.
- **AESTHETICS:** Smooth round contour of frame style gives a unique design to any setting.
- **NOTE:** For Exterior use, High Humidity or Salt Air application, product must be Galvanized or Stainless Steel.
- **PLEASE NOTE:** On visible lite sizes larger than 1296 sq. in. (0.836 m²) on 20/45 min. and 100 sq. in. (0.065 m²) on 60/90/180 min., please consult with your Door / Frame Manufacturer's procedures, for their maximum glass size tested.

OPTIONAL FEATURES

- **MATERIAL:** #304 or #316 Stainless Steel, #4 Finish(Satin), Galvanized (Hot Dipped, or Zinc Plated).
- **FINISH:** Custom Baked Enamel Colors (as per sample chip supplied). Plated Finishes to match the lock, hinges and closer.
- **FASTENERS:** Special Security Screw Fasteners, See Page 36, this section.
- **SPECIALS:** Consult Factory for special diameter sizes and special glass or door thicknesses.

FIRE RATINGS (w/ U.L. & W.H.I. classification markings) Positive Pressure

- **20/45/60*/90* MINUTE:** Approved listing at 201 sq.in. (0.13m²) visible lite.
- * Must be used with FIRELITE Plus or NT and Fire listed glazing tape or another manufacturer's equivalent product. Glazing combination must be used in appropriately tested door assembly.
- **IMPORTANT:** Interpretation of building and fire codes may vary. Consult with the local authority having jurisdiction in your area, to determine appropriate standards.

BS 476.22 British Standard
Timber Doors - 30 min. and 1 hour.
Steel Doors - 2 hours (4 hours actual).

Job Name & Location	Submitted by



TECHNICAL DATA
FROM
Anemostat[®]
DOOR PRODUCTS
A MESTEK COMPANY

1220 E WATSON CENTER RD
CARSON, CA 90745-4206
(310) 835-7500 • FAX (310) 835-0448

e-mail: door@anemostat.com • website: www.anemostat.com

FP-24

24" ROUND
METAL VISION FRAME



UNDERWRITERS'
LABORATORIES

FIRE
RATINGS



WARNOCK
HERSEY

B.S.-476.22
British Standard

DETAIL DRAWING

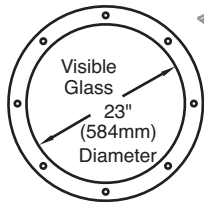
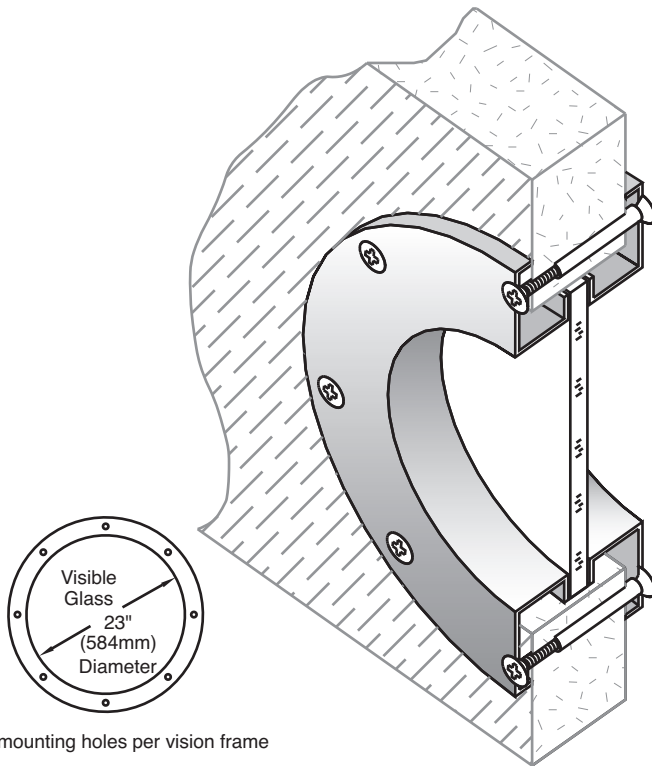

8 mounting holes per vision frame

Anemostat manufacturing dimensions ±1/32
Actual dimensions are nominal and may vary
based on component manufacturers tolerances.

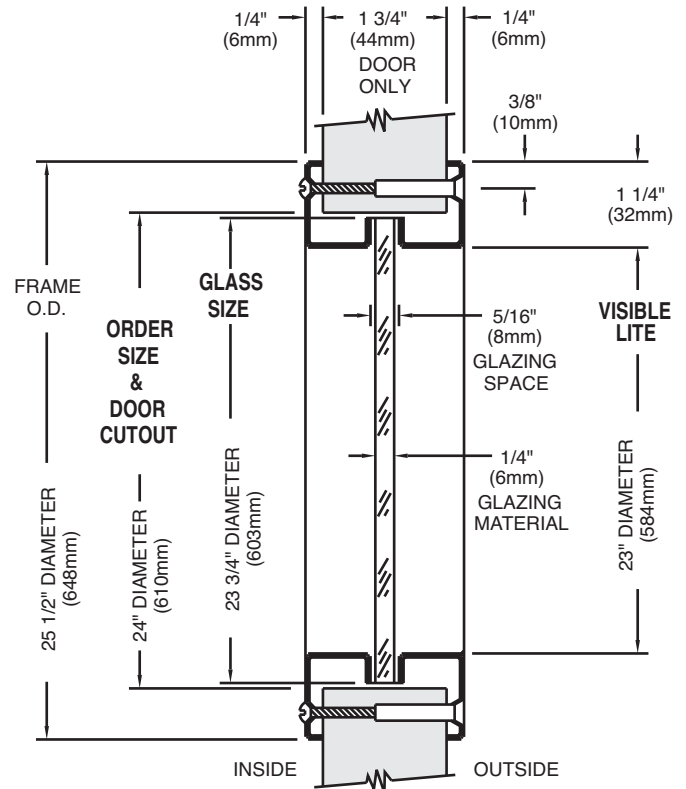

STANDARD PRODUCT FEATURES

- **MATERIAL:** 18 GA. (1.25mm) Cold Rolled Steel.
- **FINISH:** Grey Primer, Beige or Bronze Baked Enamel.
- **INSTALLATION:** By drilling 1/4" (6mm) holes thru the door, around the perimeter of the door cutout. Frame has countersunk mounting holes for #8x32 phillips head steel thru bolts with a blank head on one side for flush appearance.
- **DOOR THICKNESS:** For 1 3/4" (44mm) Wood or Metal Doors.
- **GLAZING:** Should be 1/4" (6mm) or 3/16" (5mm) fire and/or safety rated with U.L. and/or W.H.I. classification markings. Glazing space of 5/16" (8mm) allows for glazing tape to be used on both sides of the glass.
- **AESTHETICS:** Smooth round contour of frame style gives a unique design to any setting.
- **NOTE:** For Exterior use, High Humidity or Salt Air application, product must be Galvanized or Stainless Steel.
- **PLEASE NOTE:** On visible lite sizes larger than 1296 sq. in. (0.836 m²) on 20/45 min. and 100 sq. in. (0.065 m²) on 60/90/180 min., please consult with your Door / Frame Manufacturer's procedures, for their maximum glass size tested.

OPTIONAL FEATURES

- **MATERIAL:** #304 or #316 Stainless Steel, #4 Finish(Satin), Galvanized (Hot Dipped or Zinc Plated).
- **FINISH:** Custom Baked Enamel Colors (as per sample chip supplied). Plated Finishes to match the lock, hinges and closer.
- **FASTENERS:** Special Security Screw Fasteners, See Page 36, this section.
- **SPECIALS:** Consult Factory for special diameter sizes and special glass or door thicknesses.

FIRE RATINGS (w/ U.L. & W.H.I. classification markings) Positive Pressure

- **20/45/60*/90* MINUTE:** Approved listing at 380 sq.in. (.025m²) visible lite.
* Must be used with FIRELITE Plus or NT and Fire listed glazing tape or another manufacturer's equivalent product. Glazing combination must be used in appropriately tested door assembly.
- **IMPORTANT:** Interpretation of building and fire codes may vary. Consult with the local authority having jurisdiction in your area, to determine appropriate standards.

BS 476.22 Timber Doors - 30 min. and 1 hour.
British Standard Steel Doors - 2 hours (4 hours actual).

Job Name & Location	Submitted by



TECHNICAL DATA
FROM
Anemostat[®]
DOOR PRODUCTS
A MESTEK COMPANY

1220 E WATSON CENTER RD
CARSON, CA 90745-4206

(310) 835-7500 • FAX (310) 835-0448

e-mail: door@anemostat.com • website: www.anemostat.com

LoPro™ -CS
NON-CURVED
CUSTOM SHAPES



UNDERWRITERS'
LABORATORIES

EN-1634
European Standard

FIRE
RATINGS



WARNOCK
HERSEY

B.S.-476.22
British Standard

DETAIL DRAWING

AVAILABILITY: Non-Curved - A, B, C, D, E Profiles (see LoPro-IS Style page 2, this section)

Some examples are shown below, for other designs consult factory.

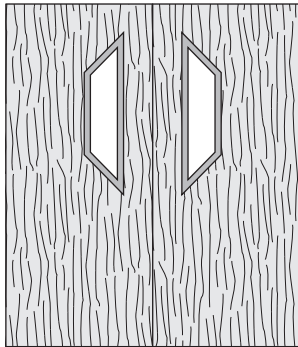

ISOSCELES TRAPEZOID



CHRISTIAN CROSS



HEXAGON

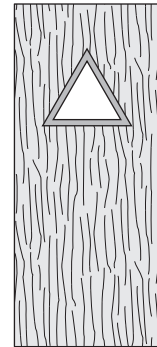

TRIANGLE
MUST SPECIFY HANDING
IF NOT EQUILATERAL

Recommendation: Do Not make Cutouts in Doors prior to receiving Custom Shaped Vision Frame

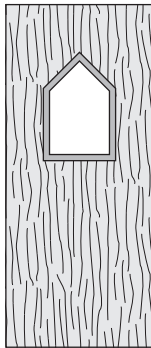

TRIANGULAR TOP

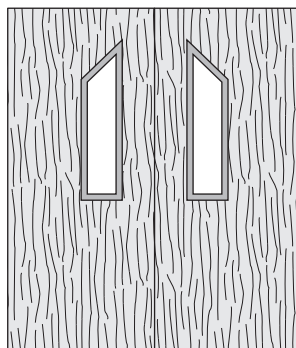

TRAPEZOID

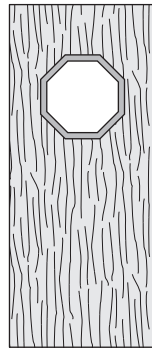

OCTAGON



KITE

* Above designs are manufactured using LoPro vision frames. For other applications or shapes Please consult factory, or submit desired design.

• **NOTE:** For Exterior use, High Humidity or Salt Air application, product must be Galvanized or Stainless Steel.

• **IMPORTANT:** Interpretation of building and fire codes may vary. Consult with the local authority having jurisdiction in your area, to determine appropriate standards.

• **PLEASE NOTE:** On visible lite sizes larger than 1296 sq. in. (0.836 m²) on 20/45 min. and 100 sq. in. (0.065 m²) on 60/90/180 min., please consult with your Door / Frame Manufacturer's procedures, for their maximum glass size tested.

FIRE RATINGS (w/ U.L. & W.H.I. classification markings) Positive Pressure

- **20 MINUTE:*** Approved listing at 3204 sq.in. (2.067 m²) visible lite max. width 36" (914mm), max. height 89" (2261mm).
- **45/60 MINUTE:*** Approved listing at 2772 sq.in. (1.788 m²) visible lite max. width 36" (914mm), max. height 77"(1956mm).
- **90 MINUTE:*** Approved listing at 1296 sq.in. (0.836 m²) visible lite max. width 36" (914mm) , max. height 54" (1372mm).
- **3 Hour:*** Approved listing at 100 sq.in. (0.065 m²) visible lite max. width 12" (305mm), max. height 33" (838mm)

* Must be used with FIRELITE Plus or NT and Fire listed glazing tape or another manufacturer's equivalent product. Glazing combination must be used in appropriately tested door assembly.

BS 476.22 British Standard Timber Doors - 30 min. and 1 hour. Tested to 254mm x 762mm
Steel Doors - 2 hours (4 hours actual). Tested to 813mm x 813mm

EN-1634 European Std. 30/60 min. integrity and insulation - Indicative Testing

Job Name & Location	Submitted by



TECHNICAL DATA
FROM
Anemostat[®]
DOOR PRODUCTS
A MESTEK COMPANY

1220 E WATSON CENTER RD
CARSON, CA 90745-4206

(310) 835-7500 • FAX (310) 835-0448

e-mail: door@anemostat.com • website: www.anemostat.com

LoPro™ -CS

CURVED
CUSTOM SHAPES



UNDERWRITERS'
LABORATORIES

EN-1634

European Standard

FIRE
RATINGS



WARNOCK
HERSEY

B.S.-476.22

British Standard

DETAIL DRAWING

**AVAILABILITY: Curved - A Profile (12, 18 & 24 Diameters)
- B Profile (12 & 18 Diameters)**

See Reference Sheets pages 30 & 31

Some examples are shown below (*based on 3-0 x 7-0 door*), for other designs consult factory.

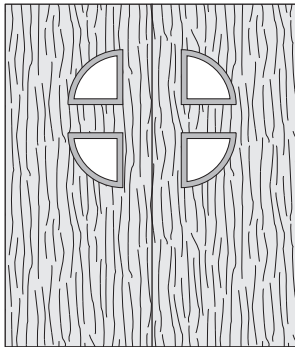

QR-12

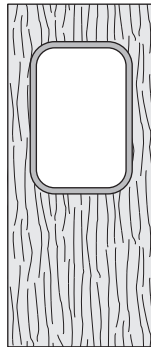

QR4C-6

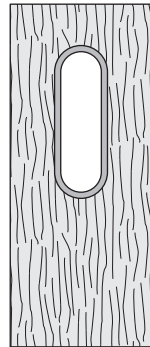

HCTB-12

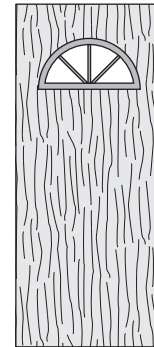

HC-24-G4

Recommendation: Do Not make Cutouts in Doors prior to receiving Custom Shaped Vision Frame

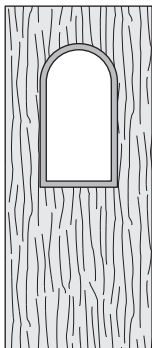

HCT-18

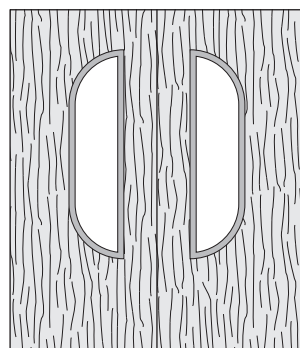

QR2C-12

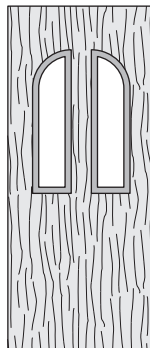

QR1C-9

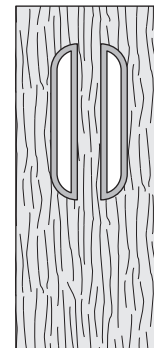

QR2C-6

* Above designs are manufactured using LoPro & LoFP-12, 18, 24 vision frames. For other applications or shapes Please consult factory, or submit desired design.

• **NOTE:** For Exterior use, High Humidity or Salt Air application, product must be Galvanized.
Curved Products NOT AVAILABLE in Stainless Steel.

• **IMPORTANT:** Interpretation of building and fire codes may vary. Consult with the local authority having jurisdiction in your area, to determine appropriate standards.

• **PLEASE NOTE:** On visible lite sizes larger than 1296 sq. in. (0.836 m²) on 20/45 min. and 100 sq. in. (0.065 m²) on 60/90/180 min., please consult with your Door / Frame Manufacturer's procedures, for their maximum glass size tested.

FIRE RATINGS (w/ U.L. & W.H.I. classification markings) Positive Pressure

- **20 MINUTE:*** Approved listing at 3204 sq.in. (2.067 m²) visible lite max. width 36" (914mm), max. height 89" (2261mm).
- **45/60 MINUTE:*** Approved listing at 2772 sq.in. (1.788 m²) visible lite max. width 36" (914mm), max. height 77"(1956mm).
- **90 MINUTE:*** Approved listing at 1296 sq.in. (0.836 m²) visible lite max. width 36" (914mm) , max. height 54" (1372mm).
- **3 Hour:*** Approved listing at 100 sq.in. (0.065 m²) visible lite max. width 12" (305mm), max. height 33" (838mm)

* Must be used with FIRELITE Plus or NT and Fire listed glazing tape or another manufacturer's equivalent product. Glazing combination must be used in appropriately tested door assembly.

BS 476.22 Timber Doors - 30 min. and 1 hour. Tested to 254mm x 762mm
British Standard Steel Doors - 2 hours (4 hours actual). Tested to 813mm x 813mm

EN-1634 30/60 min. integrity and insulation - Indicative Testing
European Std.

Job Name & Location	Submitted by



REFERENCE SHEET

FROM

Anemostat[®]

DOOR PRODUCTS

A MESTEK COMPANY

1220 E WATSON CENTER RD

CARSON, CA 90745-4206

(310) 835-7500 • FAX (310) 835-0448

e-mail: door@anemostat.com • website: www.anemostat.com

LoPro™-CS-HC

HALF CIRCLE CUSTOM SHAPES

MANUFACTURED FROM:

LOFP-12 AA1, AB1, BB1

LOFP-18 AA1, AB1, BB1

LOFP-24 AA1

DETAIL DRAWING

HC-12

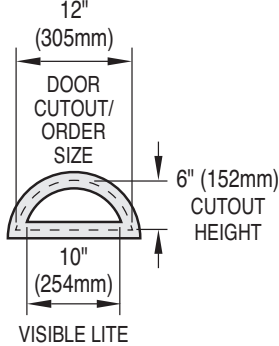

HC-18

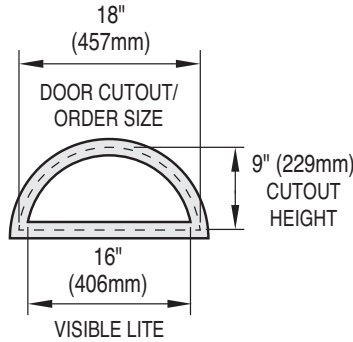

HC-24

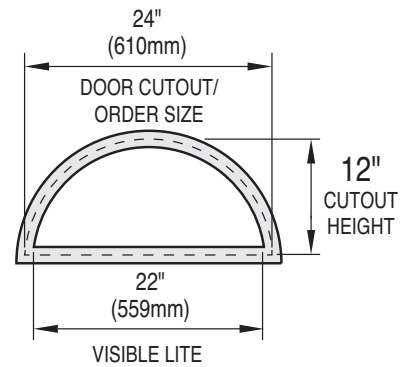

HCT-12

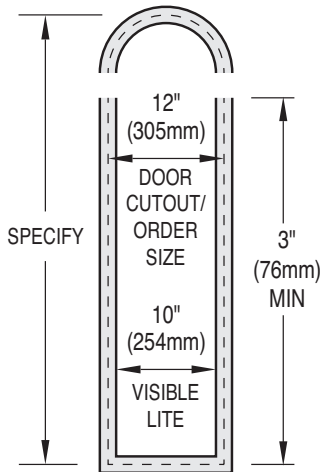

HCT-18

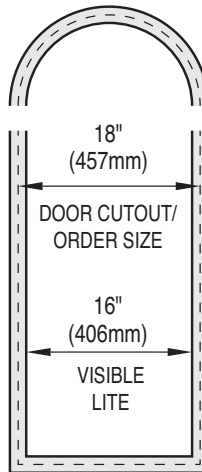

HCT-24

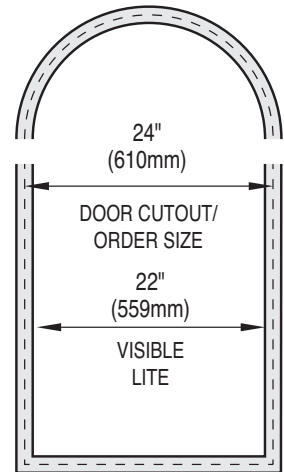

HCTB-12

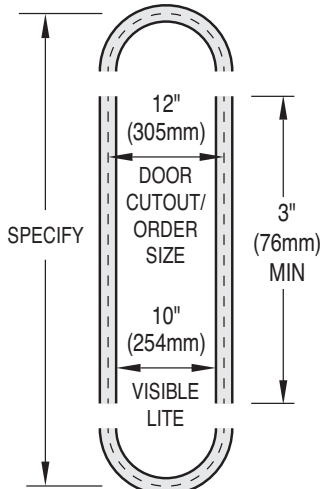

HCTB-18

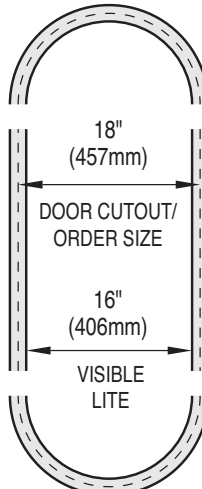

HCTB-24

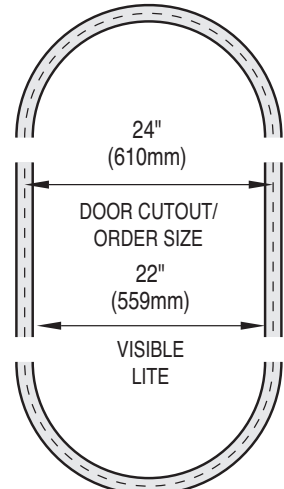



REFERENCE SHEET

FROM

Anemostat

DOOR PRODUCTS

A MESTEK COMPANY

1220 E WATSON CENTER RD

CARSON, CA 90745-4206

(310) 835-7500 • FAX (310) 835-0448

e-mail: door@anemostat.com • website: www.anemostat.com

LoPro™-CS-QR

QUARTER RADIUS

CUSTOM SHAPES

MANUFACTURED FROM:

LOFP-12 AA1, AB1, BB1

LOFP-18 AA1, AB1, BB1

LOFP-24 AA1

DETAIL DRAWING

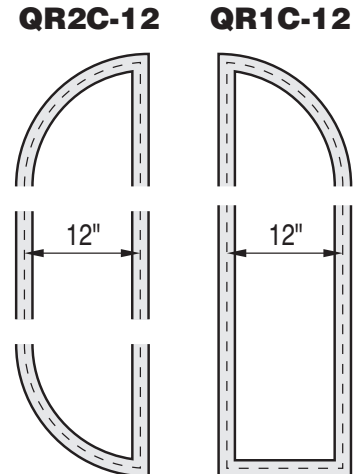
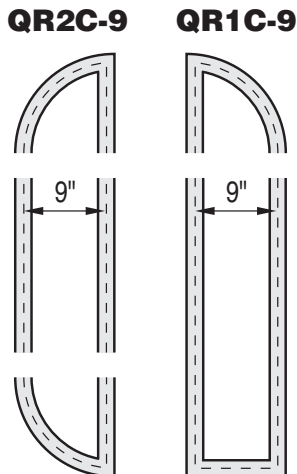
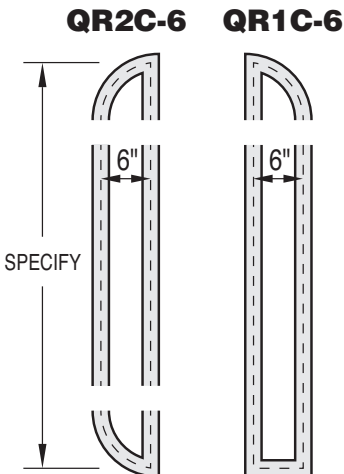
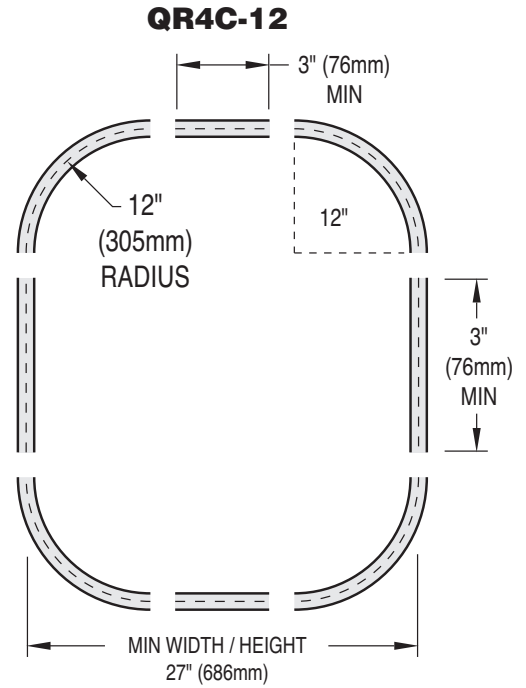
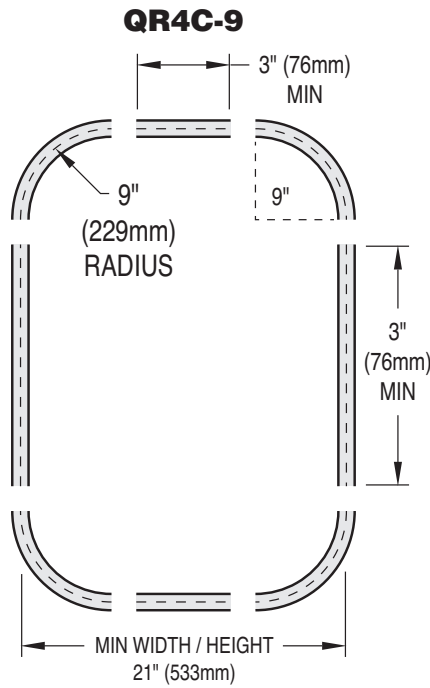
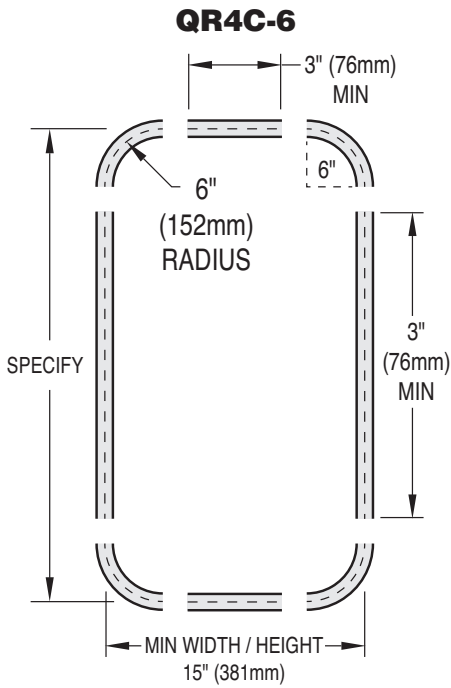
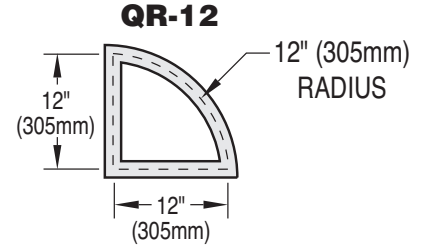
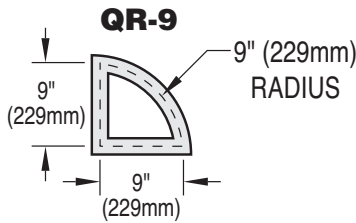
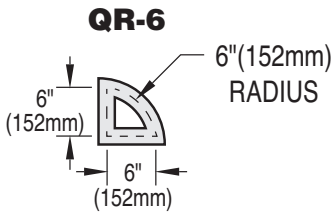



TECHNICAL DATA
FROM
Anemostat[®]
DOOR PRODUCTS
A MESTEK COMPANY

1220 E WATSON CENTER RD
CARSON, CA 90745-4206
(310) 835-7500 • FAX (310) 835-0448

e-mail: door@anemostat.com • website: www.anemostat.com

FGS-75-CS
CUSTOM SHAPES
METAL VISION FRAMES



UNDERWRITERS'
LABORATORIES

FIRE
RATINGS



WARNOCK
HERSEY

B.S.-476.22
British Standard

DETAIL DRAWING

PLEASE NOTE: Custom Shaped Curved Products are NOT AVAILABLE in FGS-75-CS

Some examples are shown below, for other designs consult factory. All Below are also available in LoPro-CS, see page 28

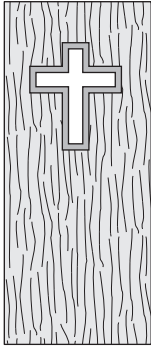

CHRISTIAN CROSS

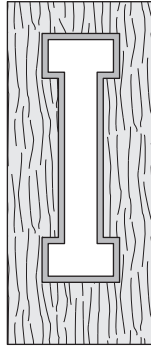

INDIANA

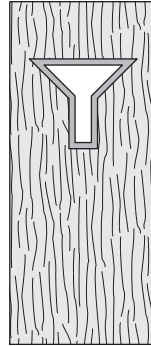

CHAMPAGNE

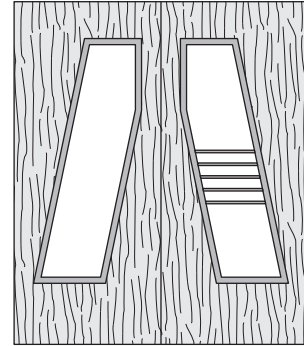

AMERICA

Recommendation: Do Not make Cutouts in Doors prior to receiving Custom Shaped Vision Frame



DIAMOND

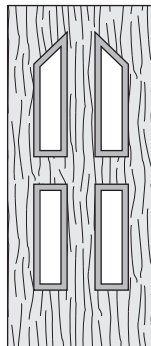

4 LITE
TRAPEZOID TOP

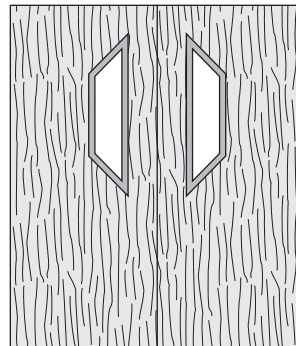

ISOSCELES TRAPEZOID

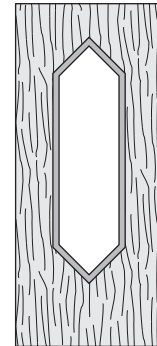

ELONGATED
HEXAGON

* Above designs are manufactured using FGS-75 vision frame.
For other applications or shapes Please consult factory, or
submit desired design.

- Most products can also be manufactured using LoPro™
(self attaching) profile. Specify LoPro-CS.
- For Special Paint, Metal, Glass or Door thickness,
consult factory.
- **NOTE:** For Exterior use, High Humidity
or Salt Air application,
product must be Galvanized or Stainless Steel.
- **IMPORTANT:** Interpretation of building and fire codes may vary.
Consult with the local authority having jurisdiction in
your area, to determine appropriate standards.

FIRE RATINGS (w/ U.L. & W.H.I. classification markings) Positive Pressure

- **20 MINUTE:*** Approved listing at 3204 sq.in. (2.067 m²) visible lite
max. width 36" (914mm), max. height 89" (2261mm).
- **45/60 MINUTE:*** Approved listing at 2772 sq.in. (1.788 m²) visible lite
max. width 36" (914mm), max. height 77" (1956mm).
- **90 MINUTE:*** Approved listing at 1296 sq.in. (0.836 m²) visible lite
max. width 36" (914mm) , max. height 54" (1372mm).
- **3 Hour:*** Approved listing at 100 sq.in. (0.065 m²) visible lite
max. width 12" (305mm), max. height 33" (838mm)

* Must be used with FIRELITE Plus or NT and Fire listed glazing tape or another
manufacturer's equivalent product. Glazing combination must be used in
appropriately tested door assembly.

BS 476.22 Timber Doors - 30 min. and 1 hour.
British Standard Steel Doors - 2 hours (4 hours actual).

- **PLEASE NOTE:** On visible lite sizes larger than 1296 sq. in. (0.836 m²) on
20/45 min. and 100 sq. in. (0.065 m²) on 60/90/180 min., please consult with your
Door / Frame Manufacturer's procedures, for their maximum glass size tested.

Job Name & Location	Submitted by



TECHNICAL DATA
FROM
Anemostat[®]
DOOR PRODUCTS
A MESTEK COMPANY

1220 E WATSON CENTER RD
CARSON, CA 90745-4206
(310) 835-7500 • FAX (310) 835-0448

e-mail: door@anemostat.com • website: www.anemostat.com

FASTENERS
FOR
METAL VISION FRAMES

DETAIL DRAWING

STANDARD



#8X1-3/4" (44mm) SHEET METAL SCREW

USED FOR: LoPro™, LoPro™-IS, LoPro™-G, LoPro™-R, LoPro™-RC, LoPro™-RD, LoPro™-CS, LoPro™-STC, LoPro™-BB1-MB, Lo-FP-12, Lo-FP-18, Lo-FP-24, StormPro-HR™, StormPro-HR™-G, WoodPro

#8X2" SHEET METAL SCREW

USED FOR: BFL-123-G

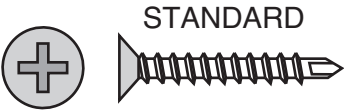

#8X1-1/2" (38mm) SHEET METAL TEK SCREW
USED FOR: FM-G



#8-32X1-1/4" (32mm) SCREW WITH THRU BOLT, BLANK ONE END
USED FOR: FGS-75, FGS-IS, FGS-38, FGS-75-G, FGS-DBL, FGS-75-R, FGS-75-RC, FGS-75-RD, FGS-75-CS, FP-12, FP-18, FP-24, BFL-75, BFL-75-PO

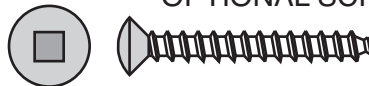

OPTIONAL SCREW (Same upcharge as security screws)
#8X1-1/2" (38mm) SQUARE DRIVE (ROBERTSON HEAD) SHEET METAL SCREW
USED FOR: LoPro™, BFL-123

OPTIONAL SECURITY FASTENERS*
(Consult Factory for Stainless Steel Availability)



ONE WAY VANDAL PROOF

LoPro™ — #8X1-1/2" (38mm)
BFL-123 — #8X2" (51mm)
FGS — #8-32X1-1/4" (32mm)



PINNED FLAT HEAD

LoPro™ — #8X1-1/2" (38mm)
BFL-123 — #8X2" (51mm)
FGS — #8-32X1-1/4" (32mm)



SNAKE EYE SPANNER

LoPro™ — #8X1-1/2" (38mm)
BFL-123 — #8X2" (51mm)



TORX FLAT HEAD

LoPro™ — #8X1-3/4" (44mm)
BFL-123 — #8X2" (51mm)
FGS — #8-32X1-1/4" (32mm)



NOTCHED SPANNER

LoPro™ — #8X1-1/2" (38mm)
BFL-123 — #8X2" (51mm)



TORX-PLUS FLAT HEAD

LoPro™ — #8X1-1/2" (38mm)
FGS — #8-32X1-1/4" (32mm)

*Screw drivers and insert bits for Security Fasteners are available.
Consult Factory for Price and Availability.

Job Name & Location	Submitted by



TECHNICAL DATA
FROM
Anemostat[®]
DOOR PRODUCTS
A MESTEK COMPANY

1220 E WATSON CENTER RD
CARSON, CA 90745-4206
(310) 835-7500 • FAX (310) 835-0448

e-mail: door@anemostat.com • website: www.anemostat.com

HM-CLIP

HOLLOW METAL
DOOR CLIP



UNDERWRITERS'
LABORATORIES

FIRE
RATINGS



WARNOCK
HERSEY

FOR USE WITH ANEMOSTAT PRODUCTS

DETAIL DRAWING

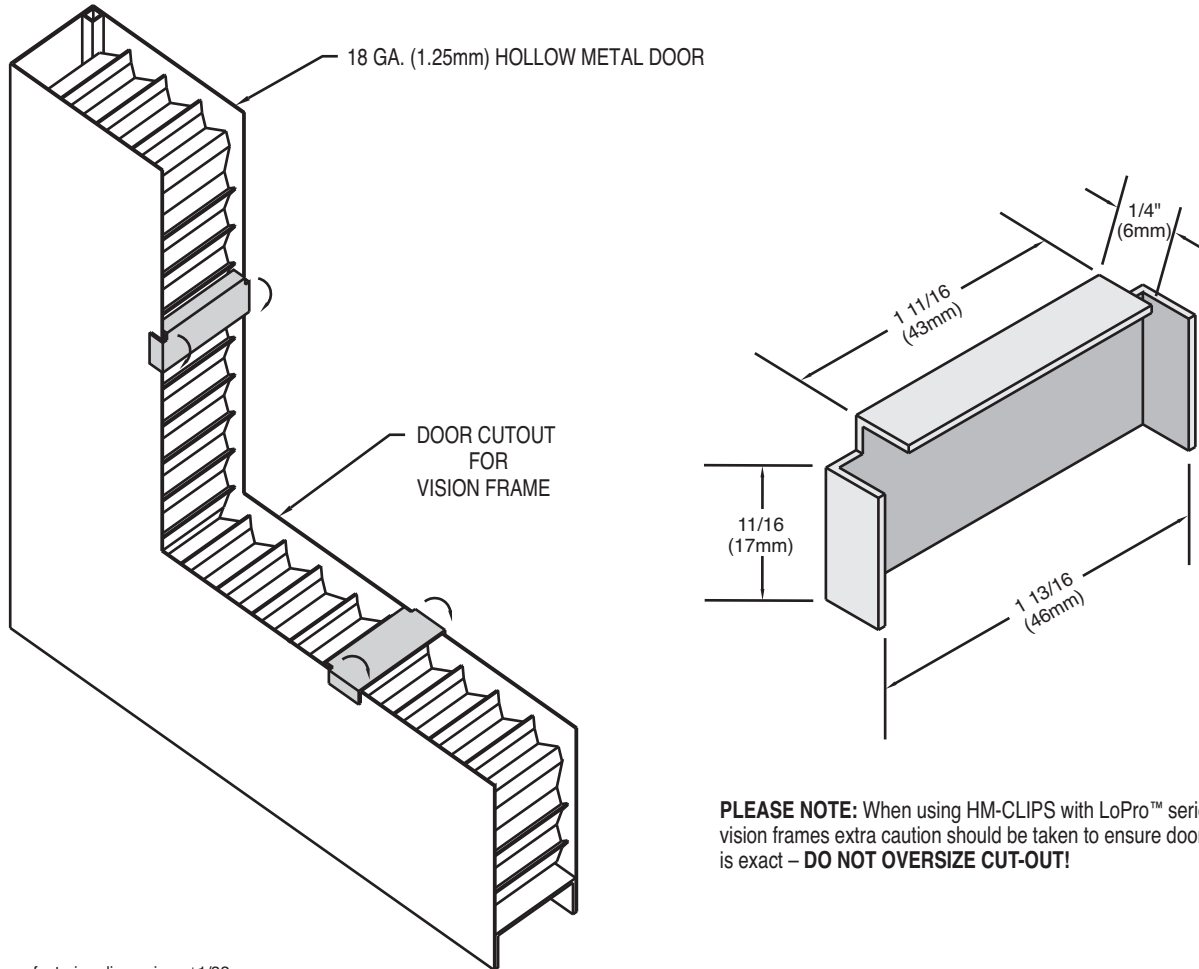

PLEASE NOTE: When using HM-CLIPS with LoPro™ series vision frames extra caution should be taken to ensure door cut-out is exact – **DO NOT OVERSIZE CUT-OUT!**

Anemostat manufacturing dimensions ±1/32
Actual dimensions are nominal and may vary
based on component manufacturers tolerances.

STANDARD PRODUCT FEATURES

- **MATERIAL:** 20 GA. (1mm) Cold Rolled Steel.
- **INSTALLATION:** Put long bent side of clip between door skins, then snap into place, fitting flush with the door cutout.
- **PURPOSE:** Prevents hollow metal door from collapsing when core burns away during a fire.
- **DOOR THICKNESS:** For 1 3/4" (44mm) Door only.
- **USES:** For use in Hollow Metal Door.
Replaces the need for reinforcing channel in all Anemostat Vision Frames and the FLDL-UL fusible link louver.

OPTIONAL FEATURES

- No clips required for 100 sq.in. Anemostat Visible Lite Frames.
- For Lites over 100 sq.in. visible lite.
 - One HM-Clip required on cutout sides 30" (762mm) to 60" (1524mm) centered in side (minimum U.L. requirements).
 - Two HM-Clips required on cutout sides over 60" (1524mm), equally spaced in side (minimum U.L. requirements).

FIRE RATINGS (w/ U.L. & W.H.I. classification markings) Positive Pressure

- 20/45/60/90 minutes listing approval from Underwriters Laboratory and Warnock Hersey for use on all Anemostat Vision Frames and the FLDL-UL Louver.

Job Name & Location	Submitted by