

**SARGENT®**

**ASSA ABLOY**

---

---

# 30 Series

---

---

Exit Device

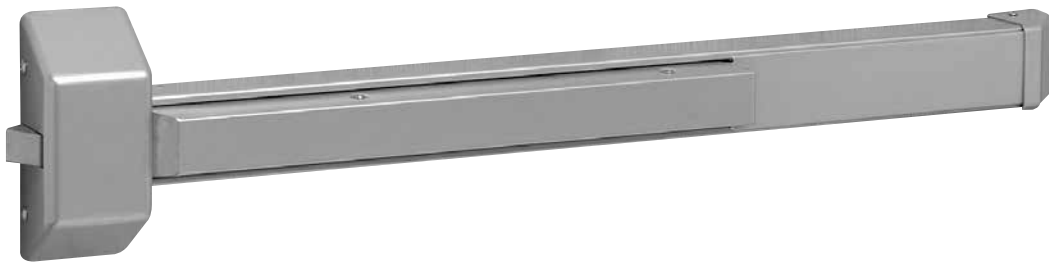

# Table of Contents

## 30 Series Exit Device

---

|   |     |
|---|-----|
| Features, Applications and UL Fire Door Ratings ..... | 1   |
| 3727/ NB3727 Vertical Rod Type Exit Device .....      | 2   |
| 3828 Rim Type Exit Device .....                       | 3   |
| 30 Series Trims .....                                 | 4   |
| Alternate Strikes and Shim Kits .....                 | 5   |
| Mullions and Door Kits .....                          | 6   |
| Mechanical & Cylinder Options .....                   | 7-8 |
| Cylinder Options .....                                | 8   |
| Ordering Information, Rail Sizes & Finishes .....     | 9   |
| Architectural Specifications and How To Order .....   | 10  |

### On The Cover

---

- SARGENT 3828 Rim Exit Device  
with EN Finish

# Features, Applications and UL Fire Door Ratings

## 30 Series Exit Device



### Applications

#### Features

- Rugged exit device in surface vertical rod and rim designs
- Chassis mounted unit construction assures easy installation and maintenance
- Tapered push rail and angled covers
- Steel endcaps and covers
- Up to five functions with a variety of trim
- All exit devices meet ANSI/BHMA Standard 156.3, Grade 1
- UL Listed
- UL Listed to Canadian safety standards
- Available as Fire Exit Hardware (12-)

#### Single Door

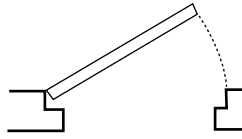

**Vertical Rod Type 3727 / NB3727**  
Surface applied 2 / 1 point lock.  
**Rim Type 3828**  
Surface application.

#### Pairs of Doors without Mullion

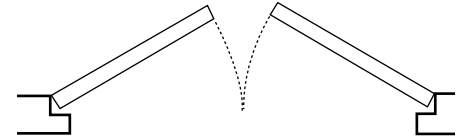

**Vertical Rod Type 3727 / NB3727 - 2 Each**  
Surface applied 2 / 1 point locking both doors.  
Each door active. Do not use an overlapping astragal.

#### Pairs of Doors with 980 Mullion

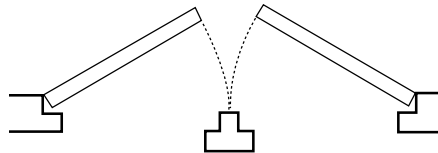

**Rim Type 3828 - 2 Each**  
**980 Mullion - 1 Each**  
Two independent active doors with full double door opening when required.

#### Pairs of Doors without Mullion

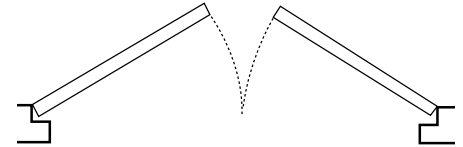

**Vertical Rod Type 3727 / NB3727 - 1 Each**  
**Rim Type 3828 - 1 Each**  
Both devices are surface applied.  
A coordinator is required.

### Maximum Door Openings & UL Fire Door Ratings

For available functions and outside trim, see charts for regular exit devices

| • = Available   |  |                                  | UL Fire Door Rating |                      |                      |                    |                    |
|---|--|----------------------------------|---------------------|----------------------|----------------------|--------------------|--------------------|
| Application & Type  | Regular Design                                 | Maximum Door Opening             | (A)<br>3<br>Hour    | (B)<br>1 1/2<br>Hour | (B)<br>1 1/2<br>Hour | (D)<br>1/2<br>Hour | (E)<br>3/4<br>Hour |
| <b>Single Doors</b><br><b>Rim Type</b>  | 12-3828  | 4'0" X 8'0"<br>(1219mm X 2438mm) | •                   | •                    | •                    | •                  | •                  |
| <b>Pair of Doors</b><br>Two Surface<br>Mounted Vertical<br>Rod Type<br>- Swinging in same<br>direction  | *12-3727 x *12-3727<br>*12-NB3727 x *12-NB3727 | 8'0" X 8'0"<br>(2438mm X 2438mm) | •                   | •                    | •                    | •                  | •                  |
| <b>Two Rim Type with</b><br><b>12-980 Mullion</b>   | 12-3828<br>x 12-3828                           | 8'0" X 8'0"<br>(2438mm X 2438mm) | •                   | •                    | •                    | •                  | •                  |
| <b>Two Surface</b><br><b>Mounted Vertical</b><br><b>Rod Type</b><br>-Swinging in<br>opposite directions | 12-3727 x 12-3727                              | 8'0" X 8'0"<br>(2438mm X 2438mm) | •                   | •                    | •                    | •                  | •                  |
|   | 12-NB3727 x<br>12-NB3727 <sup>^</sup>          |                                  | •                   | •                    | •                    | •                  | •                  |

**Note:** Please contact door manufacturer for specifications regarding fire door construction

\*Limited for fire doors listed by UL for this use. NFPA requires an astragal on 3 hour applications.  
Vertical rod application will not work with astragal.

<sup>^</sup> Thermal pins required, 2 pins per set, 1 per door.

Any retrofit or other field modification to a fire rated opening can potentially impact the fire rating of the opening, and Sargent Manufacturing Company makes no representations or warranties concerning what such impact may be in any specific situation. When retrofitting any portion of an existing fire rated opening, or specifying and installing a new fire-rated opening, please consult with a code specialist or local code official (Authority Having Jurisdiction) to ensure compliance with all applicable codes and ratings.

# 3727 / NB3727 Vertical Rod Type 30 Series Exit Device

**SARGENT®**  
**ASSA ABLOY**

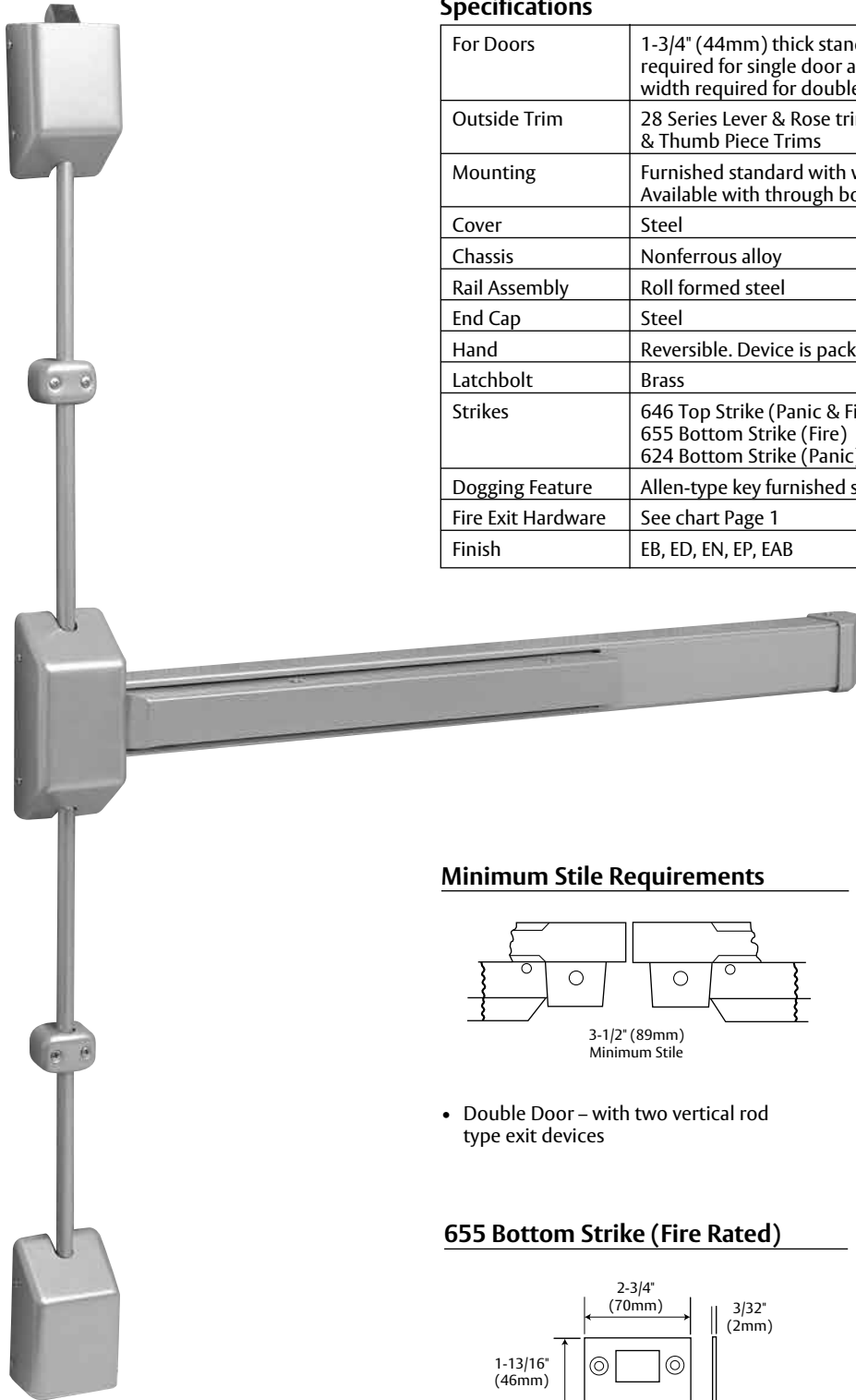

## Specifications

|                    |  |
|--------------------|--|
| For Doors          | 1-3/4" (44mm) thick standard. 3-3/4" (95mm) minimum stile width required for single door application. 3-1/2" (89mm) minimum stile width required for double door application. Standard AFF is 41". |
| Outside Trim       | 28 Series Lever & Rose trims, GTB/HTB Pulls & Plates, OB Knob trims & Thumb Piece Trims  |
| Mounting           | Furnished standard with wood and machine screws<br>Available with through bolts and mortise nuts   |
| Cover              | Steel  |
| Chassis            | Nonferrous alloy   |
| Rail Assembly      | Roll formed steel  |
| End Cap            | Steel  |
| Hand               | Reversible. Device is packed standard LHRB   |
| Latchbolt          | Brass  |
| Strikes            | 646 Top Strike (Panic & Fire)<br>655 Bottom Strike (Fire)<br>624 Bottom Strike (Panic)   |
| Dogging Feature    | Allen-type key furnished standard (Non Fire Rated Devices Only)  |
| Fire Exit Hardware | See chart Page 1   |
| Finish             | EB, ED, EN, EP, EAB  |

The 3727/NB-3727 Multi-function SVR Exit Device is the perfect stocking device.

- 6 functions determined by trim selected
- Device & trim sold separately; easy to mix and match
- 4 available trim designs

Order as an 3727 followed by rail size, opening, AFF and finish

## Minimum Stile Requirements

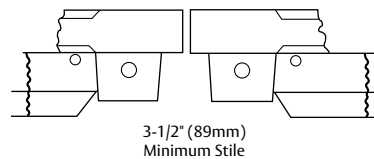

- Double Door – with two vertical rod type exit devices

## 646 Top Strike

- Standard for both Panic & Fire (12-) Hardware with or without bottom rod
- Surface applied to frame
- Black nylon coated

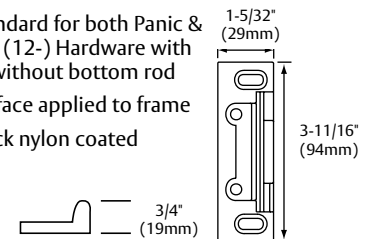

## 655 Bottom Strike (Fire Rated)

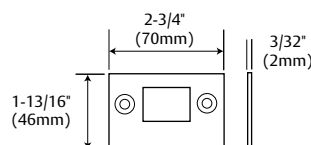

- Standard for 12-
- Stainless steel
- Black nylon coated

## 624 Bottom Strike (Panic)

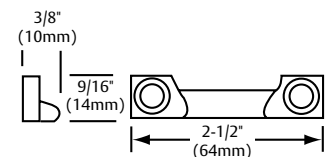

- Standard for 3727
- Applied to surface of floor or to a flat threshold
- Black nylon coated

# 3828 Rim Type

## 30 Series Exit Device

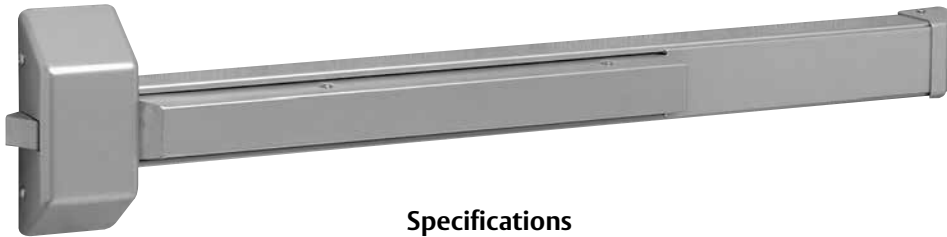

### Specifications

|                                  |   |
|----------------------------------|---|
| For Doors                        | 1-3/4" (44) thick standard. 4-1/2" (114mm) minimum stile width required for single or double door application using standard 649 strike |
| Outside Trim & Thumb Piece Trims | 28 Series Lever & Rose trims, GTB/HTB Pulls & Plates OB Knob trims  |
| Mounting                         | Furnished standard with wood and machine screws<br>Available with through bolts and mortise nuts  |
| Cover                            | Steel   |
| Chassis                          | Nonferrous alloy  |
| Rail Assembly                    | Roll formed steel   |
| End Cap                          | Steel   |
| Hand                             | Non handed  |
| Latchbolt                        | Stainless steel 3/4" (19mm) throw   |
| Strike                           | 649 packed standard   |
| Dogging Feature                  | Allen-type key furnished standard (non fire rated devices only)   |
| Fire Exit Hardware               | See chart Page 1  |
| Finish                           | EB, ED, EN, EP, EAB   |

The 3828 Multi-function Rim Exit Device is the perfect stocking device.

- 7 functions determined by trim selected
- Device & trim sold separately; easy to mix and match
- 4 available trim designs

Order as an 3828 followed by rail size and finish

### 649 Strike

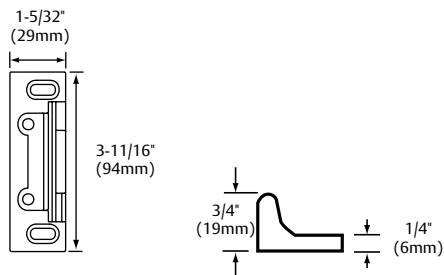

- Surface applied
- Standard & Fire Rated
- Strikes are black nylon coated

### Minimum Stile Requirements

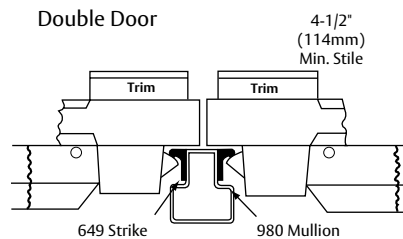

### Minimum Stile Requirements

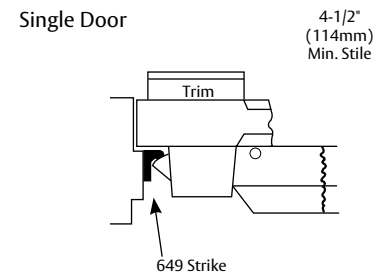

## 30 Series Trims

### 30 Series Exit Device

The trim function determines the function of the exit device. All 28 Series trims work with all 30 Series Exit Devices, except where noted.

**Note:** All trims and exit devices are ordered and packaged separately.

### 28 Series Lever & Rose Trim for 3727/3828 Series Exit Devices



#### Lever & Rose Trim

- For 1-3/4" (44mm) doors only
- Functions available for 04, 06, 10, 13 & 15
- Not handed
- Finishes: 03, 04, 10, 10B, 10BE, 20D & 26D
- Lever designs available: "L", "B", "P"

To order specify 28 followed by the function (K, N, D, C or L), the rose (L), the lever (L, B or P) and finish

Example: 28-K-LL x 26D

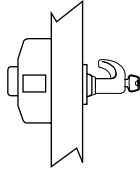

#### 28-K-LL Night Latch

Key in lever retracts latchbolt.

**04 Function  
For 3828 only  
(ANSI 03)**

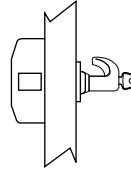

#### 28-N-LL Night Latch

Lever operates only when key is in cylinder and turned.

**06 Function  
(ANSI 09)**

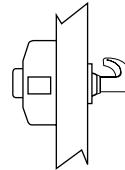

#### 28-D-LL Dummy

Lever rigid at all times & no outside function.

**10 Function  
(ANSI 02)**

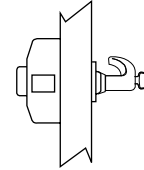

#### 28-C-LL Entrance

Key in lever locks or unlocks lever.

**13 Function  
(ANSI 08)**

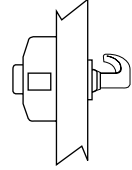

#### 28-L-LL Passage

Latchbolt operated by lever.

**No Cylinder  
15 Function  
(ANSI 14)**

### 28 Series GTB/HTB Pulls & Plates for 3727/3828 Series Exit Devices



810-GTB



802-GTB



814-HTB

- For 1-3/4" (44mm) doors standard
- Through-bolted with 3 mortise nuts
- Pulls project 1-1/2" (38mm) from door face
- GTB Design trim will cover a 161 cutout
- Trim ordered separately.
- Finishes: EN, EB, ED, EP & EAB

• For cylinder operation only with no trim (Specify 3828 x 34 rim cylinder x Finish)

To order specify: trim design and finish

Example: 814-HTB x EN

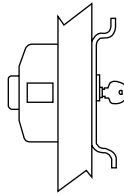

#### 814-HTB Night Latch

Outside by pull and key. (3828 only)

**04 Function  
(ANSI 03)**

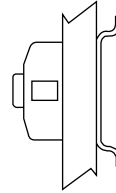

#### 810-GTB Exit Only with Pull

Outside pull when push bar is locked down.

**10 Function  
(ANSI 02)**

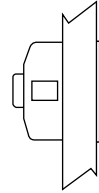

#### 802-GTB Exit Only

Blank plate to cover 161 cutout.

**10 Function  
(ANSI 01)**

### 28 Series OB Knob Trim for 3727/3828 Series Exit Devices



- For 1-3/4" (44mm) doors only
  - Functions available for 04, 13 and 15
  - Non-handed
  - Finishes: 03, 04, 10, 10B, 10BE, 20D & 26D
- To order specify 28 followed by the function (K, C or L), the rose (O), the knob (B) and finish

Example: 28-K-OB x 26D

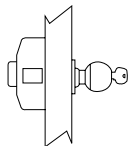

#### 28-K-OB Night Latch

Key in knob retracts latchbolt.

**3828 only  
04 Function  
(ANSI 03)**

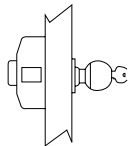

#### 28-C-OB Entrance

Key in knob locks or unlocks knob.

**13 Function  
(ANSI 08)**

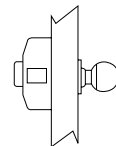

#### 28-L-OB Passage

Latchbolts operated by knob.

**No Cylinder  
15 Function  
(ANSI 14)**



- Finishes: EN, EB, ED, EP & EAB
- \*1 3/4" Door Only

#### 866-TP

Key locks or unlocks thumbpiece. (63)

#### 814-TP

Key retracts latchbolt. (3828 ONLY) (04)

#### 828-TP

Thumbpiece always operable. (28)

#### 810-TP

Dummy trim. (10)

To order specify: trim design and finish  
Example: 866-TP x EN

## Alternate Strikes and Shim Kits

### 30 Series Exit Device

#### Alternate Strikes

##### 613 Strike (Alternative for 3828)

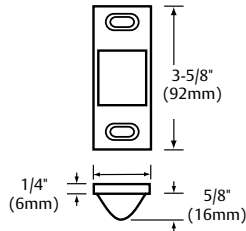

Half mortised. Nylon coating on face plate only. Minimum stile 4". When ordered separately, specify finish.

##### 644 Strike (Alternative for 3828)

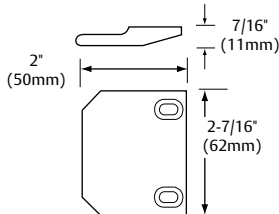

Surface applied. For use on pair of doors without mullion. Specify outside finish when ordered separately.

##### 642 Strike (Alternative for 3828)

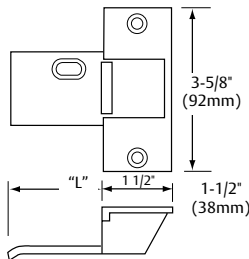

Full mortised Dimension "L" equals door thickness plus 1/2" (13mm).

##### 653 Bottom Strike (Alternate for 12-3727)

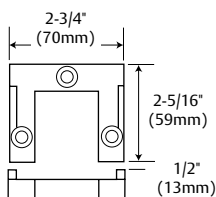

Available on order for 12-3727. For use with 1/2" (13mm) high threshold. Cut threshold to fit strike. Stainless steel. Furnished with expansion shields.

#### Glass Bead Shim Kits

558 for 3828 and 12-3828 Exit Devices

559 for 3727 and 12-3727 Exit Devices

Note: When ordering shim kits for exits with outside trim, spindle length, thumbpiece length and through bolt length must be increased accordingly.

(2 pieces 1/8" shim supplied. 1/4" total.)

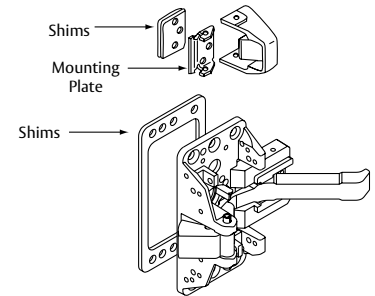

#### Through Bolt (TB) Applications

| Device         | Door Thickness | *Ordering Number |
|----------------|----------------|------------------|
| 3727           | 1-3/4" (44mm)  | 28-2031          |
|                | 2-1/4" (57mm)  | 28-2032          |
| 12-3727        | 1-3/4" (44mm)  | 28-2078          |
|                | 2-1/4" (57mm)  | 28-2088          |
| 3828 & 12-3828 | 1-3/4" (44mm)  | 28-2024          |
|                | 2-1/4" (57mm)  | 28-2025          |

\*Specify finish

Through bolts and mortise nuts are furnished in a pack along with the appropriate instruction sheet for device ordered.

To order through bolts and mortise nuts with an exit device, add suffix TB to trim pack.

**Example: 3727 x TB x EN**  
Available finishes: EB, EN, ED, EAB

To order through bolts and mortise nut packs separately, see chart above.

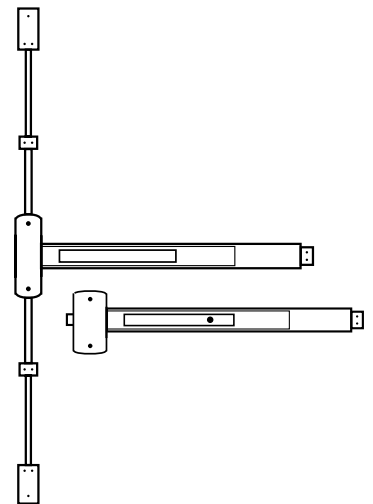

#### Rod Replacement Kits

| Product | Top Rod Kit ++ | Bottom Rod Kit +++ |
|---------|----------------|--------------------|
| 3700+   | 672T           | 672B               |

+ Finish Information Required

++ Door Height & Rail Location Required

+++ Rail Location Required

## Mullions and Door Kits

### 30 Series Exit Device

#### 980 Removable Mullion

980 Extruded Aluminum (prime coat)  
980A Aluminum (US28)

Consists of:

- Mullion
- 511 Top Retainer
- 502 Bottom Retainer
- 96" (2438mm) stock size; 120" (3000mm) available

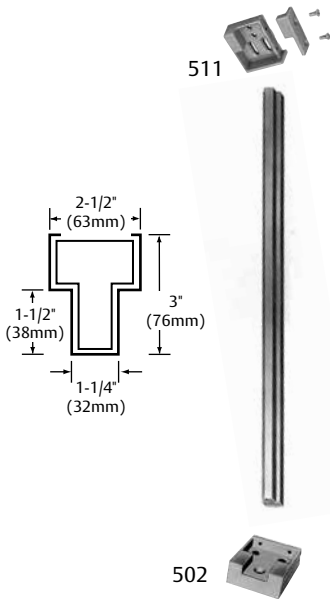

#### 12-980 Mullion (96" maximum)

For 12-3828

2" x 3" Channel Iron. Malleable iron top and bottom retainers.

- 96" (2438mm) stock size; 120" (3000mm) available
- 120" Mullions do not carry UL fire label

Top Retainer Shim Kit - 601

Top Retainer 98-2190



Bottom Retainer 98-2191



#### L980 Lockable Mullion

- Aluminum Prime Coat
- Specify: "L980A" Anodized Aluminum  
Specify: "L980A x10B" for 313AN to match 10B
- Used for non fire rated applications
- 96" (2438mm) stock size
- 120" (3000mm) available
- Standard #41 cylinder (1-1/8")
- Cylinder options: Signature, XC-, Schlage Keyways SC- & SE- available
- Wall Mount Kit 98-2578
- Top Ret Pack 98-2526
- Bottom Ret Pack 98-2525
- Cylinder Kit must be ordered separately (980C1)

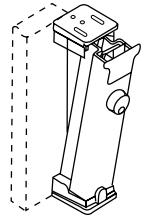

#### 12-L980 Lockable Mullion

- Steel
- Fire rated for 8'0" x 8'0" (2438mm x 2438mm) paired openings
- 96" (2438mm) Stock Size
- 120" (3000mm) (Non Fire Rated) available
- #41 cylinder standard
- Cylinder options: Signature, XC-, Schlage Keyways SC- & SE- available
- Top Retainer Shim Kit - 601
- Cylinder Kit must be ordered separately (980C1)

#### EL980 Electric Lockable Mullion

- Steel
- For use with monitor or electric strikes
- Quick-Connect wiring supplied
- 96" (2438mm) stock size
- 120" (3000mm) available
- Requires a #46 cylinder
- Top Retainer Shim Kit - 601
- Not available in 12- option
- Cylinder Kit must be ordered separately (980C2)

#### Mullion Accessories

**RK980**

Latchbolt assembly retrofit kit with top and bottom retainers for 980 mullion

#### Retainer Packs

| Product # | Description                  |
|-----------|------------------------------|
| 98-2526   | Top Ret. pack for L980       |
| 98-2525   | Bottom Ret. pack for L980    |
| 98-2558   | Top Ret. pack for 12-L980    |
| 98-2556   | Bottom Ret. pack for 12-L980 |
| 98-2559   | Top Ret. pack for EL980      |

#### 507 Adapter for Narrow Transom Bars

- Available with 980 and 980A
- Required when soffit is 1-1/4" (32mm) to 2" (51mm) wide

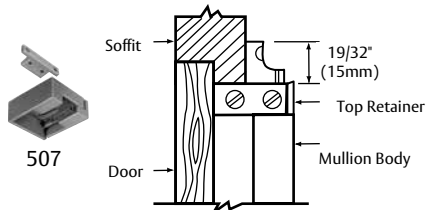

#### 543 Stock Hollow Metal Door Kit

Kit consists of a 649 Strike Shim, a 161F Lock Front Filler, and a 865 Strike Filler for applying a 3828 Series Exit Device on doors prepared with Fed. Type 161 cutouts, and frames prepared for ANSI A115-2 Strikes.

The 649 strike shim is 1/8" (3mm) thick and is used to obtain the correct distance between the exit device case and the 649 surface applied strike, when the stop is 1/2" (13mm) high.



649 Strike Shim



161 Lock Front Filler



865 Strike Filler

**Note:** For complete Listing of available mullions, see the 80 Series Catalog



# Mechanical & Cylinder Options

## 30 Series Exit Device



### Mechanical Options:

**Note:** Mechanical Options are available for Exit Devices only

|                    |     |  |
|--------------------|-----|--|
| Fire Rated         | 12- | UL Fire Label Exit hardware (not available with 16- & HK-) |
| Dogging Options    | 16- | Cylinder Dogging (Non Fire Rated Devices Only)             |
|                    | LD- | Less Dogging (Non Fire Rated Devices Only)                 |
| Electrical Options | 55- | Request to Exit - Signal Switch in Rail                    |
| Top Rod Only       | NB- | Less Bottom Rod (Available for 3727 Devices)               |

### Cylinder Options:

**Note:** Cylinder Options are available for 16- Exit Devices and 04, 06 & 13 function trims

|                      | Code   | Description  | Lever Trim | Knob Trim | GTB-HTG-Thumbpc Trim | Rail - 16-Cyl Dogging |
|----------------------|--|--|------------|-----------|----------------------|-----------------------|
| Degree Key System    | DG1-   | SARGENT Degree Key System Level 1 (bump resistant with patented keys)                                  | X          | X         | X                    | X                     |
|                      | DG1-21-  | Degree Level 1 Construction Master Keying  | X          | X         | X                    | X                     |
|                      | DG1-60-  | Degree Level 1 Removable Disposable Construction Core  | X          |           | X                    | X                     |
|                      | DG1-63-  | Degree Level 1 Removable Core  | X          |           | X                    | X                     |
|                      | DG1-64-  | Degree Level 1 Removable Construction Keyed LFIC   | X          |           | X                    | X                     |
|                      | DG2-   | SARGENT Degree Key System Level 2 (geographically exclusive; bump and pick resistant)                  | X          | X         | X                    | X                     |
|                      | DG2-21-  | Degree Level 2 Construction Master Keying  | X          | X         | X                    | X                     |
|                      | DG2-60-  | Degree Level 2 Removable Disposable Construction Core  | X          |           | X                    | X                     |
|                      | DG2-63-  | Degree Level 2 Removable Core  | X          |           | X                    | X                     |
|                      | DG2-64-  | Degree Level 2 Removable Construction Keyed LFIC   | X          |           | X                    | X                     |
|                      | DG3-   | SARGENT Degree Key System Level 3 (geographically exclusive; UL437 certified; bump and pick resistant) | X          | X         | X                    | X                     |
|                      | DG3-21-  | Degree Level 3 Construction Master Keying  | X          | X         | X                    | X                     |
|                      | DG3-60-  | Degree Level 3 Removable Disposable Construction Core  | X          |           | X                    | X                     |
|                      | DG3-63-  | Degree Level 3 Removable Core  | X          |           | X                    | X                     |
| DG3-64-              | Degree Level 3 Removable Construction Keyed LFIC | X  |            | X         | X                    |                       |
| Signature Key System | 10-  | SARGENT Signature Key System   | X          | X         | X                    | X                     |
|                      | 10-UL  | SARGENT Signature Key System meets UL437 requirements  |            |           | X                    | X                     |
|                      | 10-21-   | SARGENT Signature Construction Key System (Lost Ball)  | X          | X         | X                    | X                     |
|                      | 10-63  | SARGENT Signature LFIC (Removable Core) Cylinder   | X          |           | X                    | X                     |

**Note:** For cylinder options not shown, please contact factory for availability

**Note:** For V-10 Cylinders and information, contact ASSA

# Cylinder Options

## 30 Series Exit Device

|                          | Code  | Description  | Lever Trim | Knob Trim | GTB-HTG-Thumbpc Trim | Rail - 16-Cyl Dogging |
|--------------------------|---|--|------------|-----------|----------------------|-----------------------|
| Signature Key System     | 11-   | XC Key System (not available with other key systems unless specified)  | X          | X         | X                    | X                     |
|                          | 11-21-  | XC- Construction Key System (Lost Ball)  | X          | X         | X                    | X                     |
|                          | 11-60   | Hardware to accept XC- Permanent LFIC (Removable core), Disposable plastic Core- provided  | X          |           | X                    | X                     |
|                          | 11-63   | Hardware provided with XC- LFIC (Removable core) Cylinder - (includes masterkeying, grand masterkeying)  | X          |           | X                    | X                     |
|                          | 11-64   | Hardware provided with Keyed construction core to accept XC- LFIC (Removable) Permanent core (ordered separately)  | X          |           | X                    | X                     |
|                          | 11-70-7P  | Lock to accept XC- SFIC (7-Pin) XC- Permanent cores, plastic disposable core provided  | X          |           | X                    | X                     |
|                          | 11-72-7P  | Lock to accept XC- SFIC (7-Pin Keyed Construction core provided) cylinder Permanent core ordered separately  | X          |           | X                    | X                     |
|                          | 11-73-7P  | Lock supplied with XC- Small Format 7-Pin interchangeable core (includes masterkeying, grand masterkeying)   | X          |           | X                    | X                     |
|                          | 11-65-73-7P   | Lock provided to accept XC- Uncombined 7-Pin SFIC (Permanent) core - (packed loose)  | X          |           | X                    | X                     |
|                          | 60  | Hardware to accept SARGENT Permanent LFIC (Removable core), Disposable plastic core provided (Permanent cores ordered separately)                            | X          |           | X                    | X                     |
|                          | 63  | Hardware provided with LFIC (Removable core) Cylinder - (includes masterkeying, grand masterkeying)  | X          |           | X                    | X                     |
|                          | 64  | Hardware provided with Keyed construction core to accept LFIC (Removable) Permanent core (ordered separately)  | X          |           | X                    | X                     |
|                          | 70  | Lock to accept 6- or 7-Pin SFIC Permanent cores, plastic disposable core provided  | X          |           | X                    | X                     |
|                          | 72  | Lock to accept 6- or 7-Pin SFIC (Keyed Construction core provided) Cylinder (Permanent core ordered separately)  | X          |           | X                    | X                     |
|                          | 73  | Lock supplied with 6-Pin SFIC (includes masterkeying, grand masterkeying)  | X          |           | X                    | X                     |
|                          | 65-73   | Lock provided to accept Uncombined 6-Pin SFIC (Permanent) core - (packed loose for field keying)   | X          |           | X                    | X                     |
|                          | 75-73-7P  | Lock provided to accept Uncombined 7-Pin SFIC (Permanent) core - (packed loose for field keying)   | X          |           | X                    | X                     |
|                          | 73-7P   | Lock supplied with Small Format 7-Pin Interchangeable core (includes masterkeying, grand masterkeying)   | X          |           | X                    | X                     |
|                          | 80  | Lock to accept Keso and Keso F1 cylinders - no cylinders provided  |            |           | X                    | X                     |
|                          | 81  | Cyl to accept Keso and Keso F1 - Removable cores - no core provided  |            |           | X                    | X                     |
|                          | 82  | Lock provided with SARGENT Keso Security Cylinder  |            |           | X                    | X                     |
|                          | F1-82   | Lock provided with SARGENT Keso F1 Security Cylinder (Patented)  |            |           | X                    | X                     |
| 83                       | SARGENT Keso Security Removable Core Cylinder (for existing systems only) |  |            | X         | X                    |                       |
| 84                       | SARGENT Keso Security Removable Construction Core Cylinder                |  |            | X         | X                    |                       |
| Construction Key Systems | 21-   | SARGENT Lost Ball Construction Keying for Conventional, XC and Signature Series (N/A with 63- or 73-)  | X          | X         | X                    | X                     |
|                          | 22-   | SARGENT Construction Split Key System for Conventional Cylinders (for existing systems only) (N/A with 10-, 11-, 63- or 73-)                                 | X          | X         | X                    | X                     |
| Added Security           | BR-   | Bump Resistant Cylinder (Available with Conventional & Conventional XC Cylinders Only)   | X          | X         | X                    | X                     |
| Less Cylinder            | LC-   | Less Cylinder  | X          | X         | X                    | X                     |
| Schlage Keyways          | SC-   | Schlage C keyway cylinder, 0 bitted  | X          | X         | X                    | X                     |
|                          | SE-   | Schlage E keyway cylinder, 0 bitted  | X          | X         | X                    | X                     |
|                          | SF-   | L Lever to accept Medeco KeyMark Large Format Interchangeable and Schlage Full Size Interchangeable Core (supplied less Cylinder, but with tailpiece needed) | X          |           |                      |                       |

**Note:** For cylinder options not shown, please contact factory for availability

**Note:** For V-10 Cylinders and information, contact ASSA

# Ordering Information, Rail Sizes & Finishes

## 30 Series Exit Device



### Check List for Ordering

Indicate the following door and frame information:

- Single doors, or pair of doors with mullion, or pair of doors without mullion
- Door and frame material
- Dimensions:
  - Door opening width
  - Stile width
  - Door thickness
  - Stop height

**Example: Single Door x Hollow Metal Frame 36" x 5" x 2-1/4" x 1/2"**

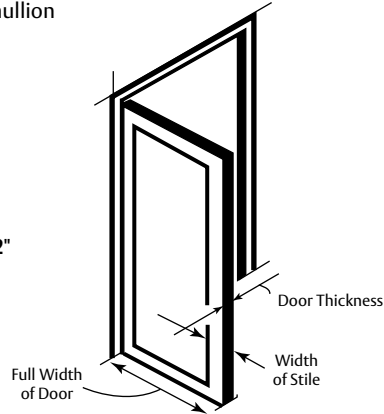

- If Vertical Rod Devices also indicate:
  - Mounting height
  - Door opening height
  - Threshold height
  - If no threshold is used, so state
  - Unless threshold information is indicated, exit device will be furnished for use without threshold
- Mullion stock size is 96" (2438mm); 120" (3000mm) available
- In ordering templates for hollow metal doors and/or frames, state job name on template order. Give template order number or template numbers on hardware order.

### Stock Rail Sizes Available

|   |           |                 |                     |
|---|-----------|-----------------|---------------------|
| E | For doors | 24" through 32" | 61cm through 81cm   |
| F | For doors | 33" through 36" | 82cm through 91cm   |
| J | For doors | 37" through 42" | 94cm through 107cm  |
| G | For doors | 43" through 48" | 109cm through 122cm |

### Finishes available with Lever & Rose Trim and OB Knob Trim

| SARGENT Designation | ANSI/BHMA Designation | Finish Description                     |
|---------------------|-----------------------|--|
| 03                  | 605                   | Bright brass, clear coated             |
| 04                  | 606                   | Satin brass, clear coated              |
| 10                  | 612                   | Satin bronze, clear coated             |
| 10B                 | 613                   | Dark oxidized satin bronze, oil rubbed |
| 10BE                | 613E                  | Dark oxidized satin bronze, equivalent |
| 20D                 | 624                   | Statuary bronze dark powder coated     |
| 26D                 | 626                   | Satin chromium plated                  |

### Finishes available with Exit Devices, GTB Trims & Thumbpiece Trim

| SARGENT Designation<br>ANSI/BHMA Designation | ANSI/BHMA Designation<br>Finish Description | Finish Description   | SARGENT Designation |
|--|---|--|---------------------|
| EB   | 690   | Sprayed bronze enamel or polyester powder coated to match finish 10B   |                     |
| ED   | 693   | Sprayed black enamel or polyester powder coated to match finish 20D    |                     |
| EN   | 689   | Sprayed aluminum enamel or polyester powder coated                     |                     |
| EP   | 691   | Sprayed bronze enamel or polyester powder coated to match finish 10    |                     |
| EAB  | 696   | Brass enamel or polyester powder coated to be used with brass finishes |                     |

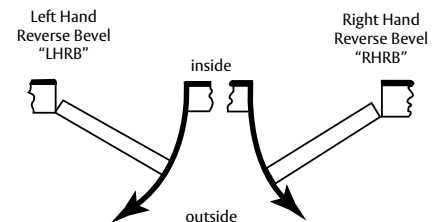
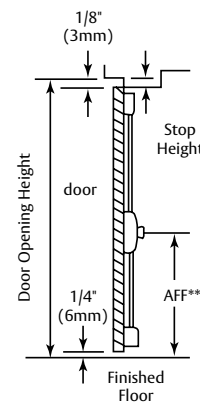

### Packaging

| Product        | Avg. WT | Case |
|----------------|---------|------|
| Exit with trim | 15 lbs. | 1 ea |
| 980 mullion    | 18 lbs. | 1 ea |
| 12-980 mullion | 40 lbs. | 1 ea |

\*\* AFF: Above Finish Floor or Threshold; Required information for 3727 Devices. Standard mounting height 41" (104mm) above finished floor to centerline of device or 38" (965mm) above finished floor to centerline of device for elementary schools.

### How to order 3727/3828 Multi-function Exit Devices:

| Specify the following for 3727 Devices: |        |      |         |     |        |
|---|--------|------|---------|-----|--------|
| Options                                 | Series | Rail | Opening | AFF | Finish |
| 11-NB-                                  | 3727   | F    | 84"     | 41" | EN     |

| Specify the following for 3828 Devices: |        |      |        |
|---|--------|------|--------|
| Options                                 | Series | Rail | Finish |
| 11-16-                                  | 3828   | F    | EN     |

- All trims and functions listed on this page, work with 3727 & 3828 Exit Devices, except where noted
- Available Options listed on Page 7

### How to order Trim for 3727 & 3828 Exit Devices (Exit Device Sold Separately)

#### Example:

| 11-                             | 28-C-LL                               |                       | 26D                              |     |
|---------------------------------|---------------------------------------|-----------------------|----------------------------------|-----|
| Options                         | Available Trim & Function Designation |                       | Available Finishes               |     |
| Available Options<br>See Page 7 | <b>Lever &amp; Rose Trim</b>          |                       | <b>Lever &amp; Rose Finishes</b> |     |
|                                 | 28-K-LL (04 Function)                 | 28-C-LL (13 Function) | 03                               | 04  |
|                                 | 28-N-LL (06 Function)                 | 28-L-LL (15 Function) | 10                               | 10B |
|                                 | 28-D-LL (10 Function)                 |                       | 10BE                             | 20D |
|                                 |                                       |                       | 26D                              |     |
|                                 | <b>GTB/HTB Trims &amp; Pulls</b>      |                       | <b>GTB/HTB Finishes</b>          |     |
|                                 | 814-HTB (04 Function)                 |                       | EN                               | EB  |
|                                 | 802-GTB (10 Function) Exit Only       |                       | ED                               | EP  |
|                                 | 810-GTB (10 Function) Pull            |                       | EAB                              |     |
|                                 | <b>OB Knob Trim</b>                   |                       | <b>OB Knob Finish</b>            |     |
|                                 | 28-K-OB (04 Function)                 |                       | 03                               | 04  |
|                                 | 28-C-OB (13 Function)                 |                       | 10                               | 10B |
|                                 | 28-L-OB (15 Function)                 |                       | 10BE                             | 20D |
|                                 |                                       |                       | 26D                              |     |
|                                 | <b>Thumbpiece Trim</b>                |                       | <b>Thumbpiece Finishes</b>       |     |
|                                 | 814-TP (04 Function)                  |                       | EN                               | EB  |
|                                 | 810-TP (10 Function)                  |                       | ED                               | EP  |
|                                 | 866-TP (63 Function)                  |                       | EAB                              |     |
|                                 | 828-TP (28 Function)                  |                       |                                  |     |

### Suggested Architect's Specifications

- All exit devices shall be of touch bar design and be operative over 2/3 of the door's clear opening width
- All exit devices must be listed under "Panic Hardware" in the Accident Equipment List of Underwriter's Laboratories, Inc. Where labeled doors are used as exits, they must be equipped with labeled Fire Exit Hardware
- All springs shall be of stainless steel
- All exit devices shall be of chassis mounted unit construction with removable cover



SARGENT Manufacturing Company  
100 Sargent Drive, New Haven, CT 06511 USA  
800-727-5477 • [www.sargentlock.com](http://www.sargentlock.com)

Founded in the early 1800s, SARGENT<sup>®</sup> is a market leader in locksets, cylinders, door closers, exit devices, electro-mechanical products and access control systems for new construction, renovation, and replacement applications. The company's customer base includes commercial construction, institutional, and industrial markets.

Copyright © 1999, 2001, 2004, 2008-2013, Sargent Manufacturing Company, an ASSA ABLOY Group company. All rights reserved. Reproduction in whole or in part without the express written permission of Sargent Manufacturing Company is prohibited.

ASSA ABLOY is the global leader in door opening solutions, dedicated to satisfying end-user needs for security, safety and convenience.